

Spezifikation für Freigabe / specification for release

Kunde / customer :
 Artikelnummer / part number : **744862018**
 Bezeichnung : **STROMKOMPENSIERTE DROSSEL WE-TFC**
 description : **CURRENT-COMPENSATED CHOKE WE-TFC**



DATUM / DATE : 2010-12-12

A Mechanische Abmessungen / mechanical dimensions:

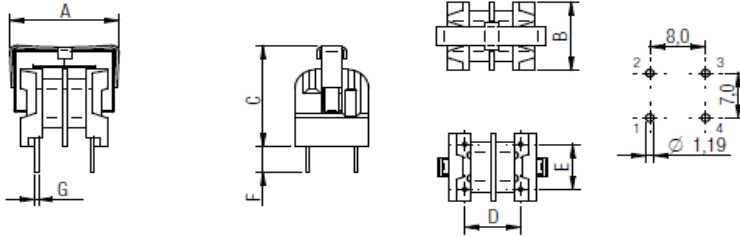

		Gehäuse / case: UT	
A	17,00 max		mm
B	11,00 max		mm
C	17,00 max		mm
D	8,00 ± 0,2		mm
E	7,00 ± 0,2		mm
F	4,00 max		mm
G	0,60 typ		mm

B Elektrische Eigenschaften / electrical properties:

Eigenschaften / properties	Testbedingungen / test conditions		Wert / value	Einheit / unit	tol.
Induktivität / inductance	10 kHz / 100 mV / 20°C	L_O	1,80	mH	+50 / -30%
DC-Widerstand / DC-resistance	@ 20 °C	R_{DC}	0,31	Ω	max.
Nennstrom / rated current	@ 70 °C	I_R	1,00	A	max.
Nennspannung / rated voltage	50 Hz	U_R	250	V_{AC}	max.

C Schaltbild / schematic:

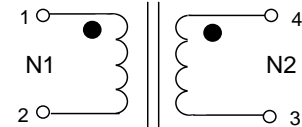

D Prüfgeräte / test equipment:

WAYNE KERR WK3260B/WK3265 für / for L_O und / and R_{DC}
HP 34401 A für / for I_R

E Testbedingungen / test conditions:

Luftfeuchtigkeit / humidity: 33%
 Umgebungstemperatur / ambient temperature: 20°C
 Prüfspannung / insulation test voltage: 2000V, 50Hz

F Werkstoffe & Zulassungen / material & approvals:

Gehäuse / case: UL94V-0
 Draht / wire: Polysol 155-N
 Kern / core: MnZn-Ferrite / MnZn ferrite

G Eigenschaften / general specifications:

Klimabeständigkeit/ climatic class: 40/125/21
 Betriebstemp. / operating temperature: -40°C - +125°C
 Übertemperatur / temperature rise: < 55K
 It is recommended that the temperature of the part does not exceed 125°C under worst case operating conditions.

Freigabe erteilt / general release	Kunde / customer			
.....			
Datum / date	Unterschrift / signature			
	Würth Elektronik			
.....			
Geprüft / checked	Kontrolliert / approved	MKe	Version 01	12.12.2010
		Name	Änderung / modification	Datum / date

Würth Elektronik eiSos GmbH & Co. KG

D-74638 Waldenburg · Max-Eyth-Strasse 1 - 3 · Germany · Telefon (+49) (0) 7942 - 945 - 0 · Telefax (+49) (0) 7942 - 945 - 400
<http://www.we-online.com>

Spezifikation für Freigabe / specification for release

Kunde / customer :
 Artikelnummer / part number : **744862018**
 Bezeichnung : **STROMKOMPENSIERTE DROSSEL WE-TFC**
 description : **CURRENT-COMPENSATED CHOKE WE-TFC**



DATUM / DATE : 2010-12-12

H Einfügedämpfung / insertion loss:

Typische Einfügedämpfung / typical insertion loss

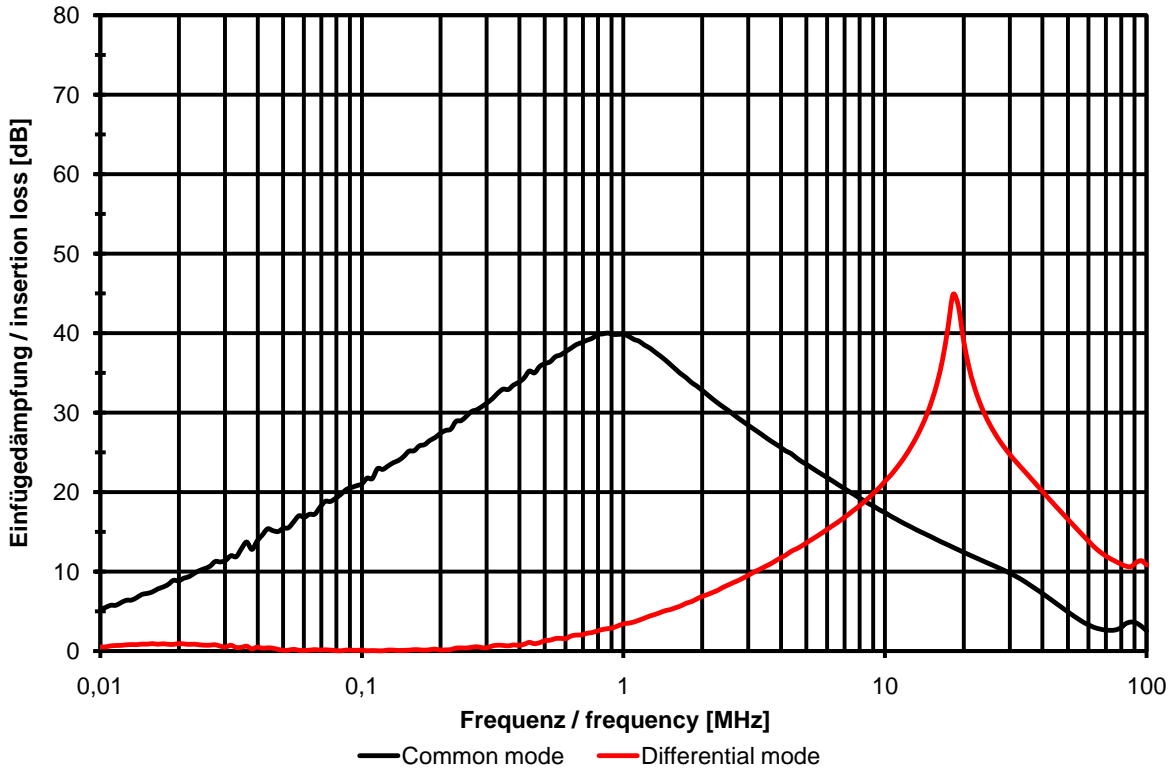

Common Mode

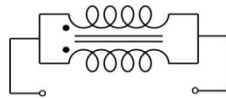

Differential Mode

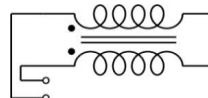

Datum / date				
Geprüft / checked	Kontrolliert / approved	MKe	Version 01	12.12.2010
Geprüft / checked	Kontrolliert / approved	Name	Änderung / modification	Datum / date

This electronic component has been designed and developed for usage in general electronic equipment. Before incorporating this component into any equipment where higher safety and reliability is especially required or if there is the possibility of direct damage or injury to human body, for example in the range of aerospace, aviation, nuclear control, submarine, transportation, (automotive control, train control, ship control), transportation signal, disaster prevention, medical, public information network etc, Würth Elektronik eiSos GmbH must be informed before the design-in stage. In addition, sufficient reliability evaluation checks for safety must be performed on every electronic component which is used in electrical circuits that require high safety and reliability functions or performance.

Würth Elektronik eiSos GmbH & Co. KG

D-74638 Waldenburg · Max-Eyth-Strasse 1 - 3 · Germany · Telefon (+49) (0) 7942 - 945 - 0 · Telefax (+49) (0) 7942 - 945 - 400
<http://www.we-online.com>