

XDSL SPLITTER FILTER MODULE



- Ⓢ POTS Central Office Splitter for standard ADSL applications
- Ⓢ Complies with BT-SIN-346 standard
- Ⓢ This module is part of a standard series which has footprint compatibility
- Ⓢ Patent pending
- Ⓢ ADSL2+ compatible

Electrical Specifications @ 25°C — Operating Temperature 0°C to -70°C

PARAMETER	FREQUENCY	
POTS Impedance	100Hz to 4kHz	320Ω + 1050Ω / 230nF
POTS Insertion Loss	1kHz	-1.0dB MAX
POTS Attenuation Distortion relative to 1 kHz	200Hz to 3.4kHz	±1.0dB
POTS Delay Distortion	600Hz to 4kHz	200μSec MAX
POTS Return Loss	200Hz to 2kHz	-18dB MIN
	2kHz to 3.4kHz	-14dB MIN
Longitudinal Balance	100Hz to 3.4kHz	-52dB MIN
ADSL Insertion Loss	32kHz to 200kHz	-29dB MIN
	200kHz to 2.2MHz	-55dB MIN
DC Current		100mA MAX
Total DC Resistance		50Ω MAX

Mechanical

B8546

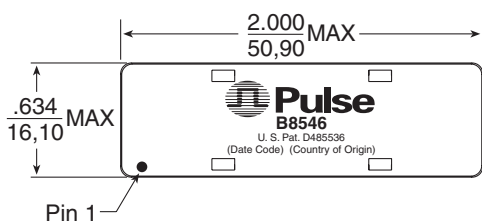

SUGGESTED BOARD LAYOUT

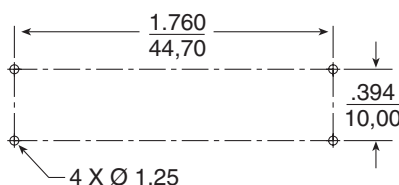

Weight 15 grams
 Tray35/tray
 Dimensions: $\frac{\text{Inches}}{\text{mm}}$
 Unless otherwise specified,
 all tolerances are $\pm \frac{.010}{0,25}$

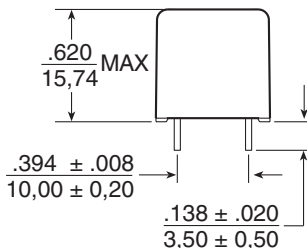
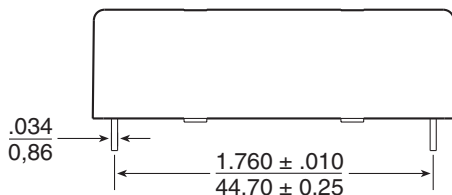

Schematic

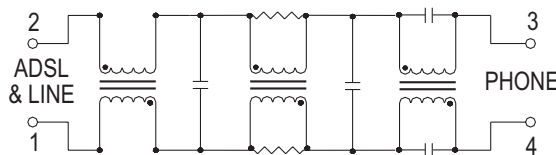

For More Information:

Pulse Worldwide Headquarters

12220 World Trade Drive
 San Diego, CA 92128
 U.S.A.
www.pulseeng.com
 TEL: 858 674 8100
 FAX: 858 674 8262

Pulse Northern Europe

3 Huxley Road
 Surrey Research Park
 Guildford, Surrey GU2 5RE
 United Kingdom
 TEL: 44 1483 401700
 FAX: 44 1483 401701

Pulse Southern Europe

Zone Industrielle
 F-39270
 Orgelet
 France
 TEL: 33 3 84 35 04 04
 FAX: 33 3 84 25 46 41

Pulse China Headquarters

No. 1
 Industrial District
 Changan, Dongguan
 China
 TEL: 86 769 5538070
 FAX: 86 769 5538870

Pulse North China

Room 1002
 No. 819
 Nanjing West Rd
 Shanghai
 China
 TEL: 86 21 32181071
 FAX: 86 21 32181396

Pulse South Asia

150 Kampong Ampat
 #07-01/02
 KA Centre
 Singapore 368324
 TEL: 65 6287 8998
 FAX: 65 6280 0080

Pulse North Asia

3F-4, No. 81, Sec. 1
 Hsin Tai Wu Road
 Hsi-Chih
 Taipei Hsien
 Taiwan
 TEL: 886 2 26980228
 FAX: 886 2 26980948

Performance warranty of products offered on this data sheet is limited to the parameters specified. Data is subject to change without notice. Other brand and product names mentioned herein may be trademarks or registered trademarks of their respective owners.

© Copyright, 2005. Pulse Engineering, Inc. All rights reserved.

www.pulseeng.com

B884.A (9/05)