

NUMBER C-1734146

3RD ANGLE PROJECTION

METRIC

THIS INFORMATION IS CONFIDENTIAL AND IS PRESENTED TO YOU ON THE CONDITION THAT NO FURTHER DISCLOSURE IS MADE BY YOU TO ANY OTHER THAN AMP PERSONNEL WITHOUT THE WRITTEN PERMISSION OF AMP. ALL DIMENSIONS IN MILLIMETERS. DO NOT SCALE PRINT.

PRINT DW

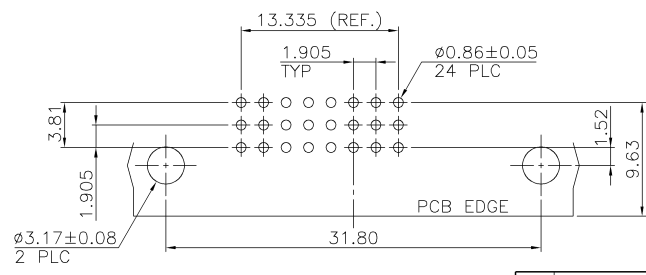
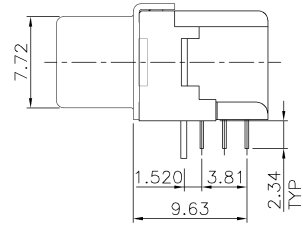
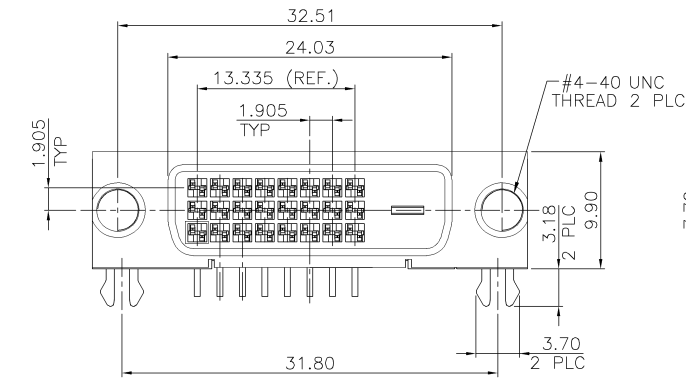
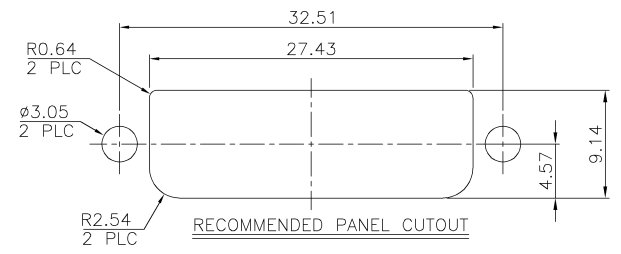
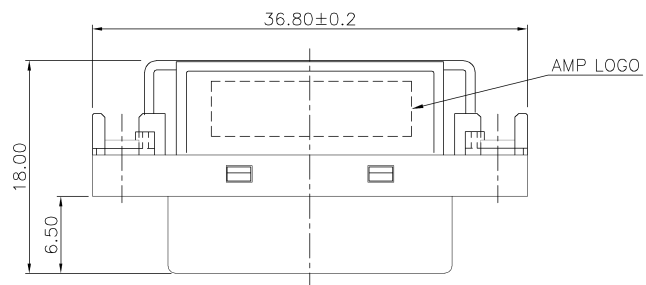

- NOTES:
- MATERIAL:
HOUSING: THERMOPLASTIC, UL 94V-0 RATED WHITE COLOR.
CONTACT: PHOSPHOR BRONZE, THICKNESS=0.3mm.
SHELL: STEEL, THICKNESS=0.5mm.
HOOK: BRASS, THICKNESS=0.5mm.
NUT: BRASS, THICKNESS=4.0mm.
 - FINISH:
CONTACT: GOLD PLATED (SEE TABLE) ON CONTACT AREA. 100µ" MIN. BRIGHT TIN PLATED ON SOLDERTAILS 50µ" MIN. NICKEL UNDERPLATED OVERALL
SHIELD: 50µ" MIN. NICKEL UNDERPLATED OVERALL
HOOK: 100µ" MIN. BRIGHT TIN PLATED OVER 30µ" MIN. NICKEL UNDERPLATED.
NUT: BRASS, NICKEL PLATED.
 - #4-40 UNC SCREW, SCREW HEAD LENGTH: 6.0±0.5mm.
 - WAVE SOLDER CAPABLE TO 245°C PER TYCO SPEC 109-202, CONDITION A.

W/	30u"	1-1734146-3
W/	10u"	1-1734146-2
W/	GOLD FLASH	1-1734146-1
W/O	30u"	1734146-3
W/O	10u"	1734146-2
W/O	GOLD FLASH	1734146-1
△ SCREW	GOLD PLATED	PART NUMBER

TOLERANCES UNLESS OTHERWISE SPECIFIED: 0 PLC ± 0.50 1 PLC ± 0.35 2 PLC ± 0.25 3 PLC ± 0.15 ANGLES ± 3°	DWN O. HU 08-JAN-2007 CHK S. HOU 08-JAN-2007	tyco Electronics TYCO HOLDINGS (BERMUDA) VII LTD. TAIWAN BRANCH
MATERIAL	APVD W.J. KE 08-JAN-2007	NAME
SEE NOTE	PRODUCT SPEC 108-1941	DVI-D ATX RCPT. CONN., R/A, WITH BOARDLOCK
SEE NOTE	APPLICATION SPEC	LOC DW SIZE DRAWING NO REV SCALE A 3 C-1734146 A1
	WEIGHT	SHEET 1 OF 2

A1	DRAWING CORRECTED	ECR-07-000406	CHK SH 12JAN 2007
A	FIRST RELEASED		CHK SH 30AUG 2006
LTR	REVISION RECORD	ECN	DWN CHK DATE

8 7 6 5 4 3 2 1 CUSTOMER DRAWING

NUMBER
C-1734146

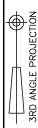

METRIC

THIS INFORMATION IS CONFIDENTIAL AND IS PROVIDED TO YOU ON THE CONDITION THAT NO FURTHER DISCLOSURE IS MADE BY YOU TO OTHER THAN AMP PERSONNEL WITHOUT THE WRITTEN PERMISSION OF AMP. DO NOT SCALE PRINT.

PRINT DW

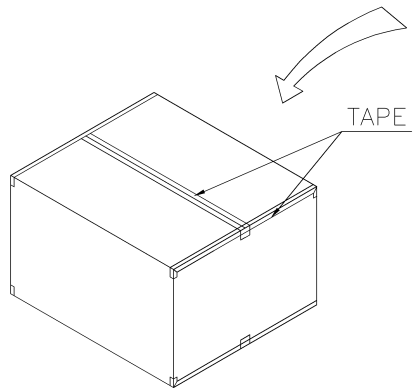
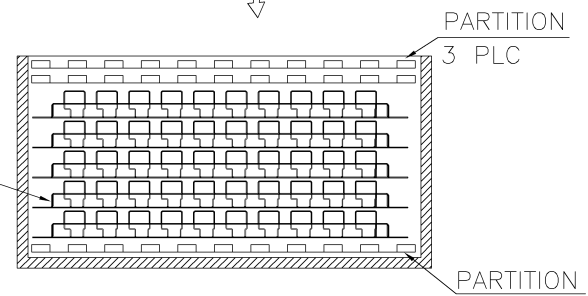
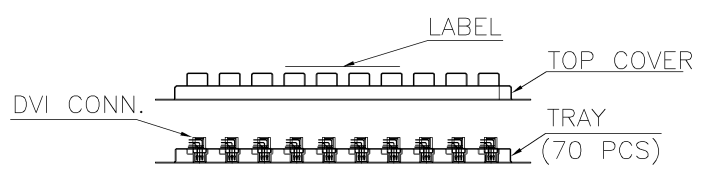

3.55	2.63	340X278X146	340X275X19.6	350
G.W./CARTON	N.W./CARTON	CARTON SIZE	TRAY SIZE	QUANTITY

TOLERANCES UNLESS OTHERWISE SPECIFIED: 0 PLC ± 1 PLC ± 2 PLC ± 3 PLC ± ANGLES ±	DWN	O. HU	tyco Electronics	TYCO HOLDINGS (BERMUDA) VII LTD. TAIWAN BRANCH
	CHK	S. HOU		
MATERIAL	APVD	W. J. KE	NAME	
SEE NOTE	PRODUCT SPEC	08-JAN-2007	DVI-D ATX RCPT. CONN., R/A, WITH BOARDLOCK	
FINISH	APPLICATION SPEC	-	LOC	SIZE
SEE NOTE	WEIGHT	-	DW	A ₃
			DRAWING NO	REV
			C-1734146	A1
			SCALE	SHEET
			--	2 OF 2

SEE SHEET 1.	ECN	DWN	CHK	DATE
LTR	REVISION RECORD			

CUSTOMER DRAWING