

10 9 8 7 6 5 4 3 2 1

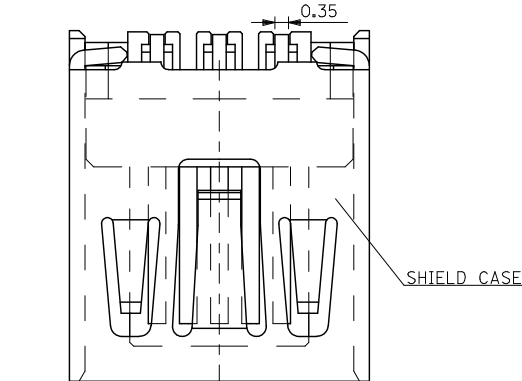

コネクタ実装側 (CONNECTOR MOUNT SIDE)

逆側 (REVERSE SIDE)

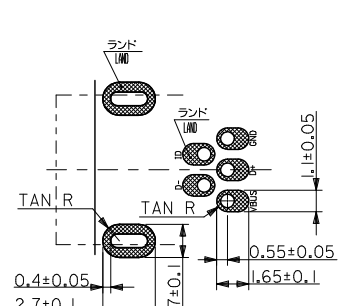
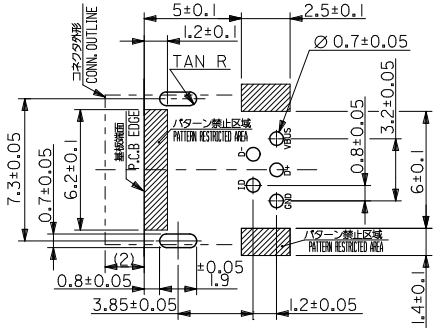

推奨基板寸法
RECOMMENDED P.C.B. PATTERN LAYOUT

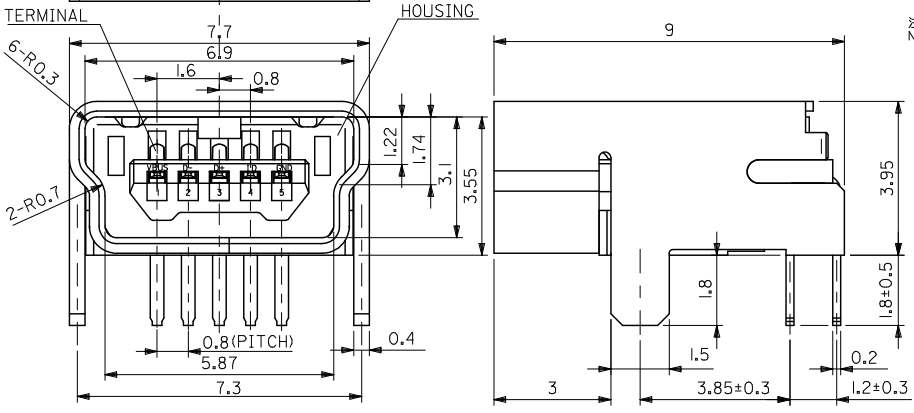

- 注記 1. 材質
NOTES MATERIAL
ハウジング: PA, ガラス充填, 黒色, UL94V-0
HOUSING: PA, GLASS FILLED, BLACK, UL94V-0
ターミナル: 銅合金 (t=0.2)
TERMINAL: COPPER ALLOY (t=0.2)
シールド ケース: 銅合金 (t=0.4)
SHIELD CASE: COPPER ALLOY (t=0.4)
2. メッキ仕様
PLATING
ターミナル
TERMINAL
接点部: 金メッキ 0.7μM MICRO METER MIN.
CONTACT AREA: GOLD 0.7μM MICRO METER MIN.
半田付け部: 銅メッキ 1.0μM MICRO METER MIN.
SOLDER TAIL AREA: TIN 1.0μM MICRO METER MIN.
下地部: ニッケルメッキ 1.0μM MICRO METER MIN.
UNDER PLATING: NICKEL 1.0μM MICRO METER MIN.
シールド ケース
SHIELD CASE
銅メッキ 1.0μM MICRO METER MIN.
TIN 1.0μM MICRO METER MIN.
下地部: ニッケルメッキ 1.0μM MICRO METER MIN.
UNDER PLATING: NICKEL 1.0μM MICRO METER MIN.
3. 本製品は 54819-0511 の総括品である。
THIS PRODUCT IS LEAD FREE OF 54819-0511.

54819-0519
MATERIAL No.

MODEL No.54819-***19

REVISED EC NO: J2009-4533 DRAWN BY: CHYKOHMATSUNO CHECKED BY: APPR: NIKITA DATE: 2009/06/25 DATE: 2009/06/25	GENERAL TOLERANCES (UNLESS SPECIFIED)		DIMENSION STYLE MM ONLY	SCALE 10:1	DESIGN UNITS METRIC	THIRD ANGLE PROJECTION
	10 UNDER	±0.2	DRAWN BY M. NAGATA	DATE 2004/04/28	TITLE USB SERIES MINI-B RECEPTACLE ASS'Y -LEAD FREE-	
	10 OVER 30 UNDER	±0.25	CHECKED BY K. TOJO	DATE 2004/04/28	MOLEX INCORPORATED	
	30 OVER	±0.3	APPROVED BY M. SASAO	DATE 2004/04/28	DOCUMENT NO. SD-54819-026	SHEET NO. 1 OF 2
ANGULAR	±3 °	DRAFT WHERE APPLICABLE MUST REMAIN WITHIN DIMENSIONS		THIS DRAWING CONTAINS INFORMATION THAT IS PROPRIETARY TO MOLEX INCORPORATED AND SHOULD NOT BE USED WITHOUT WRITTEN PERMISSION		

10 9 8 7 6 5 4 3 2 1

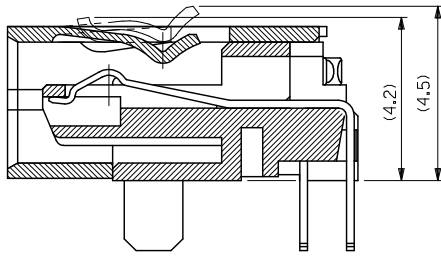

SECTION

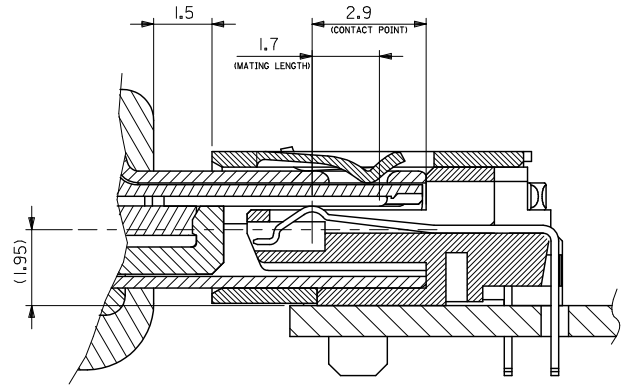

MATING

MODEL NO. 54819-***19

REVISED EC NO: J2009-1533 DRAWN BY CHYKOHMATSUOTO APPROVED BY APPRIKUKITA	GENERAL TOLERANCES (UNLESS SPECIFIED)		DIMENSION STYLE MM ONLY	SCALE 10:1	DESIGN UNITS METRIC	THIRD ANGLE PROJECTION
	10 UNDER	±0.2	DRAWN BY M. NAGATA	DATE 2004/04/28	TITLE USB SERIES MINI-B RECEPTACLE ASS'Y -LEAD FREE-	
	10 OVER 30 UNDER	±0.25	CHECKED BY K. TOJO	DATE 2004/04/28	MOLEX INCORPORATED	
	30 OVER	±0.3	APPROVED BY M. SASAO	DATE 2004/04/28	DOCUMENT NO. SD-54819-026	SHEET NO. 2 OF 2
A	DESCRIPTION	ANGULAR ±3 °	MATERIAL NO. SEE SHEET 1	THIS DRAWING CONTAINS INFORMATION THAT IS PROPRIETARY TO MOLEX INCORPORATED AND SHOULD NOT BE USED WITHOUT WRITTEN PERMISSION		
		DRAFT WHERE APPLICABLE MUST REMAIN WITHIN DIMENSIONS	SIZE A3			

tb_frame_A3_J_ME_S
Rev. E 2006/04/15

9 8 7 6 5 4 3 2 1 EN-02JA(021)