

10 9 8 7 6 5 4 3 2 1

NOTE :

- MATERIAL :
HOUSING : LCP, BLACK, UL94V-0
TERMINAL : COPPER ALLOY THICKNESS = 0.15 MM
SHIELD CASE : STAINLESS STEEL THICKNESS = 0.30 MM
- PLATING :
TERMINAL :
CONTACT AREA : GOLD FLASH OVER MINIMUM 0.75 MICRON Pd/Ni.
SOLDER TAIL AREA : GOLD FLASH.
UNDER PLATING : NICKEL 2.0 MICRON MINIMUM.
- SHIELD :
OPTION 1 : MATTE TIN 3.8 MICRON MINIMUM.
UNDER PLATING : NICKEL 1.27 MICRON MINIMUM.
OPTION 2 : NICKEL 1.25 MICRON MINIMUM
- TAIL & NAIL COPLANARITY 0.08 mm MAXIMUM.
- PACKAGING SPECIFICATION : PK-47491-001
- PRODUCT SPECIFICATION : RPS-47491-***
- COMPLIANT TO RoHS DIRECTIVE 2002/95/EC AND ELV DIRECTIVE 2000/53/EC.

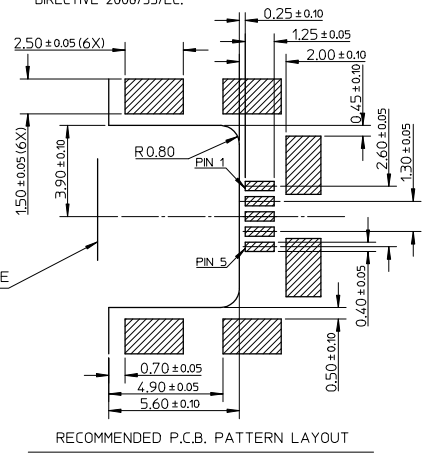
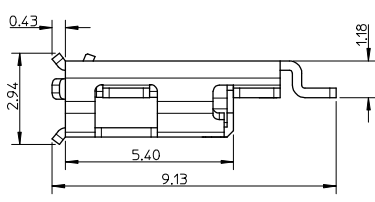
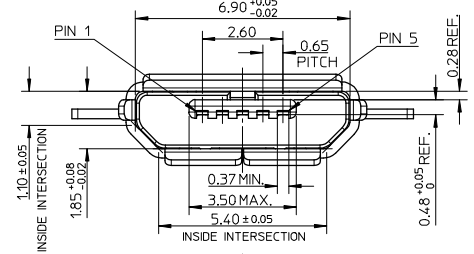
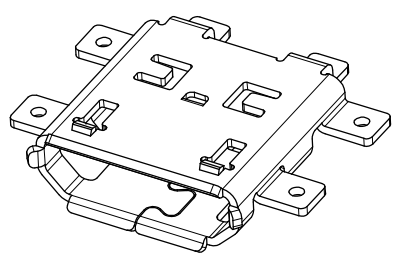
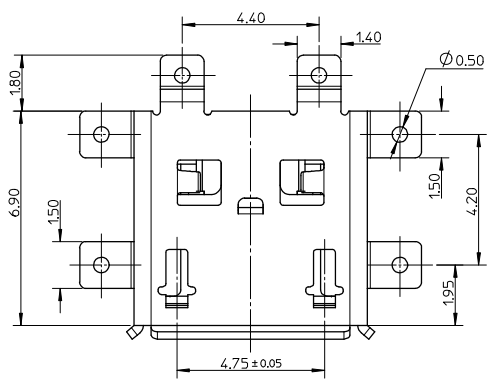

SHELL PLATING OPTION 1	47491-0001
SHELL PLATING OPTION 2	47491-0002

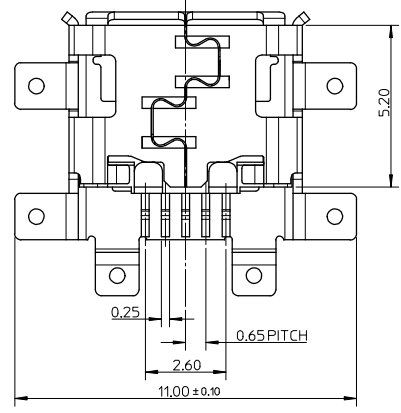

REVISE EC NO: SH2008-0650 DRAWN: WJWANG 2008/06/30 CHKD: XJSONG 2008/06/30 APPR: HWANG 2008/07/24	DESCRIPTION	QUALITY SYMBOLS	GENERAL TOLERANCES (UNLESS SPECIFIED)	DIMENSION STYLE	SCALE	DESIGN UNITS	THIRD ANGLE PROJECTION	
		▽=0	mm INCH	MM ONLY	8:1	METRIC		
		▽=0	4 PLACES ± --- ± ---	DRAWN BY DATE	TITLE	MOLEX INCORPORATED		
			3 PLACES ± --- ± ---	XJSONG 2006/04/28	MICRO USB B REC. MIDDLE MOUNT ASS'Y			
	2 PLACES ± 0.25 ± ---	CHECKED BY DATE	SD-47491-001					
	1 PLACE ± 0.25 ± ---	IWANG 2006/04/28						
	ANGULAR ± 3°	APPROVED BY DATE	THIS DRAWING CONTAINS INFORMATION THAT IS PROPRIETARY TO MOLEX INCORPORATED AND SHOULD NOT BE USED WITHOUT WRITTEN PERMISSION					
	DRAFT WHERE APPLICABLE MUST REMAIN WITHIN DIMENSIONS	JNCHEN 2006/04/28						
		MATERIAL NO.	SEE CHART					
		DOCUMENT NO.	SD-47491-001					
		SHEET NO.	1 OF 1					

ib_frame_A3_P_AM.T
Rev. D 2004/06/28