

4

3

2

1

THIS DRAWING IS UNPUBLISHED. RELEASED FOR PUBLICATION .19
 BY AMP INCORPORATED. ALL RIGHTS RESERVED.

REV	DATE	DESCRIPTION	DATE	BY	APP'D
ES	00	ECR-10-014321	07JUL10	TY	SY

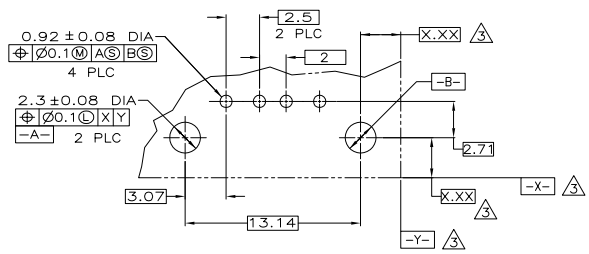
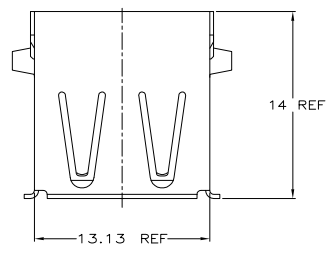

PC BOARD MOUNTING DIMENSIONS Δ 4

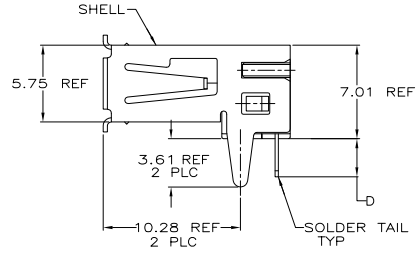
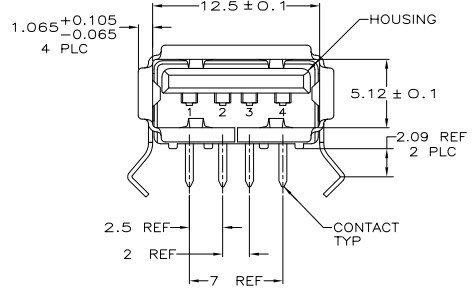

- Δ MATERIAL:
SHELL & CONTACTS- COPPER ALLOY.
HOUSING: UL 94V-0 RATED, THERMOPLASTIC, COLOR SEE TABLE.
- Δ PLATING:
CONTACTS: 0.076 μ m MINIMUM GOLD OVER 0.76 PALLADIUM-NICKEL ON MATING AREA.
3.8 μ m MINIMUM MATTE TIN ON SOLDER TAILS.
BOTH OVER 1.27 μ m MINIMUM NICKEL μ m MIN GOLD ON MATING CONTACT ALTERNATE PLATING: 0.76 μ m MINIMUM AREA, 3.80 μ m MIN MATTE TIN ON SOLDER TAILS, BOTH OVER 1.27 μ m MIN NICKEL.
SHELL: 2-5 μ m MINIMUM BRIGHT TIN
- Δ DATUM AND BASIC DIMENSIONS ESTABLISHED BY CUSTOMER.
- Δ RECOMMENDED PC BOARD THICKNESS OF 1.57.

NO	3.81	BLACK	1-292303-5
NO	3.56	BLACK	1-292303-4
NO	3.20	BLACK	1-292303-3
YES	3.30	BLACK	1-292303-2
YES	2.29	BLACK	292303-6
YES	2.84	NATURAL	292303-5
YES	2.84	BLACK	292303-4
NO	2.84	NATURAL	292303-3
NO	2.29	BLACK	292303-2
NO	2.84	BLACK	292303-1
HIGH TEMPERATURE COMPATIBLE	D	HOUSING COLOR	PART NUMBER

DIMENSIONS: mm TOLERANCES UNLESS OTHERWISE SPECIFIED: D: .015 F: .010 H: .015 J: .010 K: .015 L: .010 M: .015 N: .010 P: .015 Q: .010 R: .015 S: .010 T: .015 U: .010 V: .015 W: .010 X: .015 Y: .010 Z: .015 ANGLES: .015 FINISH: .015		DAN JIANG 19F804 SHI YAO 19F804 T. SASAKI 19F804 PROJECT SPEC: 108-60034 APPLICATION SPEC:	Tyco Electronics Corporation Shanghai, P.R.China, 200233 RECEPTACLE ASSEMBLY RIGHT ANGLE, 4 POSITION, 1/H & SMT USB, LEAD FREE VERSION SIZE: A2 CASE CODE: 00779 DRAWING NO: 292303 SCALE: 5:1 SHEET: 1 OF 4 REV: E5
MATERIAL: Δ FINISH: Δ		CUSTOMER DRAWING	

AMP 1471-9 REV 10/83 Downloaded 04/21/16 10:54:47 AM (GMT+08:00) by ComputerVision, Inc. Medusa Revision 12.2.17

REV	DATE	DESCRIPTION	BY	CHK	APPD
ES 00		SEE SHEET 1			

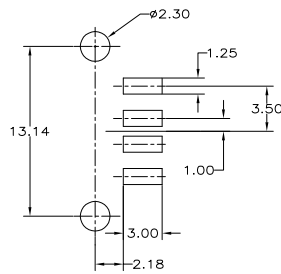
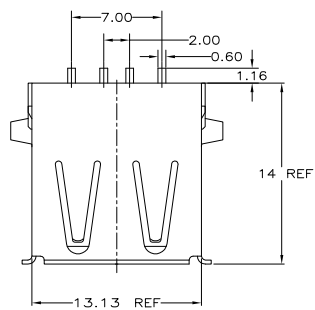

- △ MATERIAL:
SHELL & CONTACTS- COPPER ALLOY.
HOUSING: UL 94V-0 RATED, THERMOPLASTIC, COLOR SEE TABLE.
- △ PLATING:
CONTACTS: 0.076 μm MINIMUM GOLD OVER 0.76 μm MINIMUM PALLADIUM-NICKEL ON MATING AREA.
3.8 μm MINIMUM MATTE TIN ON SOLDER TAILS.
BOTH OVER 1.27 μm MINIMUM NICKEL.
CONTACT ALTERNATE PLATING: 0.76 μm MIN GOLD ON MATING AREA, 3.80 μm MIN MATTE TIN ON SOLDER TAILS, BOTH OVER 1.27 μm MIN NICKEL.
SHELL: 2~5 μm MINIMUM BRIGHT TIN
- △ RECOMMENDED PC BOARD THICKNESS OF 1.42.

RECOMMENDED PC BOARD MOUNTING LAYOUT △
 (TOLERANCE=±0.05)

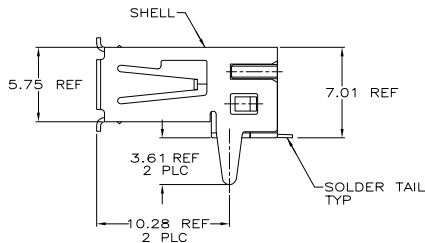
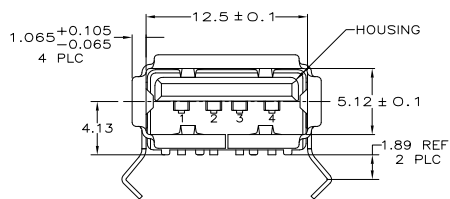

YES	BLACK	1-292303-1
YES	NATURAL	292303-7
HIGH TEMPERATURE COMPATIBLE	HOUSING COLOR	PART NUMBER

DIMENSIONS: mm TOLERANCES UNLESS OTHERWISE SPECIFIED: 0 PLC ± 1 PLC ±0.25 2 PLC ± 3 PLC ± ANGLES °		DATE: 19FEB04 DRAWN: J. JIANG CHECKED: S. YAO APPROVED: T. SASAKI PRODUCT SPEC: 108-60034 OPERATOR SPEC:	Tyco Electronics Corporation Shanghai, P.R.China, 200233 RECEPTACLE ASSEMBLY RIGHT ANGLE, 4 POSITION, I/H & SMT USB, LEAD FREE VERSION SIZE: A2 CASE CODE: 00779 DRAWING NO: 292303 SCALE: 5:1 SHEET: 2 OF 4 REV: E5
MATERIAL: △ FINISH: △		WEIGHT: - CUSTOMER DRAWING	Tyco Electronics Corporation Shanghai, P.R.China, 200233 RECEPTACLE ASSEMBLY RIGHT ANGLE, 4 POSITION, I/H & SMT USB, LEAD FREE VERSION SIZE: A2 CASE CODE: 00779 DRAWING NO: 292303 SCALE: 5:1 SHEET: 2 OF 4 REV: E5

THIS DRAWING IS UNPUBLISHED.
 RELEASED FOR PUBLICATION
 BY AMP INCORPORATED. ALL RIGHTS RESERVED.

REV	DATE	DESCRIPTION	DATE	BY	APP'D
ES 00		SEE SHEET 1			

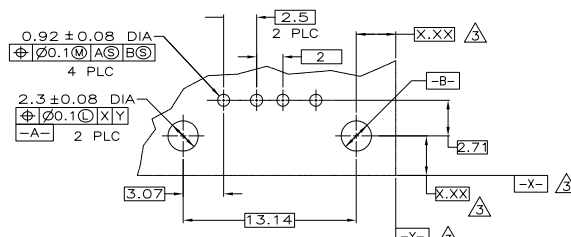
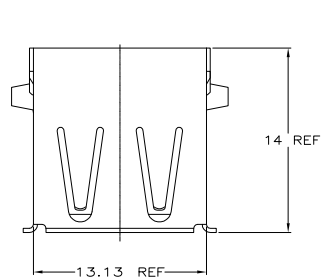

PC BOARD MOUNTING DIMENSIONS Δ

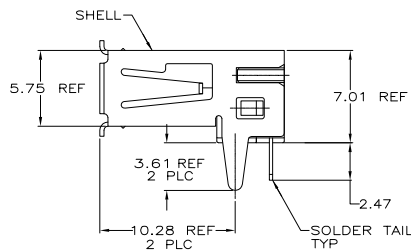
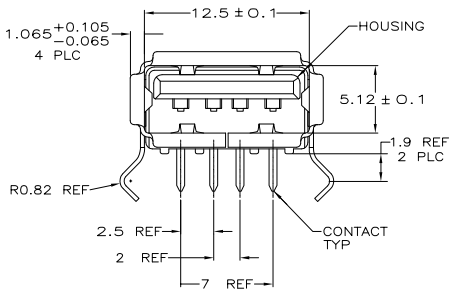

- Δ MATERIAL:
SHELL & CONTACTS—COPPER ALLOY.
HOUSING: UL 94V-0 RATED, THERMOPLASTIC, COLOR SEE TABLE.
- Δ PLATING:
CONTACTS: 0.076 μ m MINIMUM GOLD OVER 0.76 μ m MINIMUM PALLADIUM-NICKEL ON MATING AREA.
3.8 μ m MINIMUM MATTE TIN ON SOLDER TAILS.
BOTH OVER 1.27 μ m MINIMUM NICKEL.
CONTACT ALTERNATE PLATING: 0.76 μ m MIN GOLD ON MATING AREA, 3.80 μ m MIN MATTE TIN ON SOLDER TAILS, BOTH OVER 1.27 μ m MIN NICKEL.
SHELL: 2-5 μ m MINIMUM BRIGHT TIN
- Δ DATUM AND BASIC DIMENSIONS ESTABLISHED BY CUSTOMER.
- Δ RECOMMENDED PC BOARD THICKNESS OF 1.2.

NO	NATURAL	292303-8
HIGH TEMPERATURE COMPATIBLE	HOUSING COLOR	PART NUMBER

<small>FOR DIMENSIONS TO CONTACTS, CONTACT THE AMP CORPORATION IF A DIMENSION IS UNLESS OTHERWISE SPECIFIED, IT IS IN MILLIMETERS. DIMENSIONS ARE TO CENTER UNLESS OTHERWISE SPECIFIED.</small>		DATE: MARTIN LI 2300107 SIZE: MARTIN LI 2300107 DRAWN BY: STEVEN YAO 2300107 CHECKED BY:	Tyco Electronics Corporation Shanghai, P.R.China, 200233
DIMENSIONS: mm Ø P.L.C. ±.05 H.P.L.C. ±.05 S.P.L.C. ±.05 M.P.L.C. ±.05 FINISH:	TOLERANCES UNLESS OTHERWISE SPECIFIED: ±.05 ±.05 ±.05 ±.05	PRODUCT SPEC: 108-60034 WEIGHT:	RECEPTACLE ASSEMBLY RIGHT ANGLE, 4 POSITION, T/H & SMT USB, LEAD FREE VERSION SIZE: A2 CASE CODE: 00779 DRAWING NO: 292303 CUSTOMER DRAWING
MATERIAL: Δ FINISH: Δ		SCALE: 5:1 SHEET: 3 OF 4 REV: E5	

