

4

3

2

1

THIS DRAWING IS UNPUBLISHED. RELEASED FOR PUBLICATION
 © COPYRIGHT - By - ALL RIGHTS RESERVED.

LOC	DIST	REVISIONS		
P	LTR	DESCRIPTION	DATE	BY
CM	00			
	J1	REVISED PER ECO-11-004917	11MAR11	RK HMR

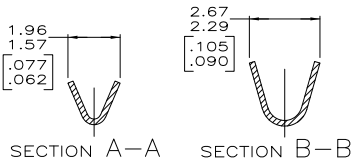
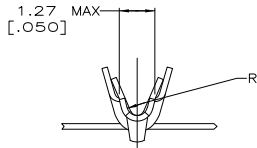
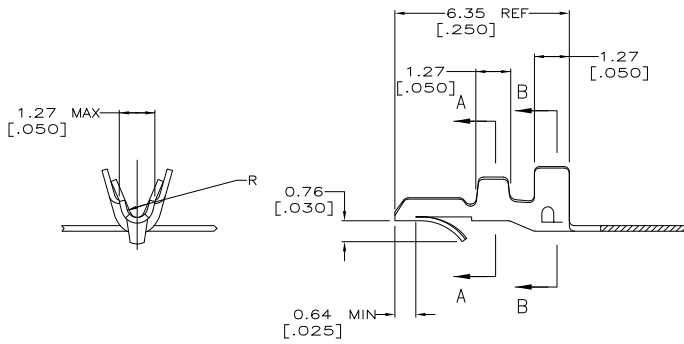
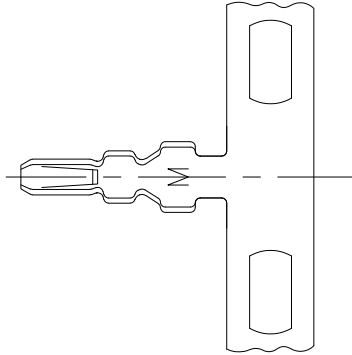
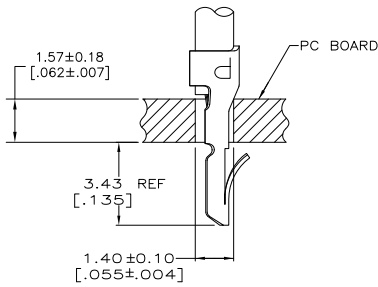

METRIC

- PARTS COMPLY WITH AMP SOLDERABILITY SPEC 109-11-3.
- PARTS CAPABLE OF BEING APPLIED BY AMPOMATER.
- 0.00508 [0.00200] MIN BRIGHT TIN-LEAD.
- WIRE RANGE: 0.12 - 0.4 mm² (26 - 22 AWG).
- INSULATION RANGE: 1.02 - 1.78 [.040 - .070] DIA.
- DIMENSIONS IN BRACKETS ARE IN INCHES.
- 0.00508 [0.00200] MIN BRIGHT TIN.

△	0.20[.008] PH BRZ	3-640663-1
△	0.20[.008] PH BRZ	640663-1
FINISH	MATERIAL	PART NO

DIMENSIONS:		OTHER DIMENSIONS:		APPLICATION SPEC		SIZE		CAGE CODE		DRAWING NO		RESTRICTED TO	
INCHES		OTHER DIMENSIONS:		114-1016		A2		00779		C=640663		-	
SEE TABLE		SEE TABLE		CUSTOMER DRAWING		SCALE		10:1		SHEET		1 of 1	
												REV J1	