

4

3

2

1

THIS DRAWING IS UNPUBLISHED. RELEASED FOR PUBLICATION  
 © COPYRIGHT BY TYCO ELECTRONICS CORPORATION. ALL RIGHTS RESERVED.

LOC	DIST	REVISIONS					
CM	00	P	LTR	DESCRIPTION	DATE	BY	APPD
		R2		REV PER ECO 10-024400	01MAR11	JR	SM

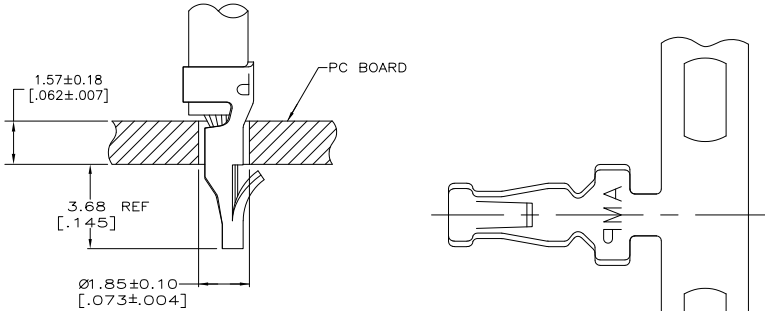

- △ PARTS COMPLY WITH AMP SOLDERABILITY SPEC 109-11-3.
- △ 0.00508 [.000200] MIN BRIGHT TIN-LEAD.
- △ PARTS COMPLY WITH AMP SOLDERABILITY SPEC 109-11-1.
- △ 0.00305 [.000120] MIN BRIGHT TIN-LEAD OVER 0.00102 [.000040] MIN NICKEL.
- △ FOR FOREIGN PRODUCTION ONLY.
- △ CARRIER STRIP TO HAVE 1.52 [.060] DIA PILOT HOLE.
- △ 0.00305 [.000120] MIN TIN OVER 0.00102 [.000040] MIN NICKEL.
- B. WIRE RANGE: 0.3 - 0.9 mm<sup>2</sup> (22 - 18 AWG).
- 9. INSULATION RANGE: 1.52 - 2.79 [.060 - .110] DIA.
- 10. DIMENSIONS IN BRACKETS ARE IN INCHES.
- △ 0.00508 [.000200] MIN BRIGHT TIN.

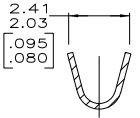
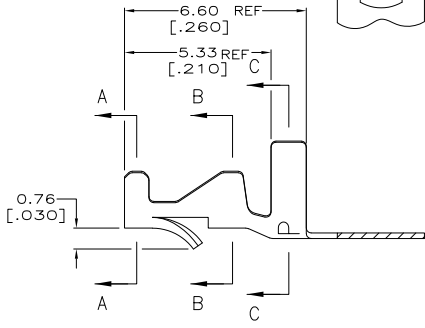
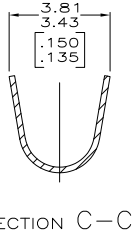

SECTION A-A, B-B

**METRIC**

	△	△	0.20[.008] PH BRZ	3-640311-1
	△	△	0.20[.008] BRASS	640311-5
	△	△	0.20[.008] BRASS	640311-3
OBSOLETE	△	△	0.20[.008] PH BRZ	640311-1
NOTES	FINISH	MATERIAL	PART NO.	

DIMENSIONS:		TOLERANCES UNLESS OTHERWISE SPECIFIED:		APPLICABLE SPECIFICATIONS:		MATERIAL:		FINISH:	
INCHES		0 PLC	±	114-1016		A2	00779	C-640311	
		1 PLC	±						
		2 PLC	±						
		3 PLC	±						
		4 PLC	±						
		ANGLES	±						
		FINISH							

640311

A