

4

3

2

1

THIS DRAWING IS UNPUBLISHED. RELEASED FOR PUBLICATION
 COPYRIGHT BY TYCO ELECTRONICS CORPORATION. ALL RIGHTS RESERVED.

LOC	DIST	REVISIONS			
P	LR	DESCRIPTION	DATE	BY	APP'D
AF	50	0	TRANSFERRED TO TYCO FORMAT	04NOV02	MF EH

- 1 CRIMPBAND MATERIAL PROVIDED IN CONTINUOUS STRIP.
- 2 REFERENCE DESCRIPTIVE PART NUMBER G125/16510R25TB.
- 3 BLANK LENGTH DETERMINED BY 125/165 TOOLSET.
- 4 108 METERS PER REEL.

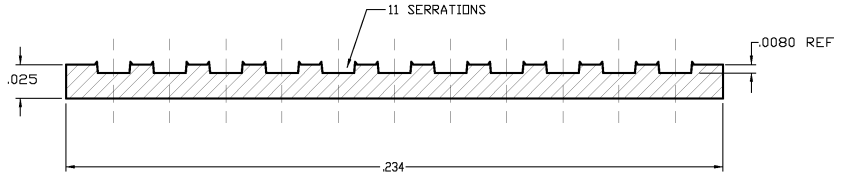
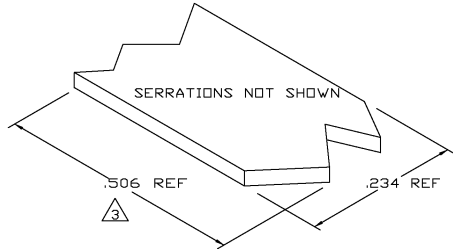

TYP. CROSS SECTION

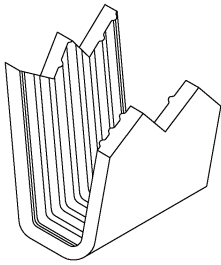

PARTIAL FORMED VIEW (REF)
FORMED BY APPLICATION TOOLING

1601705-1
PART NUMBER

THIS DRAWING IS A CONTROLLED DOCUMENT.		DRW: MICHAEL S. FEHLER CHK: EDWARD HOWARD APP'D: EDWARD HOWARD	DATE: 04NOV2002 04NOV2002 04NOV2002	Tyco Electronics Corporation Harrisburg, PA 17105-3608	
DIMENSIONS: INCHES		PRODUCT SPEC	APPLICATION SPEC	SITE: A2	ONE CODE: 00779
0 PLG ± 1 PLG ± 2 PLG ± .005 3 PLG ± 4 PLG ± ANGLES ± FINISH: TIN		WEIGHT	HEIGHT	DRAWING NO: 1601705	
MATERIAL: UNS C26000 BRASS		CUSTOMER DRAWING		SCALE: 1:1	SHEET 1 OF 1

AMP 1471-9 REV 31MAR2000

H:\dm\lecard\

1601705

B

A