

4

3

2

1

THIS DRAWING IS UNPUBLISHED.

RELEASED FOR PUBLICATION

COPYRIGHT BY TYCO ELECTRONICS CORPORATION. ALL RIGHTS RESERVED.

LOC

DIST

REVISIONS

P

LTR

DESCRIPTION

DATE

DWN

APVD

E1

REV PER ECR 08-010969

01MAY08

JR

RL

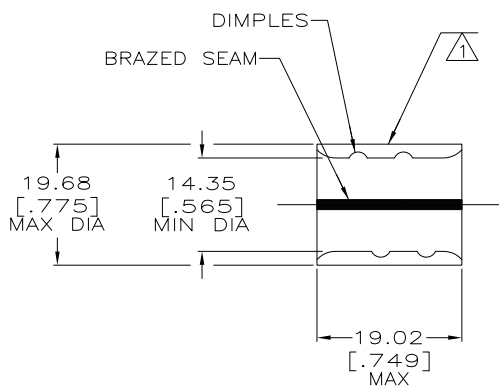
AMP
WIRE RANGEListed
FILE E13288LR7189
Certified3/0 AWG
SOLID OR STRANDED3/0 AWG
STRANDED3/0 AWG
SOLID OR STRANDED

- 1 STAMP AMP 3/0W* 150
LOCATE APPROX AS SHOWN
- 2 MATERIAL THK: 2.31 ± 0.08 [.091 ± 0.03]
- 3 TIN PL 0.00254 [.000100] MIN THK
PER ASTM B545.
- 4 CLEANED, UNPLATED
- 5 P/N 1-36909-1 IS NOT UL OR CSA LISTED.
- 6 STAMP FOR MANUFACTURING LOCATION
OR CODE PERMISSIBLE.
- 7 PREPRODUCTION - FASR REQ.
- 8 NOT UL OR CSA LISTED
- 9 0.00254 [.000100] MIN TIN-LEAD (60/40)
PLATE PER SAE-AMS-P-81728
- 10 PRELIMINARY - NOT FOR PRODUCTION

9	-	LOOSE PIECE	8 10 36909-2
4	-	LOOSE PIECE	5 7 36909-1
3	-	LOOSE PIECE	36909
FINISH	QTY	PACKAGE TYPE	PART NO
DWN JR RUTH 14FEB01	CHK MS FEHER 14FEB01	Tyco Electronics Tyco Electronics Corporation Harrisburg, Pa 17105-3608	
APVD M SPICER 14FEB01	NAME	SPLICE, PARALLEL, SOLISTRAND	
PRODUCT SPEC	SIZE	CAGE CODE	DRAWING NO
APPLICATION SPEC	WEIGHT	00779	36909
CUSTOMER DRAWING	SCALE	2:1	SHEET 1 OF 1 REV E1

AMP INCORPORATED
CUSTOMER SERVICE SYSTEMSFOR ADDITIONAL
PRODUCT INFORMATION OR
COPIES OF DRAWINGS
AND TECHNICAL DOCUMENTSPRODUCT INFORMATION CENTER
1-800-522-6752

FOR APPLICATION

TOOLING ASSISTANCE CENTER

TOOLING INFORMATION

1-800-722-1111

FOR ORDER ENTRY

1-800-526-5142

THIS DRAWING IS A CONTROLLED DOCUMENT FOR
AMP INCORPORATED. IT IS SUBJECT TO CHANGE
AND THE CONTROLLING ENGINEERING ORGANIZATION
SHOULD BE CONTACTED FOR THE LATEST REVISION.MAX RECOMMENDED OPERATING
TEMPERATURE:

170° C

VOLTAGE RATING:

N/A

CIRCULAR MIL AREA:

150,500-190,000
SOLID OR STRANDED

THIS DRAWING IS A CONTROLLED DOCUMENT.

DIMENSIONS:

INCHES

TOLERANCES UNLESS
OTHERWISE SPECIFIED:0 PLC ± -
1 PLC ± -
2 PLC ± 0.20[.008]
3 PLC ± -
4 PLC ± -
ANGLES ± -MATERIAL
COPPER ASTM B-152
ANNEALEDFINISH
SEE TABLE

AMP 1470-19 REV 31MAR2000