

4

3

2

1

THIS DRAWING IS UNPUBLISHED. RELEASED FOR PUBLICATION.
 © COPYRIGHT BY TYCO ELECTRONICS CORPORATION. ALL RIGHTS RESERVED.

| LOC | DIST | REVISIONS | | | |
|-----|------|----------------------|---------|----|-------|
| P | LTR | DESCRIPTION | DATE | BY | APP'D |
| G | 14 | REV PER 063A-0018-03 | 15OCT03 | JR | MS |

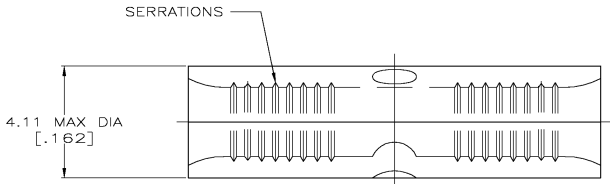

| | | |
|--------------------------|-----------------------|---------------------|
| AMP WIRE RANGE | Listed FILE E13288 | LR7189 Certified |
| 16-14 AWG STRANDED | 16-14 AWG STRANDED | NOT CERTIFIED |

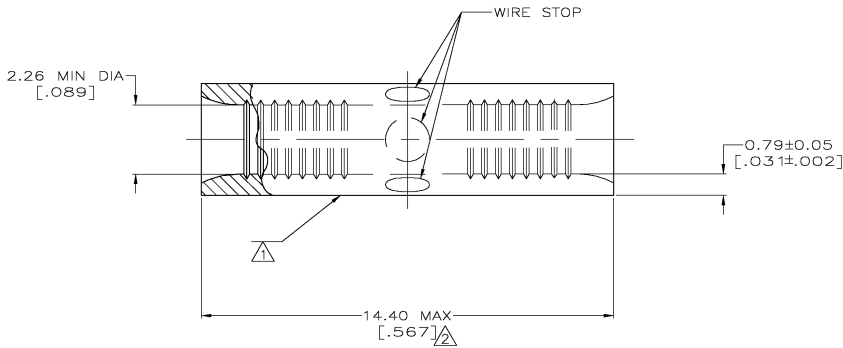

- 1 STAMP AMP 16-14* APPROX AS SHOWN
- 2 MAXIMUM LENGTH DOES NOT INCLUDE MANUFACTURING TABS
- 3 MATERIAL: COPPER PER ASTM B-152 ANNEALED
- 4 FINISH: TIN PLATE 0.00254 [0.000100] MIN THK PER ASTM B-545

| | | |
|--|--|---|
| AMP INCORPORATED CUSTOMER SERVICE SYSTEMS | | MAX RECOMMENDED OPERATING TEMPERATURE: 170° C |
| FOR ADDITIONAL PRODUCT INFORMATION OR COPIES OF DRAWINGS AND TECHNICAL DOCUMENTS | PRODUCT INFORMATION CENTER 1-800-522-6752 | VOLTAGE RATING: N/A |
| FOR APPLICATION | TOOLING ASSISTANCE CENTER 1-800-722-1111 | CIRCULAR MIL AREA: 1.04-2.62mm² [2,050-5,180] STRANDED |
| FOR ORDER ENTRY | 1-800-526-5142 | THIS DRAWING IS A CONTROLLED DOCUMENT FOR AMP INCORPORATED. IT IS SUBJECT TO CHANGE AND THE CONTROLLING ENGINEERING ORGANIZATION SHOULD BE CONTACTED FOR THE LATEST REVISION. |

| | | |
|-----|------------------|-----------|
| 50 | LOOSE PIECE, BOX | 8-34227-2 |
| - | LOOSE PIECE | 34227 |
| QTY | PACKAGE TYPE | PART NO |

| | | | |
|--|--|--------------------------|--|
| THIS DRAWING IS A CONTROLLED DOCUMENT. | | DRG. TA BRINKMAN 3-1-93 | Tyco Electronics Corporation Harrisburg, PA 17105 |
| DIMENSIONS: MM (INCHES) | | CHK. DA PATTERSON 3-1-93 | |
| MATERIAL - 3 | | FINISH - 4 | SPlice, BUTT, STANDARD, BUDGET |
| APPLIC. SPEC | | WEIGHT | RESTRICTED TO |
| CUSTOMER DRAWING | | SCALE 10:1 | SHEET 1 OF 1 REV G |

AMP 1421-9 REV 31MAR2000

H:\dmlcmod\

34227

A