

4

3

2

1

THIS DRAWING IS UNPUBLISHED. RELEASED FOR PUBLICATION  
 © COPYRIGHT - By - ALL RIGHTS RESERVED.

LOC	DIST	REVISIONS				
P	LTR	DESCRIPTION	DATE	DWN	APVD	
AF	50	G1	REVISED PER ECR-11-007368	30MAR09	HMR	GP

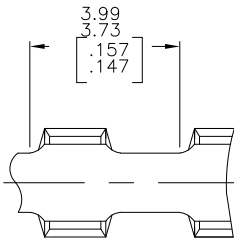

- 1 PRODUCT PROVIDED IN CONTINUOUS (BREAK FREE) STRIP FORM ON REELS.
- 2 WIRE RANGE: 1.11-1.47mm<sup>2</sup>[2200 TO 2900 CMA]
- 3 CRIMP WIDTH: 2.29[.090] F TYPE.  
CRIMP HEIGHT IN INCHES (+/- .002) = (TOTAL CMA OF WIRE + 6550)/175000.

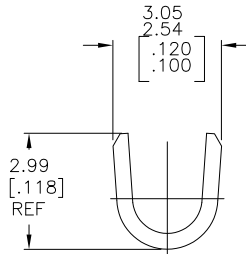
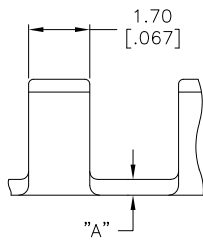

OBSOLETE	NONE	.016±.001	ANL. ST. STEEL	60933-3
	TIN	.012±.001	TEMP 2 STEEL	60933-2
OBSOLETE	TIN	.016±.001	Ø82 BRASS	60933-1
	FINISH	"A" MATERIAL THICKNESS	MATERIAL	PART NO

THIS DRAWING IS A CONTROLLED DOCUMENT.		DWN	TE Connectivity			
		RAGHAVENDRA				
		CHK				G.D.PORTA
		APVD				G.D.PORTA
						NAME
DIMENSIONS:	TOLERANCES UNLESS OTHERWISE SPECIFIED:	PRODUCT SPEC				
mm [INCHES]		APPLICATION SPEC				
0 PLC ± -	0 PLC ± -	SIZE				
1 PLC ± -	1 PLC ± -	CAGE CODE				
2 PLC ± 0.25[.010]	2 PLC ± -	DRAWING NO				
3 PLC ± -	3 PLC ± -	RESTRICTED TO				
4 PLC ± -	4 PLC ± -	114-2088				
ANGLES ± -	ANGLES ± -	WEIGHT				
MATERIAL	FINISH	A3 00779 C-60933				
SEE TABLE	SEE TABLE	CUSTOMER DRAWING				
		SCALE 10:1		SHEET 1 OF 1		
				REV G1		