

THE DRAWING IS UNPUBLISHED. RELEASED FOR PUBLICATION. ALL RIGHTS RESERVED.

LOC	REV	DESCRIPTION	DATE	OWN	APPD
G	14				
	H1	REVISED PER ECO-11-004587	11MAR11	RK	HMR



AMP WIRE RANGE	E13288 Listed
22-16 AWG SOLID OR STRANDED	22-16 AWG SOLID OR STRANDED
LR7189 Certified	MILITARY P/N AND CLASS
22-16 AWG SOLID OR STRANDED	NOT APPLICABLE

- △ STAMP AMP 22-18* APPROX AS SHOWN
22-16 SPLICES ARE STAMPED 22-18 IN
ACCORDANCE WITH MILITARY SPEC MIL-T-7928
COMMERCIAL WIRE RANGE IS 22-16
- △ MAXIMUM LENGTH DOES NOT INCLUDE
MANUFACTURING TABS

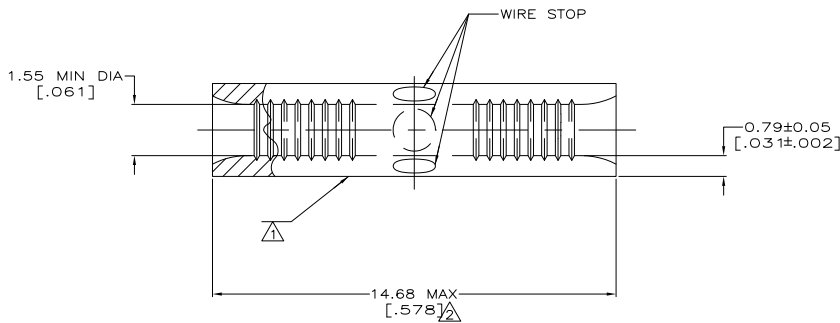
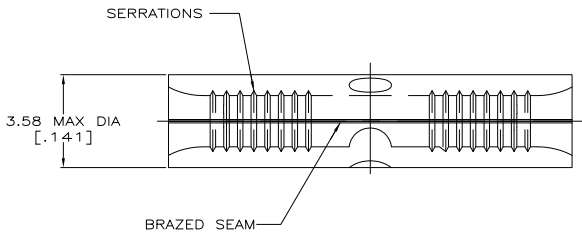

AMP INCORPORATED CUSTOMER SERVICE SYSTEMS		MAX RECOMMENDED OPERATING TEMPERATURE: 170° C MAX
FOR ADDITIONAL PRODUCT INFORMATION OR COPIES OF DRAWINGS AND TECHNICAL DOCUMENTS	PRODUCT INFORMATION CENTER 1-800-522-6752	VOLTAGE RATING: NOT APPLICABLE
FOR APPLICATION TOOLING INFORMATION	TOOLING ASSISTANCE CENTER 1-800-722-1111	WIRE CROSS SECTIONAL AREA RANGE: 0.26-1.65mm ² [509-3,260] CIR MILS SOLID OR STRANDED
FOR ORDER ENTRY	1-800-526-5142	THIS DRAWING IS A CONTROLLED DOCUMENT FOR AMP INCORPORATED. IT IS SUBJECT TO CHANGE AND THE CONTROLLING ENGINEERING ORGANIZATION SHOULD BE CONTACTED FOR THE LATEST REVISION.

THIS DRAWING IS A CONTROLLED DOCUMENT.		BY TA BRINKMAN 4-13-93	QUANTITY 100	LOOSE PIECE, BOX	8-31818-1
DIMENSIONS: MM [INCHES]		CHK DA PATTERSON 4-13-93	ON TAPE		2-31818-1
TOLERANCES UNLESS OTHERWISE SPECIFIED:		APPD JL MECKLEY	LOOSE PIECE		31818
PRODUCT SPEC		NAME	PACKAGING TYPE		PART NO
APPLICATION SPEC		TE Connectivity			
MATERIAL COPPER PER ASTM B-152 ANNEALED		FINISH TN PLATE 0.0004(0010) MIN THK PER MIL-T-10727	SIZE A2	SIZE	00779
CUSTOMER DRAWING		DRAWING NO	31818	RESTRICTED TO	
		SCALE	10:1	SHEET	1 of 1
		REV	H1		

1471-9 (5/11)

31818

A