

4

3

2

1

THIS DRAWING IS UNPUBLISHED. RELEASED FOR PUBLICATION
 © COPYRIGHT BY TYCO ELECTRONICS CORPORATION. ALL INTERNATIONAL RIGHTS RESERVED.

LOC	DIST	REVISIONS				
		P	LR	DATE	BY	APPD
G	14	MB		REVISED PER ECR-09-014174	24 JUN 09	JR TM

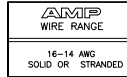

- 1 STAMP AMP 16-14* APPROX AS SHOWN
- 2 MAXIMUM LENGTH DOES NOT INCLUDE MANUFACTURING TABS
- 3 MATERIAL: COPPER PER ASTM B-152 ANNEALED
- 4 FINISH: TIN PLATE 0.00254 [.000100] MIN THK PER ASTM B-545
- 5 FINISH: TIN/LEAD (60/40) PLATE, .000100 MIN THK PER SAE-AMS-P-81728
- 6 GOLD PLATE .000100 MIN PER ASTM B488 OVER NICKEL PLATE .000050 MIN PER QQ-N-290
- 7 UL LISTED E13288, 16-14 AWG SOLID OR STRANDED
- 8 CSA CERTIFIED LR7189, 16-14 AWG SOLID OR STRANDED
- 9 PRELIMINARY - NOT FOR PRODUCTION

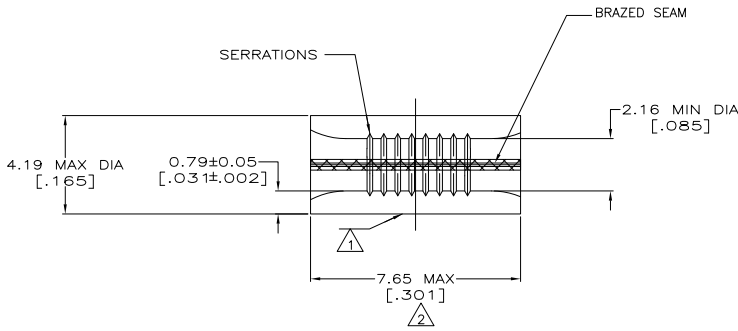

APPROVALS	FINISH	QTY	PACKAGE TYPE	PART NO
7 8	4	10	SEALED BAG	9 8-34137-5
7 8	4	100	LOOSE PIECE, BOX	8-34137-1
---	5	---	LOOSE PIECE	34137-3
---	6	---	LOOSE PIECE	34137-2
7 8	4	---	LOOSE PIECE	34137

AMP INCORPORATED CUSTOMER SERVICE SYSTEMS		MAX. RECOMMENDED OPERATING TEMPERATURE: 170° C
FOR ADDITIONAL PRODUCT INFORMATION OR COPIES OF DRAWINGS AND TECHNICAL DOCUMENTS 1-800-522-6752	PRODUCT INFORMATION CENTER 1-800-522-6752	VOLTAGE RATING: N/A
FOR APPLICATION TOOLING INFORMATION 1-800-722-1111	TOOLING ASSISTANCE CENTER 1-800-722-1111	CIRCULAR MIL AREA: 1.04-2.62mm²[2.050-5.180] SOLID OR STRANDED
FOR ORDER ENTRY 1-800-526-5142	THIS DRAWING IS A CONTROLLED DOCUMENT FOR AMP INCORPORATED. IT IS SUBJECT TO CHANGE AND THE CONTROLLING BUSINESS ORGANIZATION SHOULD BE CONTACTED FOR THE LATEST REVISION.	

THIS DRAWING IS A CONTROLLED DOCUMENT.		DA BRINKMAN 4-13-93	Tyco Electronics Corporation Harrisburg, PA 17105-3608	
DIMENSIONS: INCHES		DA PATTERSON 4-13-93	SPLICE, PARALLEL, SOLISTRAND	
OTHER DIMENSIONS: METERS		DA PATTERSON 4-13-93	APPLICATION SPEC: ---	
MATERIAL: ---		FINISH: ---	SIZE: A2	CAGE CODE: 00779
SEE TABLE		CUSTOMER DRAWING	SCALE: 10:1	SHEET: 1 of 1

1471-9 (1/08)

34137

A