

4

3

2

1

THIS DRAWING IS UNPUBLISHED. RELEASED FOR PUBLICATION
 © COPYRIGHT - BY TYCO ELECTRONICS CORPORATION. ALL INTERNATIONAL RIGHTS RESERVED.

LOC	DIST	REVISIONS					
AF	50	P	LTR	DESCRIPTION	DATE	DWN	APVD
		K1		REVISED PER ECR-08-016766	18JUL08	HMR	DL

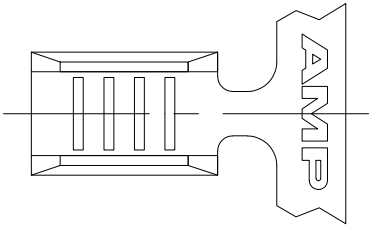

- 1 CONTINUOUS STRIP ON REEL.
- 2 CRIMP WIDTH: .090 F TYPE
 CRIMP HEIGHT: $(\pm .002) = (\text{TOTAL CMA} + 8300) / 145,800$
 FOR APPLICATOR INFORMATION CALL: 1-800-722-1111
 FOR PRODUCT INFORMATION CALL: 1-800-522-6752

- △3 0.002032 [.000080] MIN TIN PLATE.
- △4 PRELIMINARY - NOT FOR PRODUCTION.

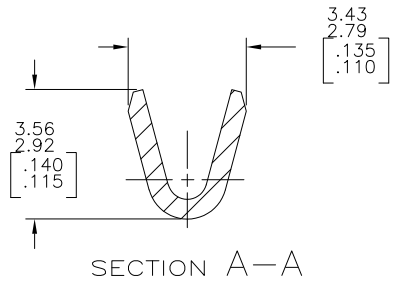
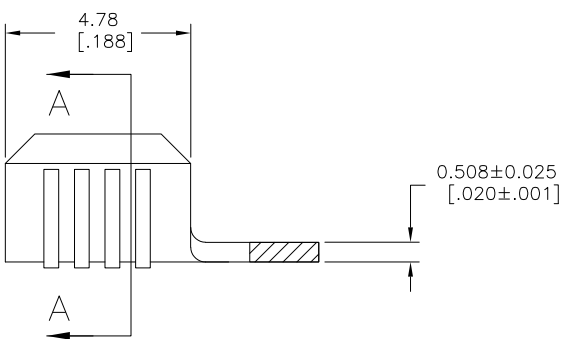

	△3	H00 COPPER	1200-2600 CMA	△4 60372-5
OBSOLETE	-	TA STAINLESS STEEL	1200-2600 CMA	60372-4
OBSOLETE	△3	T3 CR STEEL	1200-2600 CMA	60372-3
OBSOLETE	△3	082 BRASS	1200-2600 CMA	60372-2
	-	082 BRASS	1200-2600 CMA	60372-1

FINISH		MATERIAL		WIRE RANGE		PART NUMBER	
THIS DRAWING IS A CONTROLLED DOCUMENT.				DWN 24/JAN/97 PHILLIP M. FORTNEY		Tyco Electronics Corporation	
				CHK 24/JAN/97 JEFF R. RUTH		Harrisburg, PA 17105-3608	
DIMENSIONS: mm [INCHES]		TOLERANCES UNLESS OTHERWISE SPECIFIED:		APVD 24/JAN/97 DENNIS SCHWENK		NAME	
0 PLC ± -		0 PLC ± -		PRODUCT SPEC		SPLICE	
1 PLC ± -		1 PLC ± -		APPLICATION SPEC		SIZE CAGE CODE DRAWING NO	
2 PLC ± 0.25 [.010]		2 PLC ± -		114-2088		RESTRICTED TO	
3 PLC ± -		3 PLC ± -		WEIGHT		A3 00779 C=60372	
4 PLC ± -		4 PLC ± -		MATERIAL FINISH		SCALE 10:1 SHEET 1 of 1 REV K1	
MATERIAL SEE TABLE		FINISH SEE TABLE		CUSTOMER DRAWING			