

4

3

2

1

THIS DRAWING IS UNPUBLISHED. RELEASED FOR PUBLICATION
 © COPYRIGHT - By - ALL RIGHTS RESERVED.

LOC	DIST	REVISIONS			
P	LTR	DESCRIPTION	DATE	DWN	APVD
G	14	REVISED PER ECO-11-004917	11MAR11	RK	HMR

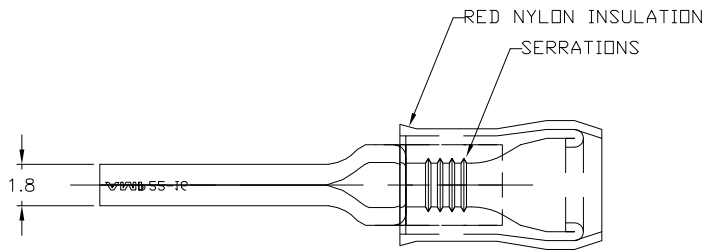

1 WIRE INSULATION DIA.
3.6 MAX DIA.

2 MATERIAL: BODY - CU PER ASTM B152
SLEEVE - CU PER ASTM B152
INSULATION - NYLON

3 FINISH: BODY - TIN PL ASTM B545
SLEEVE - TIN PL ASTM B545
INSULATION - COLOR - RED

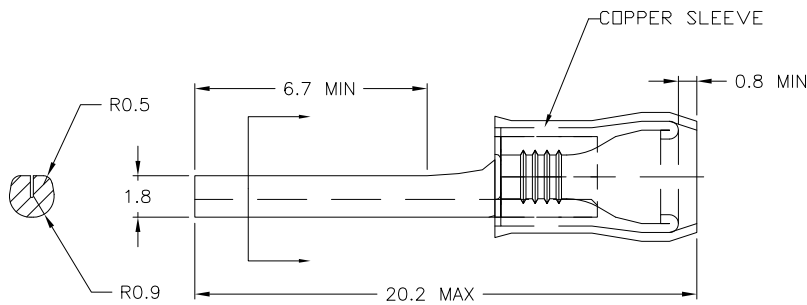

SUPERSEDED BY 696153-2	5000	ON TAPE	2-165142-1
	--	LOOSE PIECE	165142-0
	QTY	PACKAGE TYPE	PART NO

CUSTOMER SERVICE SYSTEMS		MAX RECOMMENDED OPERATING TEMPERATURE: 90°C [194°F]	THIS DRAWING IS A CONTROLLED DOCUMENT.		DWN JR RUTH 19JAN00	TE Connectivity	
FOR ADDITIONAL PRODUCT INFORMATION OR COPIES OF DRAWINGS AND TECHNICAL DOCUMENTS	PRODUCT INFORMATION CENTER 1-800-522-6752	VOLTAGE RATING: -	DIMENSIONS: mm	0 PLC ± - 1 PLC ± 0.38 [015] 2 PLC ± 0.20 [008] 3 PLC ± - 4 PLC ± - ANGLES ± -	CHK T MICHELUTTI 19JAN00	NAME	
FOR APPLICATION TOOLING INFORMATION	TOOLING ASSISTANCE CENTER 1-800-722-1111	CIRCULAR MIL AREA: 0.25-1.6mm ² [493-3158] STRANDED		TOLERANCES UNLESS OTHERWISE SPECIFIED:	APVD T MICHELUTTI 19JAN00	PRODUCT SPEC	
FOR ORDER ENTRY	1-800-526-5142	THIS DRAWING IS A CONTROLLED DOCUMENT FOR AMP INCORPORATED. IT IS SUBJECT TO CHANGE AND THE CONTROLLING ENGINEERING ORGANIZATION SHOULD BE CONTACTED FOR THE LATEST REVISION.	MATERIAL	FINISH	APPLICATION SPEC	SIZE A3	CAGE CODE 00779
					WEIGHT	DRAWING NO C-165142	RESTRICTED TO
					CUSTOMER DRAWING	SCALE 6:1	SHEET 1 OF 1
						REV G1	

1470-19 (3/11)