

4

3

2

1

THIS DRAWING IS UNPUBLISHED. RELEASED FOR PUBLICATION
 © COPYRIGHT - BY TYCO ELECTRONICS CORPORATION. ALL RIGHTS RESERVED.

| LOC | DIST | REVISIONS | | | |
|-----|------|-----------------------|---------|-----|------|
| P | LTR | DESCRIPTION | DATE | DWN | APVD |
| G | 86 | REV PER ECR 07-023647 | 12OCT07 | JR | TM |

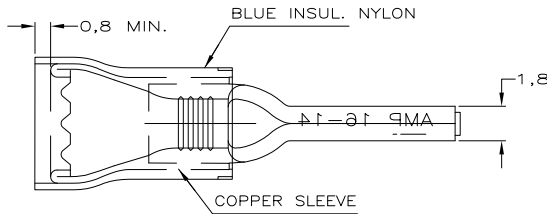

WIRE RANGE:
 1.0-2.6mm²
 (16-14 AWG)
 INSULATION RANGE:
 "A" MAX

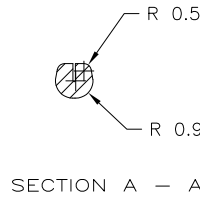
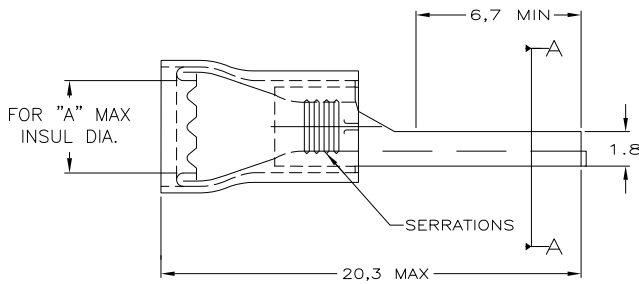

| | |
|-----------------|---------|
| 2-165046-1 | 165046 |
| PART NO ON TAPE | PART NO |

| | | | | |
|-------------|---------|------------|----------|----------|
| 1000 | 4.6 | TIN PLATED | COPPER | 165046-1 |
| 1000 | 4.3 | TIN PLATED | COPPER | 165046 |
| PACKAGE QTY | DIM "A" | FINISH | MATERIAL | PART NO |

THIS DRAWING IS A CONTROLLED DOCUMENT.

| | | | | | |
|-------------|--|------------------|---------------------------|-----------|------------------------------|
| DIMENSIONS: | TOLERANCES UNLESS OTHERWISE SPECIFIED: | DWN | Tyco Electronics | | Tyco Electronics Corporation |
| mm | | JR RUTH | Harrisburg, Pa 17105-3608 | | |
| | | CHK | NAME | | |
| | | T MICHELUTTI | PIDG WIRE PIN | | |
| | | APVD | - | | |
| | | T MICHELUTTI | - | | |
| | | PRODUCT SPEC | - | | |
| | | APPLICATION SPEC | - | | |
| | | WEIGHT | SIZE | CAGE CODE | DRAWING NO |
| MATERIAL | FINISH | | A3 | 00779 | 165046 |
| | | CUSTOMER DRAWING | RESTRICTED TO | | |
| | | | SCALE | SHEET | REV |
| | | | 5:1 | 1 OF 1 | G |