

4

3

2

1

THIS DRAWING IS UNPUBLISHED. RELEASED FOR PUBLICATION  
 © COPYRIGHT - By - ALL RIGHTS RESERVED.

LOC	DIST	REVISIONS			
P	LTR	DESCRIPTION	DATE	DWN	APVD
G	86				
	K1	REVISED PER ECO-11-004917	11MAR11	RK	HMR

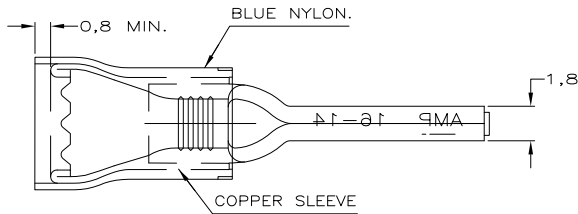

WIRE RANGE:  
 1.0-2.6mm<sup>2</sup>  
 ( 16-14 AWG )

INSULATION RANGE:  
 "A" MAX

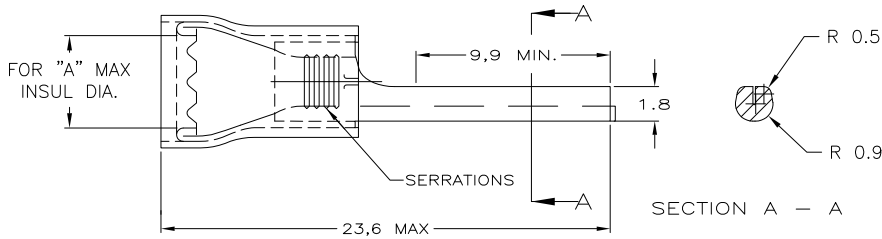

100	4.3	TIN PLATED	COPPER	8-165172-1
1000	4.8	TIN PLATED	COPPER	165172-2
SUPERSEDED BY 165172-2				
1000	4.6	TIN PLATED	COPPER	165172-1
1000	4.3	TIN PLATED	COPPER	165172-0
PACKAGE QTY	DIM "A"	FINISH	MATERIAL	PART NO

THIS DRAWING IS A CONTROLLED DOCUMENT.

DWN	JR RUTH	19FEB04	<b>STE</b> TE Connectivity
CHK	T MICHELUTTI	19FEB04	
APVD	T MICHELUTTI	19FEB04	
NAME	PIDG WIRE PIN ( LONG )		
DIMENSIONS:		TOLERANCES UNLESS OTHERWISE SPECIFIED:	
mm		0 PLC ± -	
		1 PLC ± -	
		2 PLC ± -	
		3 PLC ± -	
		4 PLC ± -	
		ANGLES ± -	
MATERIAL	FINISH		
-	-		
PRODUCT SPEC		SIZE	
-		A3	
APPLICATION SPEC		CAGE CODE	
-		00779	
WEIGHT		DRAWING NO	
-		C-165172	
CUSTOMER DRAWING		RESTRICTED TO	
-		-	
SCALE		SHEET	
5:1		1 of 1	
REV		K1	