

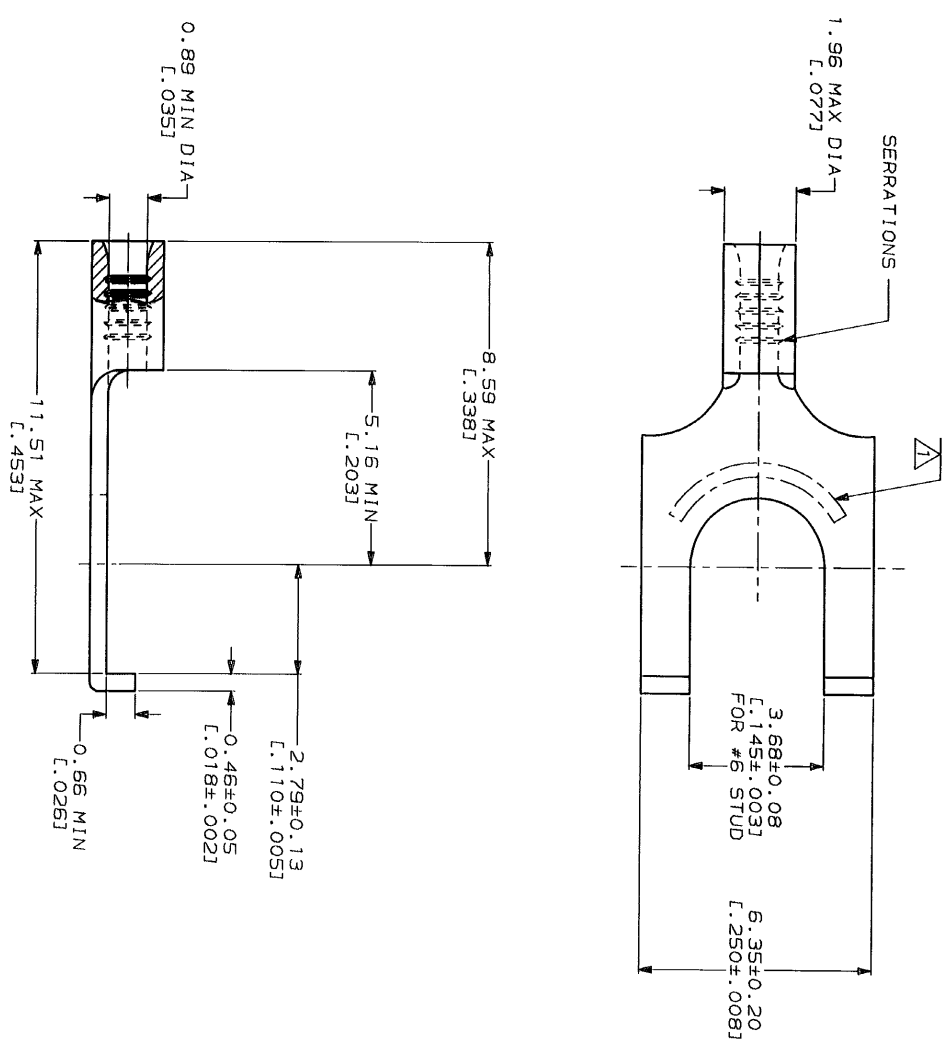

<b>AMP</b> WIRE RANGE	<b>UL</b> E13288 Listed
26-22 AWG STRANDED	NOT LISTED
<b>UL</b> LR7189 Certified	MILITARY P/N AND CLASS
NOT CERTIFIED	NOT APPLICABLE

STAMP AMP APPROX AS SHOWN



**AMP INCORPORATED**  
**CUSTOMER SERVICE SYSTEMS**

FOR ADDITIONAL PRODUCT INFORMATION OR COPIES OF DRAWINGS AND TECHNICAL DOCUMENTS  
1-800-522-6752

FOR APPLICATION TOOLING ASSISTANCE CENTER  
1-800-722-1111

FOR ORDER ENTRY  
1-800-526-5142

MAX RECOMMENDED OPERATING TEMPERATURE: 170°C MAX

VOLTAGE RATING: NOT APPLICABLE

WIRE CROSS SECTIONAL AREA RANGE: 0.1-0.41mm² [202-810] CIR MILS STRANDED

FOR ADDITIONAL PRODUCT INFORMATION OR COPIES OF DRAWINGS AND TECHNICAL DOCUMENTS  
1-800-522-6752

FOR APPLICATION TOOLING ASSISTANCE CENTER  
1-800-722-1111

FOR ORDER ENTRY  
1-800-526-5142

DO NOT SCALE PRINT. DIMENSIONS LISTED IN INCHES. TOLERANCES ON: 3 PLG DEC ±

MATERIAL: COPPER PER ASTM B-152 ANNEALED

FINISH: TIN PLATE 0.00254 [0.00100] MIN THK PER MIL-T-10727

DR 3-1-83  
TA BRINKMAN

CHK 3-1-83  
DA PATTERSON

APPD 3-1-83  
DE MILLER

APPD 3-1-83  
JL HECKLEY

PRODUCT SPEC

APPLICATION SPEC

WEIGHT

**AMP**  
AMP Incorporated  
Harrisburg, PA 17105-3608

PART NO  
51875-1

TERMINAL, FLANGED  
SPADE, BUDGET

SIZE CAGE CODE DRAWING NO  
SCALE 10:1

00779 51875

SHEET 1 OF 1