

© COPYRIGHT 1968 BY AMP INCORPORATED, HARRISBURG, PA.
 ALL INTERNATIONAL RIGHTS RESERVED, AMP INCORPORATED PRODUCTS
 COVERED BY U. S. AND FOREIGN PATENTS AND/OR PATENTS PENDING.

REVISIONS						
P	F	ZONE	LTR	DESCRIPTION	DATE	APPROVED
			C	REDRAWN & REVISED A-3943	1/5/78	
			D	REVISED AF 0169	1/25/78	SA/CH
			E	REV PER AF-6785	7/2/70	PAE/SA
			F	REV PER DL10-0090-97	20/7/67	PAE/CH

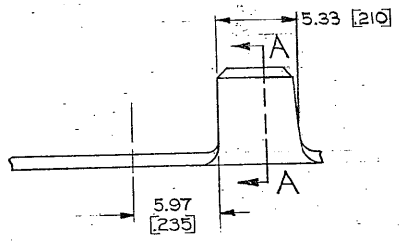
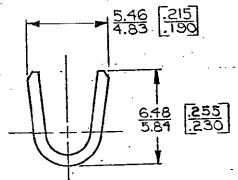
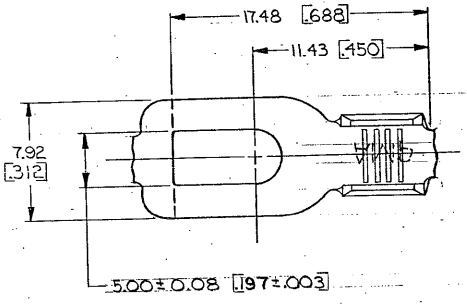
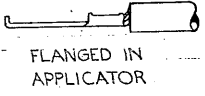

- 1. SUFFIX LETTER MUST BE USED ONLY WHEN ORDERING APPLICATOR TOOLING
- 2. CONTINUOUS STRIP ON REELS.
- 3. DIMENSIONS IN BRACKETS ARE IN INCHES

METRIC

WIRE RANGE	3.0-5.0 mm ² [12-10]	FINISH	NONE	MATERIAL	0.76 [030] BRASS	PART NO	40891-A 40891
STUD SIZE	#10			AMP INCORPORATED Harrisburg, Pa.			
MATERIAL		SEE TABLE		NAME		SPADE	
FINISH		SEE TABLE		SIZE	B	CODE IDENT NO	00779
				DRAWING NO	40891		
				SCALE	SHEET		

CUSTOMER DRAWING