

DRAWING MADE IN THIRD ANGLE PROJECTION

© COPYRIGHT 1968 BY AMP INCORPORATED, HARRISBURG, PA.
ALL INTERNATIONAL RIGHTS RESERVED. AMP INCORPORATED PRODUCTS
COVERED BY U. S. AND FOREIGN PATENTS AND/OR PATENTS PENDING.

FLANGED IN
APPLICATOR

SECT A-A

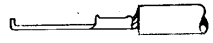
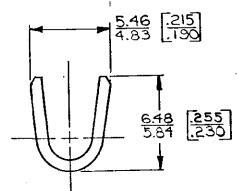
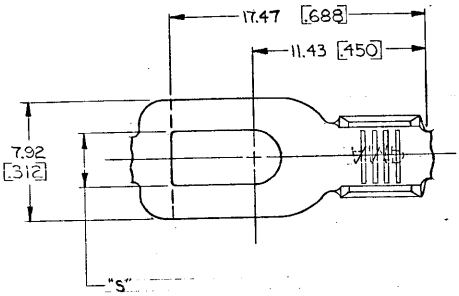

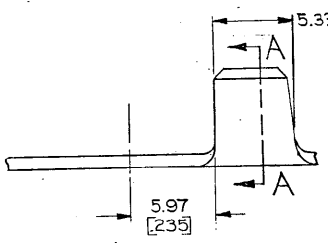
4.34 [.71]	M 4 #8	↑	↑	↑	↑	↑	△ 42113-4A
3.68 [.45]	M 3.5 #6						42113-4
4.34 [.71]	M 4 #8	↑	↑	↑	↑	↑	△ 42113-3A
3.68 [.45]	M 3.5 #6						42113-3
5.97 [.235]	STUD SIZE	3.0-5.0 mm ² [2-10]	SILVER	TIN	0.76 [030] BRASS	↑	42113-2A
±0.07 [003]	WIRE RANGE	FINISH	MATERIAL	PART NO			42113-2
							△ 42113-1A
							42113-1

REVISIONS					
P	ZONE	LTR	DESCRIPTION	DATE	APPROVED
✓		A	REDRAWN & REVISED A-3943	11/5/78	SS/
✓		B	REVISED	5/15/64	5/15/64
✓		C	OBS. - 4	AF-1556	5/15/64
✓		D	OBS. - 1	AF-3662	5/15/64
✓		E	REV PER AF-6786	7/5/70	PME/gy
✓		F	REV PER 0410-0090-97	11/5/78	PME/gy

- △ SUFFIX LETTER MUST BE USED ONLY WHEN ORDERING APPLICATOR TOOLING
- 2. CONTINUOUS STRIP ON REELS.
- 3. DIMENSIONS IN BRACKETS ARE IN INCHES

METRIC

UNLESS OTHERWISE SPECIFIED DIMENSIONS ARE IN METRIC (mm) TOLERANCES ON DECIMALS ±0.38 [015] ANGLES ±1° C		CONTRACT NO. 5/1/78		AMP INCORPORATED Harrisburg, Pa.	
MATERIAL SEE TABLE		DR. Schaffner		NAME	
FINISH SEE TABLE		APPROVED R.D. Frank		SPADE	
		APPROVED Schaffner		SIZE B	
		OTHER APPD		CODE IDENT NO 00779	
				DRAWING NO 42113	
				SCALE	
				SHEET	

CUSTOMER DRAWING