

19073

MATERIAL NUMBER	ENG. NO.	MATERIAL NUMBER TAPE MOUNTED	ENG. NO.	STUD SIZE	"S" ±.005	"W" MAX	"C" MIN	"L" MAX
190730179	C-830-10	190730180	C-830-10T	10	.198 (5.03)			
190730188	C-830-14	190730190	C-830-14T	14	.265 (6.73)	.540 (13.72)	.393 (9.98)	1.258 (31.95)
190730200	C-830-56	190730201	C-830-56T	56	.328 (8.33)			
190730212	C-836-04	190730213	C-836-04T	04	.119 (3.02)			
190730216	C-836-06	190730218	C-836-06T	06	.146 (3.71)	.292 (7.42)	.306 (7.77)	1.047 (26.59)
190730222	C-836-08	190730224	C-836-08T	08	.173 (4.39)			
190730227	C-840-10	190730228	C-840-10T	10	.198 (5.03)			
190730231	C-840-14	190730232	C-840-14T	14	.265 (6.73)	.602 (15.29)	.466 (11.83)	1.362 (34.59)
190730236	C-840-38	190730237	C-840-38T	38	.390 (9.91)			
190730242	C-840-56	190730243	C-840-56T	56	.328 (8.33)			

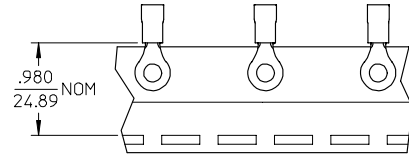
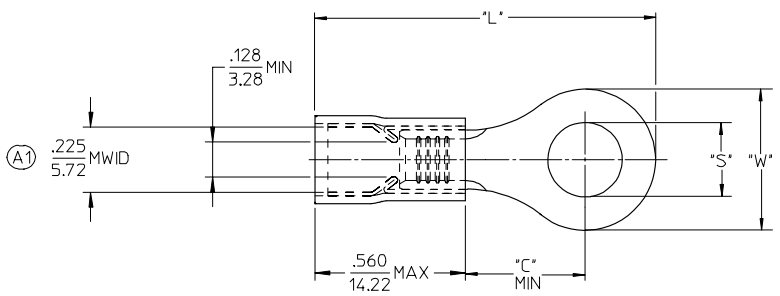

SALES DRAWING

- NOTES:  
 1. MATERIAL: COPPER (.040/1.02) THICK.  
 PLATING: ELECTROPLATE TIN  
 2. FERRULE: TIN PLATED BRASS  
 3. INSULATION: YELLOW NYLON  
 4. MWID=MAXIMUM WIRE INSULATION DIA.  
 5. ALL DIMENSIONS IN INCHES (MM).  
 6. WIRE SIZE: 12-10 AWG  
 4.0-6.0 MM<sup>2</sup>

EC NO: ETC2006-0152 DRAWN: ASAYDEH 2005/12/12 CHKC: JLOMASTR0005/12/13 APPR: RDEROSS 2005/12/14 REV A1	QUALITY SYMBOLS	GENERAL TOLERANCES (UNLESS SPECIFIED)	SCALE 4:1	DESIGN UNITS INCH	THIRD ANGLE PROJECTION	REVISE ON CAD ONLY															
	DESCRIPTION ▽ 0 ▽ 0	<table border="1"> <tr> <th></th> <th>mm</th> <th>INCH</th> </tr> <tr> <td>4 PLACES</td> <td>± ---</td> <td>± ---</td> </tr> <tr> <td>3 PLACES</td> <td>± ---</td> <td>± .005</td> </tr> <tr> <td>2 PLACES</td> <td>± 0.13</td> <td>± .01</td> </tr> <tr> <td>1 PLACE</td> <td>± 0.25</td> <td>± ---</td> </tr> </table>		mm	INCH	4 PLACES	± ---	± ---	3 PLACES	± ---	± .005	2 PLACES	± 0.13	± .01	1 PLACE	± 0.25	± ---	DIMENSION STYLE IN/MM DRAWN BY DMYRICK DATE 03/12/15 CHECKED BY SBEITZEL DATE 03/12/15 APPROVED BY RDEROSS DATE 03/12/15	TITLE RING TONGUE TERMINAL AVIKRIMP, 800-SERIES 12-10 AWG MOLEX INCORPORATED MATERIAL NO. SEE CHART SD-19073-008 DOCUMENT NO. 1 OF 1 SHEET NO.		
			mm	INCH																	
		4 PLACES	± ---	± ---																	
3 PLACES	± ---	± .005																			
2 PLACES	± 0.13	± .01																			
1 PLACE	± 0.25	± ---																			
DRAFT WHERE APPLICABLE MUST REMAIN WITHIN DIMENSIONS		THIS DRAWING CONTAINS INFORMATION THAT IS PROPRIETARY TO MOLEX INCORPORATED AND SHOULD NOT BE USED WITHOUT WRITTEN PERMISSION																			

tb\_frame\_B rev. B1 2000/08/01