

4

3

2

1

THIS DRAWING IS UNPUBLISHED.
 RELEASING FOR PUBLICATION
 ALL RIGHTS RESERVED.

LOC	DIST	REV	DESCRIPTION	DATE	BY	APPD
G	14	N2	REVISED PER ECO-11-004820	11MAR11	RK	HMR

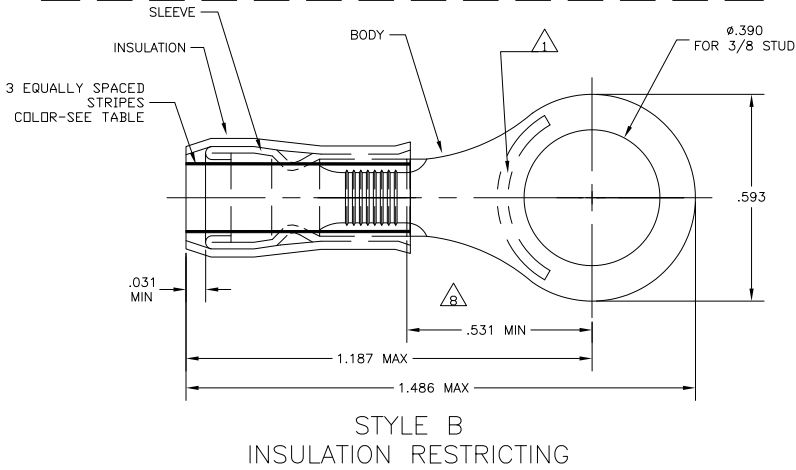
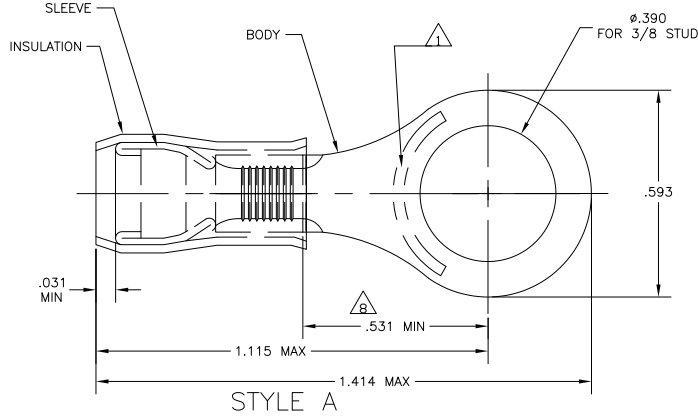

- △ STAMP "AMP - SEE TABLE" APPROX AS SHOWN
- 2 WIRE INSULATION DIA: SEE TABLE
- 3 TONGUE MATERIAL THK: .040±.002
- △ BODY: TIN PLATE .000100 MIN EXT THK PER ASTM B545
- △ SLEEVE: TIN PLATE .000100 MIN EXT THK PER ASTM B545
- △ SLEEVE: NICKEL PLATE PER QQ-N-290
- △ BODY & SLEEVE - CU PER ASTM B152
INSULATION - NYLON PER ASTM D4066
COLOR - YELLOW
- △ APPLIES FROM EDGE OF METAL WIRE BARREL TO CENTER OF STUD HOLE.
- △ MEETS MS25036-114, CLASS 1 & 2
- △ MEETS MS25036-114, CLASS 2
- △ MEETS M7928/1-61, CLASS 1 & 2
- △ MEETS M7928/1-68, CLASS 1 & 2

QTY	PACKAGE TYPE	STAMPING	WIRE DIA	WIRE SIZE	STRIPE COLOR	STYLE	BODY FINISH	SLEEVE FINISH	PART NO
200	LOOSE PIECE, BOX	10	.119-.200	10	BROWN	B			8-320577-5
50	LOOSE PIECE, BOX	12-10	.150-.230	12-10	---	A			8-320577-2
1000	ON TAPE & REEL	12-10	.150-.230	12-10	---	A			2-320577-3
500	LOOSE PIECE	10	.119-.200	10	BROWN	B			2-320577-2
500	LOOSE PIECE	12	.095-.200	12	YELLOW	B			2-320577-1
500	LOOSE PIECE	12-10	.150-.230	12-10	---	A			320577

CUSTOMER SERVICE SYSTEMS	
FOR ADDITIONAL PRODUCT INFORMATION OR COPIES OF DRAWINGS AND TECHNICAL DOCUMENTS	PRODUCT INFORMATION CENTER 1-800-522-6752
FOR APPLICATION	TOOLING ASSISTANCE CENTER 1-800-722-1111
FOR ORDER ENTRY	1-800-526-5142

MAX RECOMMENDED OPERATING TEMPERATURE: 105°C MAX	
VOLTAGE RATING: 300 VOLT MAX	CIRCULAR MIL AREA: 2.62-6.64mm² (5,180-13,100) STRANDED OR SOLID

THIS DRAWING IS A CONTROLLED DOCUMENT.	
DR: J.R. RUTH CHK: T. MICHELJUTTI APPD: T. MICHELJUTTI	2302009 2302009 2302009
TERMINAL, RING TONGUE, PIDG	
WIRE SIZE: 12-10 AWG	RESTRICTED TO: ---
CUSTOMER DRAWING	SCALE: 5:1 SHEET: 1 of 1 REV: N2