

4

3

2

1

THIS DRAWING IS UNPUBLISHED. RELEASED FOR PUBLICATION
 © COPYRIGHT - By - ALL RIGHTS RESERVED.

LOC	DIST	REVISIONS			
P	LTR	DESCRIPTION	DATE	DWN	APVD
G	14	E2	REVISED PER ECO-11-005027	11MAR11	RK HMR

AMP WIRE RANGE	Listed	LR7189 Certified
16-14 AWG SOLID OR STRANDED	16-14 AWG SOLID OR STRANDED	16-14 AWG SOLID OR STRANDED

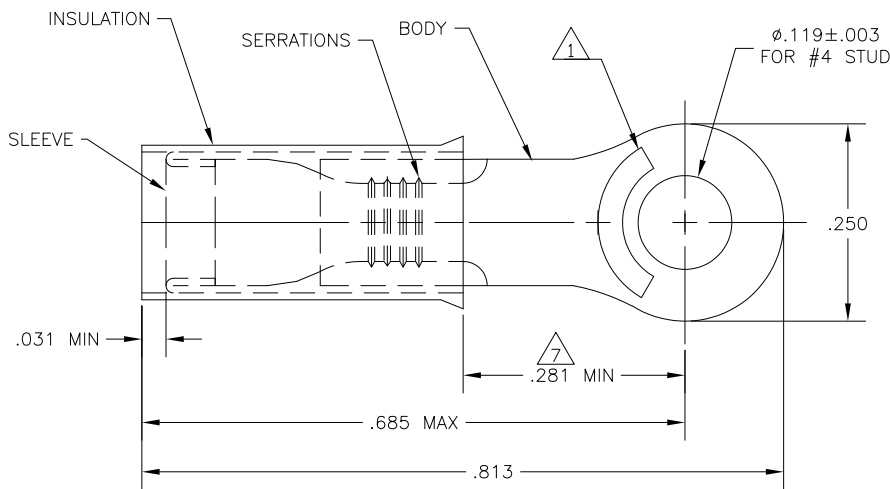

- 1 STAMP AMP 16-14*, APPROX AS SHOWN.
 - 2 TONGUE THICKNESS IS .031±.002
 - 3 FOR .105-.150 WIRE INSULATION DIA
 - 4 MAX RECOMMENDED OPERATING TEMP IS 105°C.
 - 5 300 VOLT MAX RATING.
 - 6 WIRE CROSS SECTIONAL AREA RANGE 1.04-2.62mm [2,050-5,180 CIR MILS]
- 7 APPLIES FROM EDGE OF METAL WIRE BBL TO CENTER OF STUD HOLE.

OBSOLETE	5000	ON TAPE, REEL	BODY & SLEEVE: COPPER PER ASTM B152 TIN PL. PER ASTM B-545 INSULATION: NYLON PER ASTM D4066, TYPE I COLOR: BLUE	-2-323676-1-
	-	LOOSE PIECE		323676
QTY	PACKAGING		MATERIAL / FINISH	PART NO

THIS DRAWING IS A CONTROLLED DOCUMENT.		DWN jr_ruth 01MAR10	TE Connectivity	
DIMENSIONS: INCHES		CHK T MICHELUTTI 01MAR10		
TOLERANCES UNLESS OTHERWISE SPECIFIED:		APVD T MICHELUTTI 01MAR10	NAME	
0 PLC ± -		PRODUCT SPEC		
1 PLC ± -		UL486B		
2 PLC ± -		APPLICATION SPEC		
3 PLC ± .008		114-2157		
4 PLC ± -		SIZE CAGE CODE DRAWING NO		
ANGLES ± 1°		A3 00779 C-323676		
MATERIAL SEE TABLE	FINISH SEE TABLE	WEIGHT	RESTRICTED TO	
CUSTOMER DRAWING		SCALE 8:1	SHEET 1 of 1	REV E2