

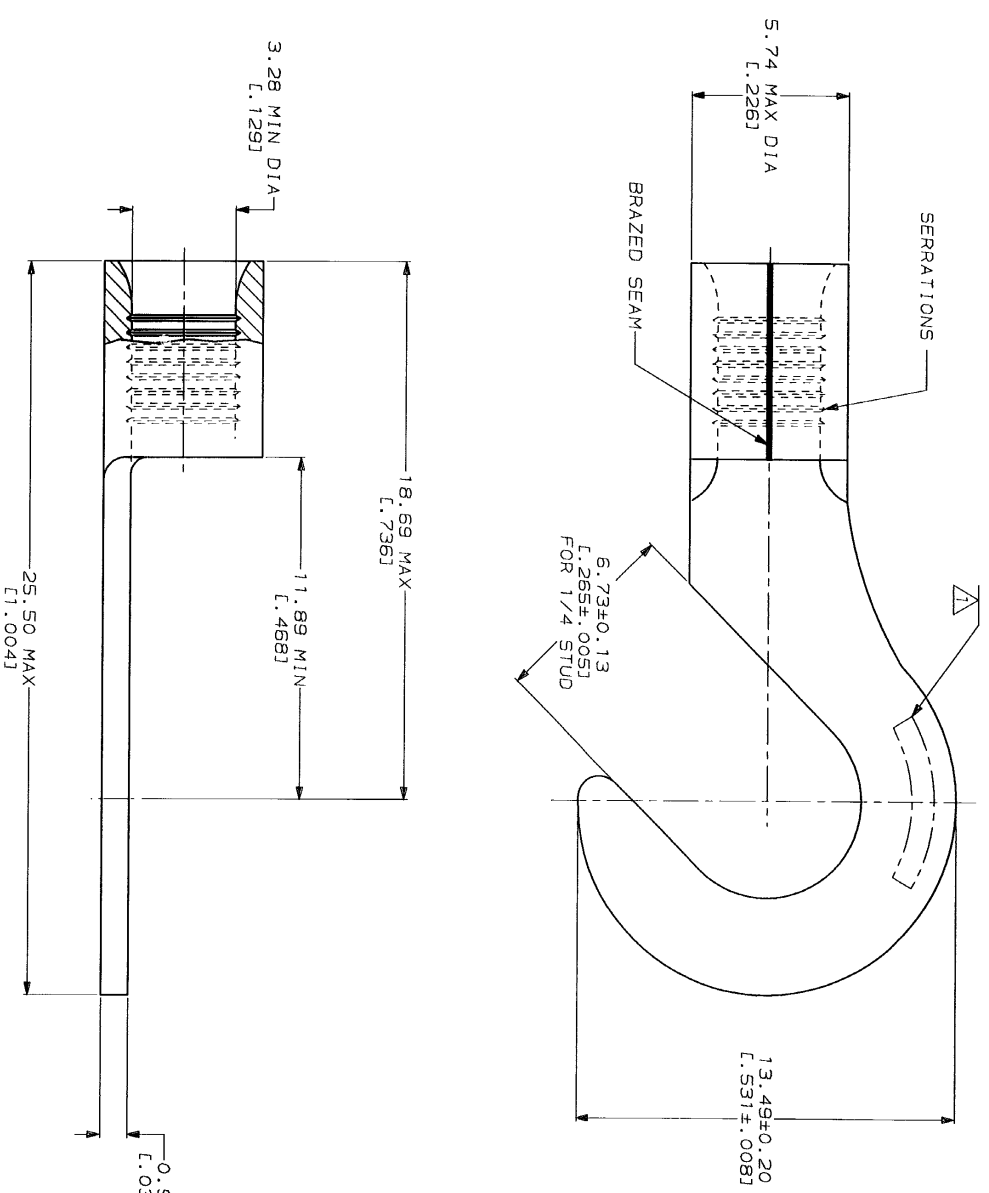

<b>AMP</b> WIRE RANGE	<b>UL</b> E13288 Listed
12-10 AWG SOLID OR STRANDED	12-10 AWG STRANDED
<b>LR7189</b> Certified	MILITARY P/N AND CLASS
12-10 AWG SOLID OR STRANDED	NOT APPLICABLE

△ STAMP AMP 12-10\* APPROX AS SHOWN



**AMP INCORPORATED  
 CUSTOMER SERVICE SYSTEMS**

FOR ADDITIONAL PRODUCT INFORMATION OR COPIES OF DRAWINGS AND TECHNICAL DOCUMENTS	PRODUCT INFORMATION CENTER 1-800-522-6752
FOR APPLICATION TOOLING INFORMATION	TOOLING ASSISTANCE CENTER 1-800-722-1111
FOR ORDER ENTRY	1-800-526-5142

MAX RECOMMENDED OPERATING  
 TEMPERATURE: 170°C MAX  
 VOLTAGE RATING:  
 NOT APPLICABLE  
 WIRE CROSS SECTIONAL AREA RANGE:  
 2.62-6.64mm<sup>2</sup> (5,180-13,100) CIR MILS  
 SOLID OR STRANDED

DO NOT SCALE PRINT.  
 UNLESS SPECIFIED  
 DIMENSIONS IN MILLIMETERS  
 TOLERANCES ON:  
 2 PLG DEC # -  
 ANGLES # -  
 MATERIAL  
 COPPER PER  
 ASTM B-152  
 ANNEALED

FINISH  
 TIN PLATE  
 0.00254L (0.00100) MIN  
 THK PER MIL-T-10727

DR 4-9-93 TA BRINKMAN	OR 4-9-93
CHK 4-9-93 DA PATTERSON	DR 4-9-93
APPD 4-9-93 DE MILLER	APPD 4-9-93
PRODUCT SPEC	UL CHECKLEY
APPLICATION SPEC	APPD 4-9-93
WEIGHT	UL CHECKLEY

QUANTITY	2500	ON TAPE	2-321632-1
	---	LOOSE PIECE	321632
		PACKAGING TYPE	
		PART NO	

**AMP**  
 AMP Incorporated  
 HORN BURG, PA 17105-3608

TERMINAL, HOOK  
 TONGUE, SOLI STRAND™

SIZE	00779	DRAWING NO	321632
SCALE	8:1	SHEET	1 OF 1

CUSTOMER DRAWING