

| LOC | DIST | REV | DESCRIPTION                    | DATE   | APPD |
|-----|------|-----|--------------------------------|--------|------|
| G   | 14   | P   | REV 8 REDRAWN PER 0720-0008-93 | 2-2-93 | JLB  |
| A   |      |     |                                |        |      |

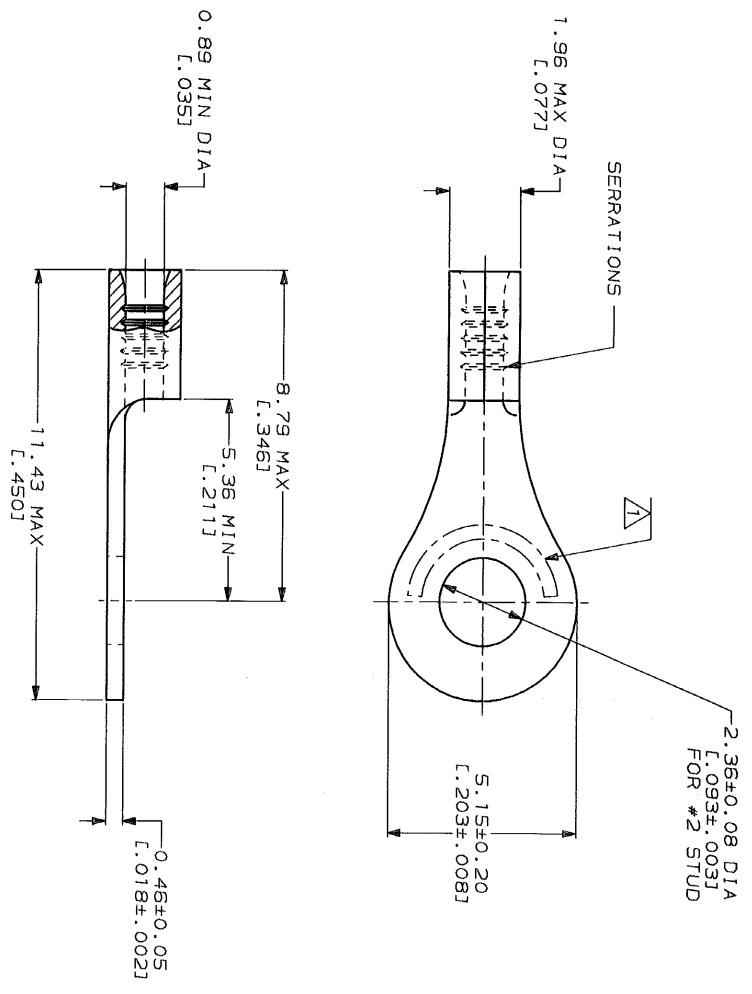

|                            |                               |
|----------------------------|-------------------------------|
| <b>AMP</b><br>WIRE RANGE   | <b>UL</b><br>E13288<br>Listed |
| 26-22 AWG<br>STRANDED      | NOT LISTED                    |
| <b>LR7189</b><br>Certified | MILITARY P/N<br>AND CLASS     |
| NOT CERTIFIED              | NOT APPLICABLE                |

△ STAMP AMP APPROX AS SHOWN



**AMP INCORPORATED  
CUSTOMER SERVICE SYSTEMS**

FOR ADDITIONAL  
PRODUCT INFORMATION OR  
COPIES OF DRAWINGS  
AND TECHNICAL DOCUMENTS  
FOR APPLICATION  
TOOLING INFORMATION  
FOR ORDER ENTRY

MAX RECOMMENDED OPERATING  
TEMPERATURE:  
170°C MAX

VOLTAGE RATING:  
NOT APPLICABLE

WIRE CROSS SECTIONAL AREA RANGE:  
0.1-0.41 mm<sup>2</sup> [202-810] C/P MILLS  
STRANDED

PRODUCT INFORMATION CENTER  
1-800-522-6752

TOOLING ASSISTANCE CENTER  
1-800-722-1111

1-800-526-5142

DO NOT SCALE PRINT.  
DIMENSIONS SPECIFIED  
UNLESS SPECIFIED OTHERWISE  
TOLERANCES ON:  
1 PLG DEC ± .01  
2 PLG DEC ± .005  
3 PLG DEC ± .0025  
ANGLES ± .5°

FINISH  
TIN PLATE  
0.00254 [L.000100] MIN  
THK PER MIL-T-10727

DR 2-2-93  
TA BRINKMAN

CHK 2-2-93  
DA PATTERSON

APPD 2-2-93  
DE MILLER

APPD 2-2-93  
JL MECKLEY

PRODUCT SPEC

APPLICATOR SPEC

WEIGHT

**AMP**  
AMP Incorporated  
Harrisburg, PA 17105-3608

NAME  
TERMINAL, RING  
TONGUE, BUDGET

SIZE  
CAGE CODE  
00779

DRAWING NO  
33695

SCALE 10:1

PART NO  
33695