

DRAWING MADE IN THIRD ANGLE PROJECTION
 THIS DRAWING IS UNPUBLISHED. RELEASED FOR PUBLICATION .19
 © COPYRIGHT 19 BY AMP INCORPORATED. ALL INTERNATIONAL RIGHTS RESERVED.

| LOC | | DIST | | ZONE | | LTR | | REVISIONS | | DATE | APPD |
|-----|----|------|---|------|--|-----|--|-----------|----------------------|---------|-------|
| 6 | 86 | P | F | | | | | R | REV PER 063A-0561-01 | 0700T02 | JR/MS |

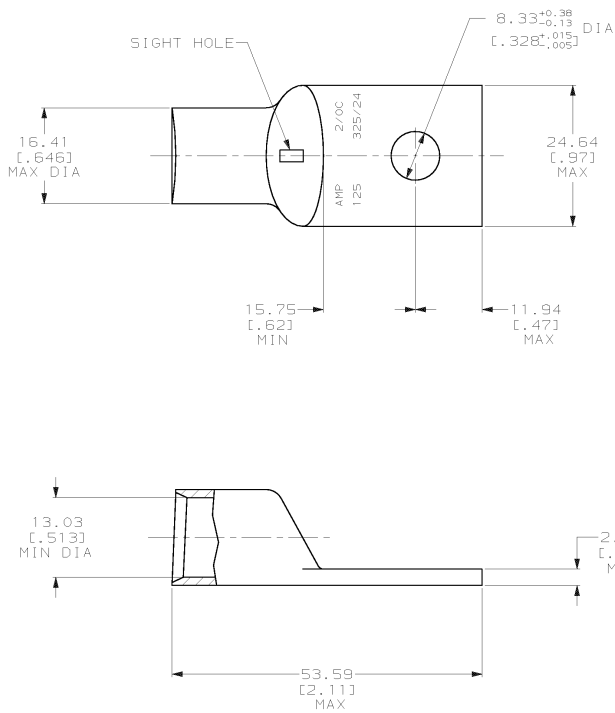

1 CIRCULAR MIL AREA RANGE: 119,500-150,500 CM
 TIN PL 0.00381 [.000150] MIN THK PER MIL-T-10727

325402

METRIC

| | | | |
|--|--|---|----------------------|
| | | 325402 | |
| | | PART NO | |
| DO NOT SCALE PRINT. UNLESS SPECIFIED DIMENSIONS IN mm (INCHES) TOLERANCES ON: 2 PLC DEC ± 0.51 (.020) 3 PLC DEC ± - ANGLES ± - | | DR 02/28/90 DK SCHIRM CHK 17JAN95 MS FEHER APPD 17JAN95 WJ VOCKROTH APPD 17JAN95 TL SHUTTER PRODUCT SPEC - | |
| MATERIAL ANNEALED COPPER ASTM B-75 | | NAME AMP AMP INCORPORATED Harrisburg, Pa. 17105 TERMINAL, AMPOWER WIRE SIZE: 2/0 AWG | |
| FINISH | | APPLICATION SPEC - | SIZE C |
| | | WEIGHT .056 LB | CAGE CODE 00779 |
| | | | DRAWING NO 325402 |
| | | | SCALE 2:1 |
| | | | SHEET 1 OF 1 |