

REV	DATE	DESCRIPTION
0	14	REVISED PER 0720-0230-93
1	2/28/84	

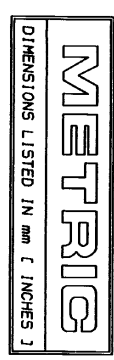

<b>AMP</b> WIRE RANGE 16-14 AWG STRANDED	<b>UL</b> E13288 Listed 16-14 AWG STRANDED
<b>LR7199</b> Certified	MILITARY P/N AND CLASS
NOT CERTIFIED	NOT APPLICABLE

△ STAMP AMP 16-14\* APPROX AS SHOWN

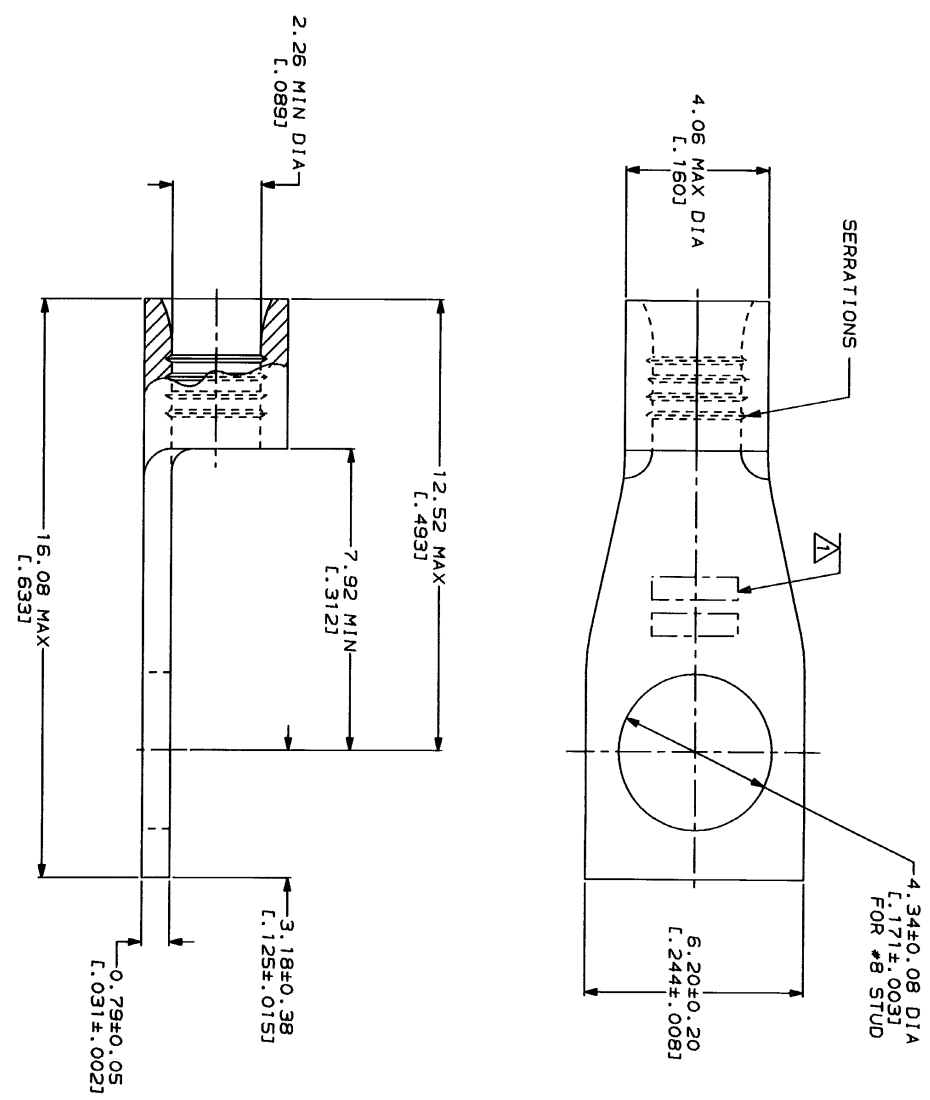

**AMP INCORPORATED  
 CUSTOMER SERVICE SYSTEMS**

FOR ADDITIONAL  
 PRODUCT INFORMATION OR  
 COPIES OF DRAWINGS  
 AND TECHNICAL DOCUMENTS  
 FOR APPLICATION  
 TOOLING INFORMATION  
 FOR ORDER ENTRY

PRODUCT INFORMATION CENTER  
 1-800-522-6752  
 TOOLING ASSISTANCE CENTER  
 1-800-722-1111  
 1-800-526-5142

MAX RECOMMENDED OPERATING  
 TEMPERATURE:  
 170° C MAX

VOLTAGE RATING:  
 NOT APPLICABLE

WIRE CROSS SECTIONAL AREA RANGE:  
 1.04-2.62mm<sup>2</sup> (2.050-5.180) CIR MILS  
 STRANDED

DO NOT SCALE PRINT.  
 UNLESS SPECIFIED  
 DIMENSIONS IN MILLIMETERS  
 TOLERANCES ON:  
 1. P/LC DEC ± .15  
 2. ANGLES ± .5

FINISH  
 TIN PLATE  
 0.00254 (0.00100) MIN  
 THK PER MIL-T-10727

DR 1-28-83  
 TA BRINKMAN  
 CHK 1-28-83  
 DA PATTERSON

APPRO 1-28-83  
 DE MILLER  
 APPRO 1-28-83  
 JL RECHLEY  
 PRODUCT SPEC

AMP 1471-B REV 3-82  
 29-FEB-94 09:20:18 0026453 /71 used/draw1123/draw1123/v bod es/v. 16-14  
**AMP**  
 Amp Incorporated  
 Harrisburg, PA 17105-3608  
 TERMINAL, RECTANGULAR  
 TONGUE, BUDGET  
 SCALE 10:1  
 CUSTOMER DRAWING  
 PART NO 35278  
 SHEET 1 OF 1