

4 3 2 1
 DRAWING MADE IN THIRD ANGLE PROJECTION
 THIS DRAWING IS UNPUBLISHED. RELEASED FOR PUBLICATION
 © COPYRIGHT 19 BY AMP INCORPORATED. ALL INTERNATIONAL RIGHTS RESERVED.

LOC				DIST				REVISIONS			
AF	50	P	F	ZONE	LTR	B	DESCRIPTION	DATE	APPD		
							REV PER OL10-0054-96	11/13/96	JR/PD		

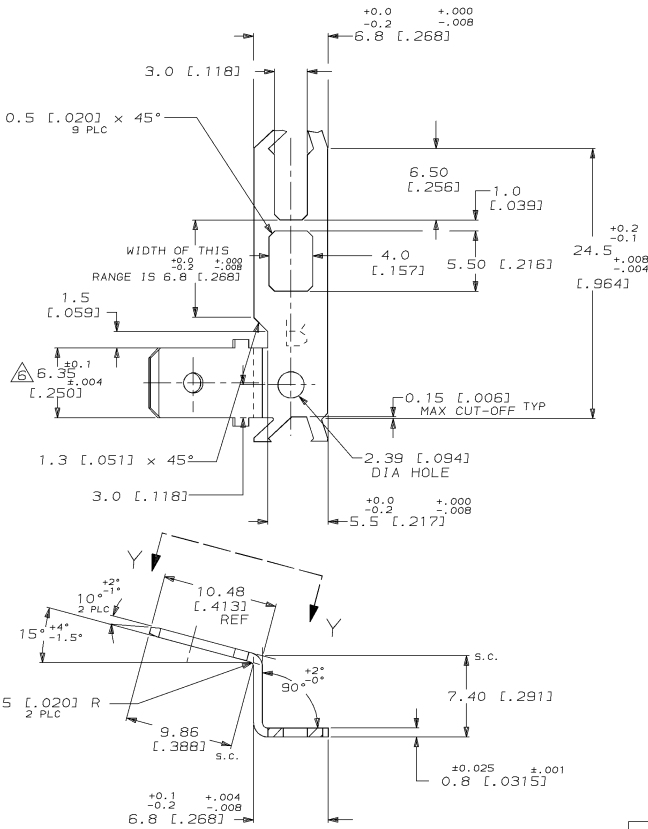

- 1 TIN PLATE 3um [0.000120] MIN OVER 1um [0.000040] MIN COPPER.
- 2 THE FLASH SHOULD BE LESS THAN 0.02mm [0.0008].
- 3 THE WARP SHOULD BE LESS THAN 0.2mm [0.008].
- 4 PLATED SURFACE SHOULD BE MATTE FINISH.
- 5 MASBAC P/N BLC26F00016.
- 6 6.35 DIMENSION MAY GROW A MAXIMUM OF 0.06 MM AT THE BEND.

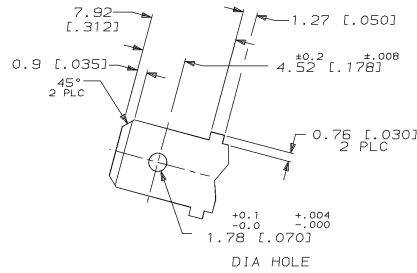

VIEW Y-Y

DO NOT SCALE PRINT. UNLESS SPECIFIED DIMENSIONS IN mm [INCHES] TOLERANCES ON + 2 PLC DEC ± 0.13 [0.005] 3 PLC DEC ± - ANGLES ± -		DR 6/6/94 JR RUTH	63790-1 PART NO	
MATERIAL BRASS C2600 1/2H OR C2680 1/2H		CHK 6/6/94 MS FEHER	AMP Incorporated Harrisburg, PA 17105-3608	
FINISH ⚠		APPD 6/6/94 P DESANTIS	NAME TAB, FASTON, 6.35 [0.250] SERIES RIGHT HAND	
APPLICATION SPEC -		PRODUCT SPEC -	SIZE C	CAGE CODE 00779
WEIGHT -		APPLICATION SPEC -	SCALE 4:1	DRAWING NO G=63790
			SHEET 1 OF 1	

THIS DRAWING IS A CONTROLLED DOCUMENT FOR AMP INCORPORATED. IT IS SUBJECT TO CHANGE AND THE OBSOLETE AND REVISIONS IDENTIFICATION SHOULD BE CONTACTED FOR THE LATEST REVISION.