

THIS COPY IS PROVIDED ON A RESTRICTED BASIS AND IS NOT TO BE USED IN ANY WAY DETRIMENTAL TO THE INTERESTS OF PANDUIT CORP.

PART NUMBER		TAB SIZE	WIRE RANGE AWG	HOUSING COLOR	MAX INSUL DIA	DIMENSIONS in		
PREFIX	PK					A ±.03	B ±.01	C ±.01
DVF18-187	-C -M -MY	.187 × .032 (4.8 × 0.8)	22-18	RED	.137 (3.48)	.76 (19.3)	.23 (5.8)	.10 (2.5)
DVF18-188	-C -M -MY	.187 × .020 (4.8 × 0.5)	22-18	RED	.137 (3.48)	.76 (19.3)	.23 (5.8)	.10 (2.5)
DVF18-205	-C -M	.187/.205 × .032 (4.8/5.2 × 0.8)	22-18	RED	.137 (3.48)	.76 (19.3)	.25 (6.4)	.12 (3.0)
DVF18-206	-C -M	.187/.205 × .020 (4.8/5.2 × 0.5)	22-18	RED	.137 (3.48)	.76 (19.3)	.25 (6.4)	.12 (3.0)
DVF18-250	-C -M -MY	.250 × .032 (6.3 × 0.8)	22-18	RED	.137 (3.48)	.81 (20.6)	.29 (7.4)	.12 (3.0)
DVF14-187	-C -M	.187 × .032 (4.8 × 0.8)	16-14	BLUE	.162 (4.11)	.76 (19.3)	.23 (5.8)	.10 (2.5)
DVF14-188	-C -M	.187 × .020 (4.8 × 0.5)	16-14	BLUE	.162 (4.11)	.76 (19.3)	.23 (5.8)	.10 (2.5)
DVF14-205	-C -M	.187/.205 × .032 (4.8/5.2 × 0.8)	16-14	BLUE	.162 (4.11)	.76 (19.3)	.25 (6.4)	.12 (3.0)
DVF14-206	-C -M	.187/.205 × .020 (4.8/5.2 × 0.5)	16-14	BLUE	.162 (4.11)	.76 (19.3)	.25 (6.4)	.12 (3.0)
DVF14-250	-C -M	.250 × .032 (6.3 × 0.8)	16-14	BLUE	.162 (4.11)	.81 (20.6)	.29 (7.4)	.12 (3.0)

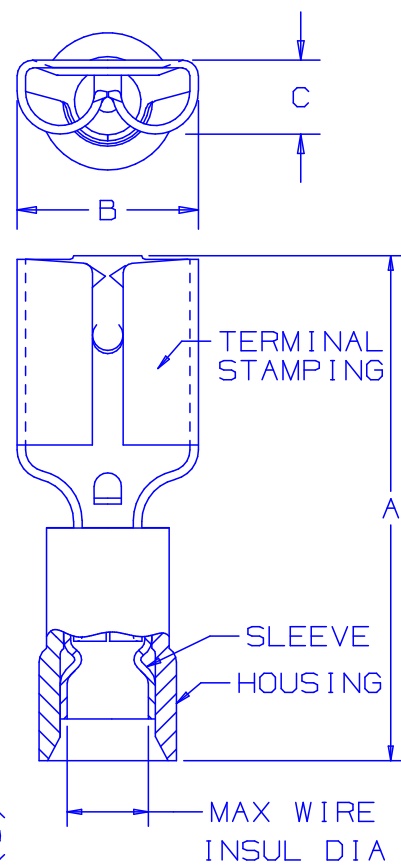

LISTED CERTIFIED 20H3

A41635_04

- NOTES:
- USED FOR:
 - A. 300V MAX. VOLTAGE RATING
 - B. STRANDED COPPER WIRE ONLY
 - C. 194°F (90°C) MAX. TEMP. RATING OF INSUL. MATERIAL.
 - MATERIAL:
 - A. STAMPING: .016 (0.41) THK BRASS, TIN PLATED
 - B. SLEEVE: .016 (0.41) THK. BRASS, TIN PLATED
 - C. HOUSING: VINYL
 - INSTALLATION TOOLS: CT-500, CT-1550, CT-1551, CT-550, CT-2400 (CT-2455CH), CT-600 (CT-500CH OR CT-550CH)
 - DIMENSIONS IN BRACKETS ARE IN MILLIMETERS
 - PACKAGE QUANTITY: -C = 100 PCS., -M = 1000 PCS., -MY = 1000 PCS.
 - WIRE STRIP LENGTH: $9/32^{+1/32}_{-0}$ (7.1^{+0.8}₋₀)

04	5/05	JHNU		ADDED PACKAGING CODE "MY" TO DRAWING.					
03	11/04	KLFU	SKB	ADDED GEOMETRY			SKB	TRO	
02	6/97	JAMB	RLS	MAX. TEMP. RATING OF INSULATION MATERIAL WAS 221°F (105°C)	05958		LA	DBH	
01	5/97	JAMB	RLS	ADDED " LISTED 20H3 "AND " CERTIFIED " TO EXISTING UL AND CSA SYMBOLS	05813		LA	DBH	
REV	DATE	BY	CHK	DESCRIPTION	ECN #	QA	CUST	PM	SUP

PANDUIT CORP
TINLEY PARK, ILLINOIS

VINYL INSULATED FEMALE DISCONNECT, FUNNELED WIRE ENTRY (DVF SERIES)

DRAWN BY TSM
CHK'D RLS
SCALE NONE
DRAWING NO. A41635