

DRAWING MADE IN THIRD ANGLE PROJECTION

THIS DRAWING IS UNPUBLISHED. RELEASED FOR PUBLICATION

© COPYRIGHT 19 BY AMP INCORPORATED. ALL INTERNATIONAL RIGHTS RESERVED.

LOC	DIST	ZONE	LTR	REVISIONS	DATE	APPD
AF	50			6 REDRAWN AF-7182	2/11/91	-

- 1 SUPPLIED IN LOOSE PIECE FORM.
- 2 FOREIGN PRODUCTION ONLY. LEAD-IN CHAMFER ON RECEPT.
- 3 FOREIGN PRODUCTION ONLY.

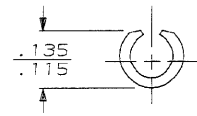
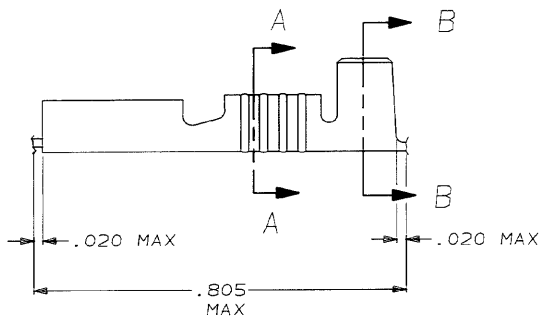

SECTION A-A

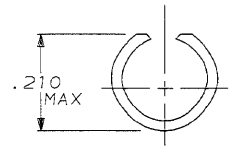

SECTION B-B

FINISH	.120-.145	18-16	41445-1 41445
INSULATION RANGE			
WIRE SIZE			
PART NO			
<small>DO NOT SCALE PRINT. UNLESS SPECIFIED DIMENSIONS ARE IN INCHES. TOLERANCES ON: 1 PLC DEC = - 2 PLC DEC = .015 ANGLES = -</small>		<small>DR 2/11/91 JR RUTH CHK 2/11/91 P FORNEY APPD 2/11/91 G MEYERS</small>	
<small>MATERIAL #4H BRASS</small>		AMP AMP Incorporated Harrisburg, PA 17105-3608	
<small>FINISH SEE TABLE</small>		<small>NAME RECEPTACLE, FASTON, .250 SERIES</small>	
<small>APPLICATION SPEC</small>		<small>SIZE B</small>	<small>CAGE CODE 00779</small>
<small>WEIGHT -</small>		<small>SCALE 5:1</small>	<small>DRAWING NO 41445</small>
			<small>SHEET 1 OF 1</small>

AMP 1470-15 REV 11-89

08 FEB 1991 14.07.28 AMP13463 45512844EP220214MG212140 FASTON-PROD44.250-STR

CUSTOMER DRAWING