

DRAWING MADE IN THIRD ANGLE PROJECTION

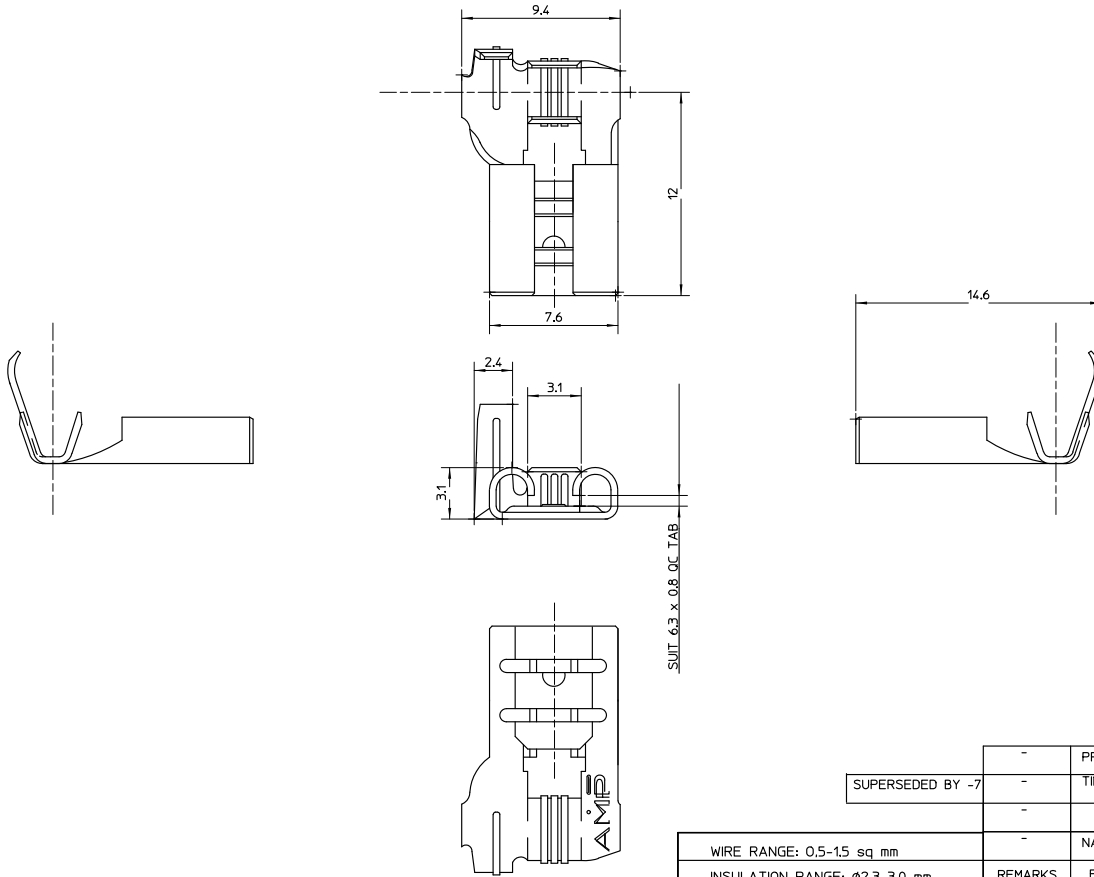

-	PRE TIN	BRASS	190542-7
-	TIN PLATED MATTE	BRASS	190542-4
-	-	NICKEL SILVER	190542-2
-	NATURAL	BRASS	190542-1

WIRE RANGE: 0.5-1.5 sq mm		REMARKS	FINISH	MATERIAL	PART No
INSULATION RANGE: Ø2.3-3.0 mm		SIZE			
		DATE 16/03/94		CHK W.Riede	
		DR H. Thai		APP -	
		NAME RECEPTICLE FLAG, FASTON, 0.250			
		SCALE AS SHOWN		SIZE A3	
		DWG No. C-190542		SHEET 1 OF 1	
		REV		C	

REV	DESCRIPTION	DATE	BY	CHK
C	ECR-05-016592	19/11/05	WR	
B1	ECN FA 00 0042 04	28/10/04	WR	
B	ECN FA 00 0013 97	24/07/97	VK	
A	ECN FA 00 0003 95	07/07/95	BL	

P F LTR REVISION RECORD APP DATE

**AMP** Australian AMP Pty. Limited  
Rusden Avenue, CASTLE HILL, NSW

CUSTOMER DRAWING

THIS INFORMATION IS CONFIDENTIAL AND DISCLOSED TO YOU BY AMP PERSONNEL OR BY YOU TO OTHER THAN AMP PERSONNEL WITHOUT WRITTEN AUTHORIZATION FROM AUSTRALIAN AMP