

4

3

2

1

THIS DRAWING IS UNPUBLISHED. RELEASED FOR PUBLICATION
 BY TYCO ELECTRONICS CORPORATION. ALL RIGHTS RESERVED.

LOC	DIST	REVISIONS			
P	LTR	DESCRIPTION	DATE	BY	APPD
B		REV PER 0G3A-0447-02	29JUL02	JR	ND
B1		REVISED PER ECO-09-021826	21AUG09	KK	AEG

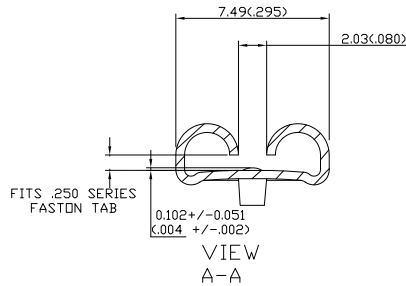
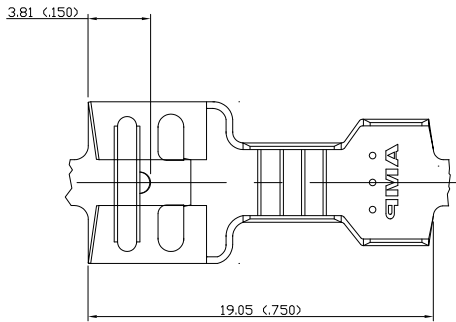

- CONTINUOUS STRIP ON REELS.
- MATING TAB THK IS 0.81±0.025 [.032±.001].
- DIM'S IN BRACKETS ARE IN INCHES
- ⚠ OBSOLETE PARTS: OBSOLETE CIS STREAMLINING PER D.RENAUD/D.SINISI

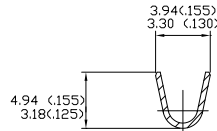
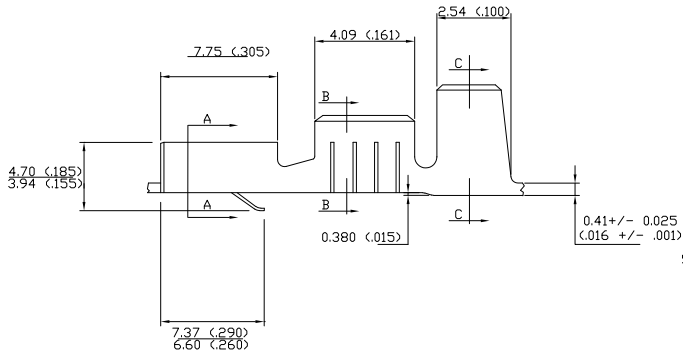

SECT B-B

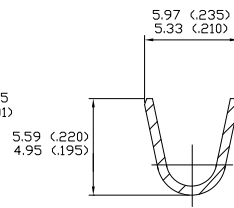

SECT C-C

⚠ OBSOLETE	2.54-4.32[.100-.170]	0.8-2.0mm [18-14]	TIN	157480-2
	2.54-4.32[.100-.170]	0.8-2.0mm [18-14]	NONE	157480-1
	INSULATION RANGE	WIRE SIZE	FINISH	PART NO.

THIS DRAWING IS A CONTROLLED DOCUMENT.		REV	29AUG02	Tyco Electronics Corporation	
DIMENSIONS:		DESIGN	29AUG02	Harrisburg, PA 17105	
INCHES		CHK	COON	RECEPTACLE, FASTON-FASTON,	
OTHER DIMENSIONS:		APPD	29AUG02	.250 SERIES	
0 PLC ± .005		APPLICATION SPEC			
1 PLC ± .004		SIZE			
2 PLC ± .003		WEIGHT			
3 PLC ± .010		CUSTOMER DRAWING			
4 PLC ± .005		SCALE			
ANGLES ± .5°		NTS			
FINISH		SHEET 1 OF 1			
MATERIAL: BRASS		REV B1			
FINISH: SEE TABLE					

AMP 1471-9 REV 31MM0200

157480

A