

DRAWING MADE IN THIRD ANGLE PROJECTION

THIS DRAWING IS UNPUBLISHED. RELEASED FOR PUBLICATION, 19  
 © COPYRIGHT 19 BY AMP INCORPORATED. ALL INTERNATIONAL RIGHTS RESERVED.

LOC	DIST	REVISIONS				
P	F	ZONE	LTR	DESCRIPTION	DATE	APPD
AF	50	B		REL PER 063A-0258-02	10MAY02	JR/GP

- TIN PLATE 0.00254 [.000100] MIN OVER 0.00127 [.000050] MIN THK NICKEL.
- SUPPLIED IN LOOSE PIECE

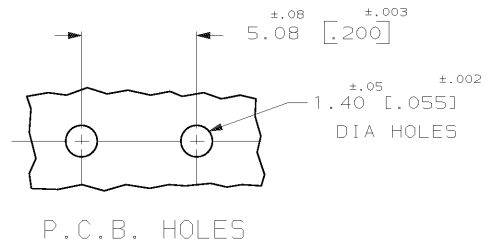
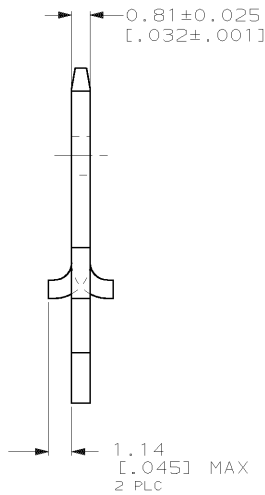
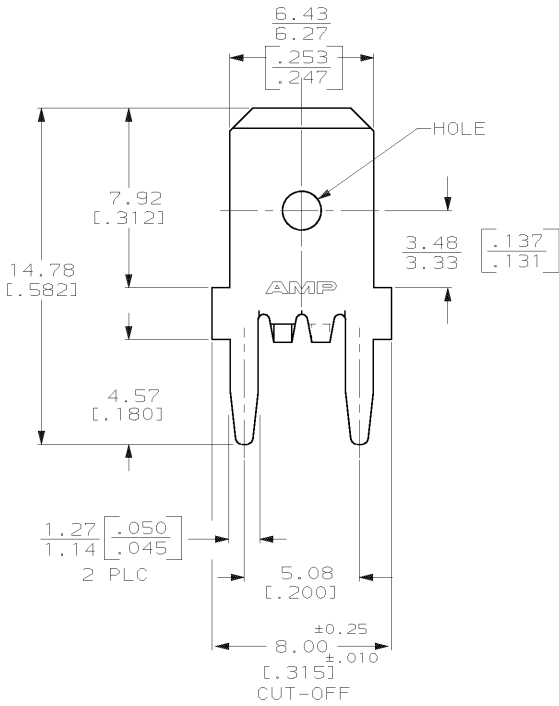

THIS DRAWING IS A CONTROLLED DOCUMENT FOR AMP INCORPORATED. IT IS SUBJECT TO CHANGE AND THE CONTROLLING ENGINEERING ORGANIZATION SHOULD BE CONTACTED FOR THE LATEST REVISION.

DO NOT SCALE PRINT. UNLESS SPECIFIED DIMENSIONS IN mm [INCHES] TOLERANCES ON: 2 PLC DEC ± 0.25 (.010) 3 PLC DEC ± - ANGLES ± -		DR 23MAY00 JR RUTH	AMP AMP Incorporated Harrisburg, PA 17105-3608	
CHK 23MAY00 HS FEHER	APPD 23MAY00 G ROSTA	NAME	TAB, P.C. BOARD, 6.35 [.250] SERIES	
APPD 23MAY00 G PORTA	PRODUCT SPEC -	SIZE B	CAGE CODE 00779	DRAWING NO C=1217421
FINISH 1	APPLICATION SPEC 114-2115	SCALE 6:1	SHEET 1 OF 1	
PART NO 1217421-1				