

SCALA NON IMPEGNATIVA
(DO NOT SCALE)
DIMENSIONI IN
DIMENSIONS IN

METRIC

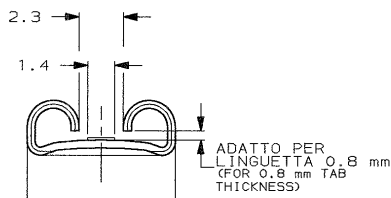

0.5 MAX.
TESTIMONE DI TAGLIO
(CUT-OFF DIM.)

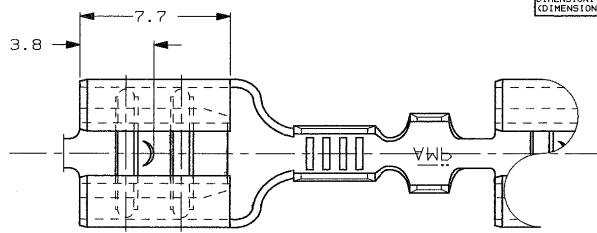
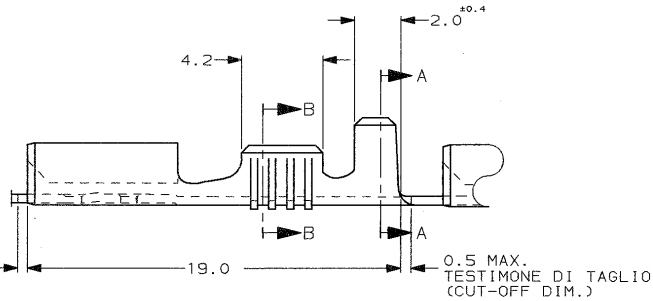

SEZIONE B-B
(SECTION B-B)

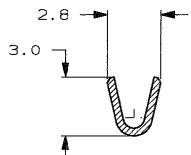

SEZIONE A-A
(SECTION A-A)

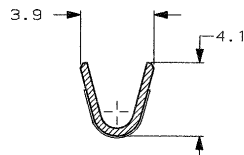

1) STATO DI FORNITURA - SCALA 1:1
(SUPPLY CONDITION - SCALE 1:1)

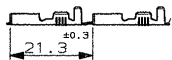

SENDO DI USCITA
DEL TERMINALE
DALLA BOBINA
(DIRECTION OFF
TOP OF REEL)

2) SPECIFICA DI PRODOTTO 108-20019
(PRODUCT SPEC. 108-20019)

⚠️ NON DISPONIBILE DA AMP ITALIA
(NOT AVAILABLE FROM AMP ITALY)

STAGNATO (TIN PLATED)	OTTONE (BRASS)	0-160915-5
STAGNATO (TIN PLATED)	BRONZO FOS. (PH. BRONZE)	0-160915-2
NUDO (UNPLATED)	BRONZO FOS. (PH. BRONZE)	0-160915-1

NOTE	FINITURA / COLORE (FINISH / COLOUR)	MATERIALE (MATERIAL)	NUMERO (AMP P/N)	REV
------	--	-------------------------	---------------------	-----

CUSTOMER DWG.
FOR REFERENCE ONLY

DISEGNO PER CLIENTE
SOLO PER RIFERIMENTO

THIS DRAWING IS UNPUBLISHED. RELEASE FOR PUBLICATION 19

© COPYRIGHT IS RESERVED BY AMP INCORPORATED, HARRISBURG, PA. ALL INTERNATIONAL RIGHT RESERVED. AMP PRODUCTS MAY BE COVERED BY U.S. AND FOREIGN PATENT AND/OR PATENT PENDING.

TOLLERANZE, SE NON DIVERSAMENTE SPECIFICATE (TOLERANCES, UNLESS OTHERWISE SPECIFIED)

DIAM. ISOLANTE (INS. DIA. RANGED)	RANGO FILO (WIRE RANGED)	mm2	SCALA (SCALE)
1.4-2.3	0.5-1.0		5:1

AMP ITALIA S.p.A.
Corso F.lli Cervi, 15
COLLENO (TORINO)

DIS. H. VAALLI
COR. 14 JUN 2000
DESCRIZIONE (DESCRIPTION)
FASTON® Connector,
.250" sr. REC. CONTACT.

REV.	REVISIONI (REVISION RECORD)	DIS. DATA (DR DATE)	LOC. SIZE (LOC. NO)	NUMERO (CAGE NO)	REV.	FOGLIO (SHEET)	DI. (DIP)
J	OBSOLETE PARTS & REDRAWN E100-0300-95	H.Y. 2000	I	A3	C-160915	J	11

DISTRIBUZIONE
GRUPPO IRI