

SCALA NON IMPEGNATIVA
(DO NOT SCALE)
DIMENSIONI IN mm
(DIMENSIONS IN IN)

METRIC

PROIEZIONE EUROPEA
(EUROPEAN PROJECTION)

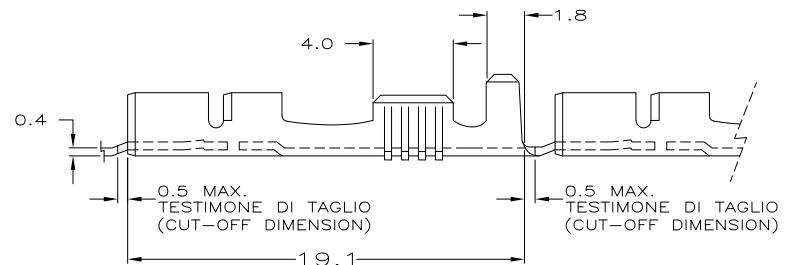
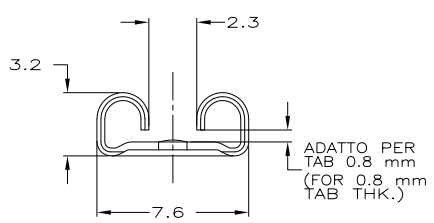
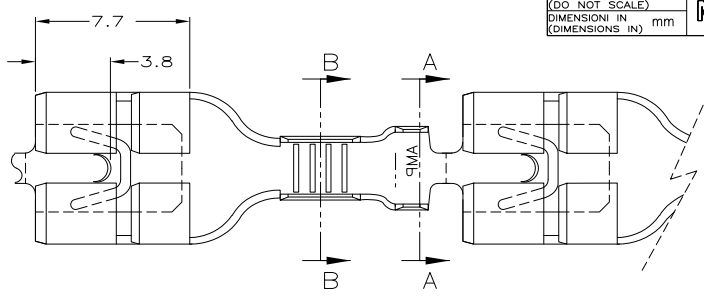

SEZIONE A-A
SECTION A-A

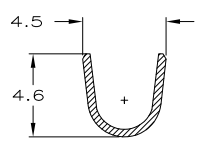

SEZIONE B-B
SECTION C-C

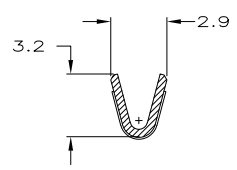

OBSOLETE	NUDO (UNPLATED)	Cu Ni Zn	0-100495-6	C
	STAGNATO (TIN PLATED)	BRONZO FOS. (PHOS. BRONZE)	0-100495-4	C
	STAGNATO (TIN PLATED)	OTTONE (BRASS)	0-100495-2	C
	NUDO (UNPLATED)	OTTONE (BRASS)	0-100495-1	C
	FINITURA / COLORE (FINISH / COLOUR)	MATERIALE (MATERIAL)	NUMERO (AMP P/N)	REV

CUSTOMER DWG. FOR REFERENCE ONLY DISEGNO PER CLIENTE SOLO PER RIFERIMENTO

THIS DRAWING IS UNPUBLISHED. RELEASE FOR PUBLICATION 19
 © COPYRIGHT 19 BY AMP INCORPORATED, HARRISBURG, PA. ALL INTERNATIONAL RIGHT RESERVED. AMP PRODUCTS MAY BE COVERED BY U.S. AND FOREIGN PATENT AND/OR PATENT PENDING.
 TOLLERANZE: SE NON DIVERSAMENTE SPECIFICATO (INS. DIA. RANGE) (RANGO FILO (WIRE RANGE) (SCALE)
 2.3-3.3 0.5-1.5 5:1
 TOLLERANZE: UNLESS OTHERWISE SPECIFIED
 ± 0.3
 ANGOLI (ANGLES) ± 2'

D2	REVISED PER ECO-09-020889	KV	10 MAR 2000	DIS. H. YAALI (DR.)	DESCRIZIONE (DESCRIPTION)	FASTON [®] Connector,
D1	UPDATED ETO-0172-04	H.Y.	11 NOV 2004	CONT. C. TARTARI (CHK)	.250" sr. L.I.F. FASTON CONTACT.	
D	OBSOLETE PARTS & REDRAWN ETO-0302-99	H.Y.	08 MAR 2000	APP.	LOC. SIZE (DWG NO)	REV. (SHEET) D1
REV. (REVISION RECORD)		DIS. DATA (DR)		APP.	1 A3	C-100495 D2 1 (of 1)

1) STATO DI FORNITURA SCALA 1:1 (SUPPLY CONDITION SCALE 1:1)

 SENSO DI USCITA DEL TERMINALE DALLA BOBINA (DIRECTION OFF TOP OF REEL)

2) SPECIFICA DI PRODOTTO 108-19084 (PRODUCT SPEC. 108-19084)

OBSOLETE PARTS: OBSOLETE CIS STREAMLINING PER D.RENAUD/D.SINISI

DISTRIBUZIONE (PRINT DISC)