

4
DRAWING MADE IN THIRD ANGLE PROJECTION
THIS DRAWING IS UNPUBLISHED. RELEASED FOR PUBLICATION
© COPYRIGHT 19 BY AMP INCORPORATED. ALL INTERNATIONAL RIGHTS RESERVED.

LOC	DIST	P	F	ZONE	LTR	REVISIONS	DATE	APPO
AF	50				Z	REACTIVATE -2 AF-8141	9/30/92	JR/RB

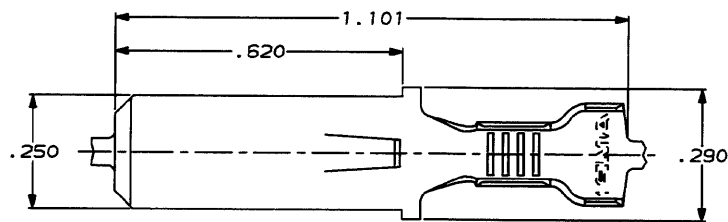

- 1 FOREIGN PRODUCTION ONLY. AMP ARGENTINA
- 2 CONTINUOUS STRIP ON REELS.

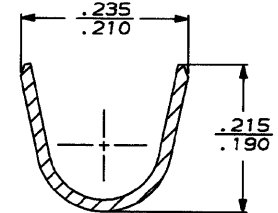
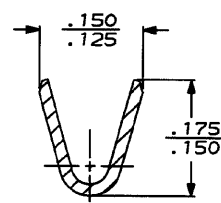
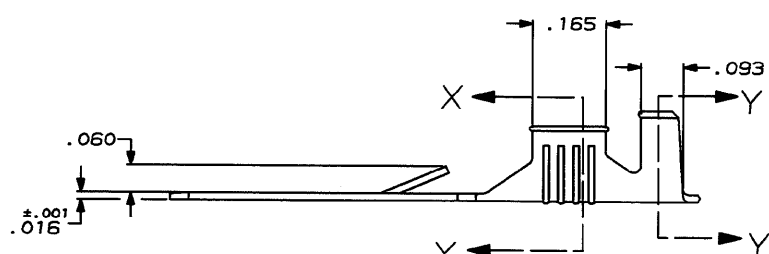

OBSOLETE	PRE-TIN	.120-.145	18-14	42099-4
OBSOLETE	SILVER	.120-.145	18-14	42099-3
OBSOLETE	TIN .000080 MIN	.120-.145	18-14	42099-2
OBSOLETE		.120-.145	18-14	42099-1

FINISH	INSUL RANGE	WIRE SIZE	PART NO
DO NOT SCALE PRINT. UNLESS SPECIFIED DIMENSIONS IN INCHES TOLERANCES ON: 2 PLG DEC # .010 3 PLG DEC # .010 ANGLES # -	DR 12/77/80 IN MM CMC 12/77/80 IN INCHES 18-14	AMP Incorporated Harrisburg, PA 17105-3608	NAME
MATERIAL #2H BRASS	APPO 12/77/80 2 BOND	TAB, FASTIN-FASTON™ .250 SERIES	SIZE
FINISH SEE TABLE	PRODUCT SPEC -	00779	DRAWING NO
	APPLICATION SPEC -	42099	42099
	WEIGHT -	SCALE 5:1	SHEET 1 OF 1

METRIC

CUSTOMER DRAWING