

SCALA NON IMPEGNATIVA
(DO NOT SCALE)
DIMENSIONI IN mm
(DIMENSIONS IN mm)

METRIC

PROIEZIONE EUROPEA
(EUROPEAN PROJECTION)

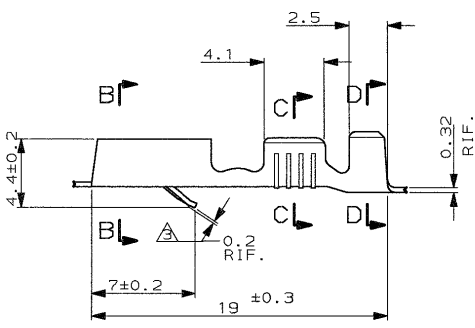

ADATTO PER LINGUETTA DI 0.8 mm.
DI SPESSORE

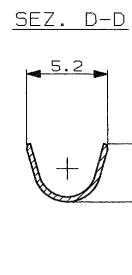
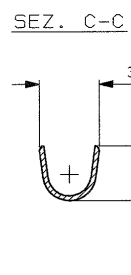
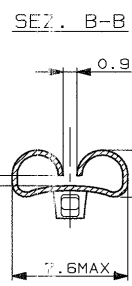

1) SPECIFICA DI PRODOTTO : 108-20020 ; SPECIFICA DI APPLICAZIONE : 114-20021
(PRODUCT SPEC. : 108-20020 ; APPLICATION SPEC. : 114-20021)

2 BOBINATO SU BOBINA DA 12" IN CARTONE CON CARTA INTERPOSTA
(REELED ON 12" CARTON TYPE REEL WITH INTERLAYER PAPER STRIP)

3 NERVATURA DI RINFORZO
(BEAT IN LOCKING LANCE)

4 OBSOLETE PARTS: OBSOLETE CIS STREAMLINING PER D.RENAUD/D.SINISI

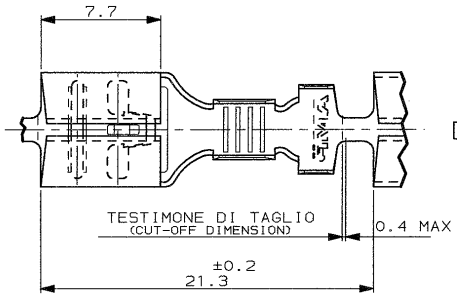

SENDO DI USCITA DEL TERMINALE DALLA BOBINA
(DIRECTION OFF TOP OF REEL)

(WIRE) SEZ.FILO mm²	(INS.DIA.REDUCED) Ø IS.RID.FASE 3
1.0	1.9-2.1
1.5	2.2-2.4
2.5	2.7-3.0

OBSOLETE	PRE-STAGNATO	OTTONE	B	202171-3
	NUDDO	BR.FOSFOROSO	B	202177-1
	STAGNATO	OTTONE	B	282171-1
	FINITURA / COLORE (FINISH / COLOUR)	MATERIALE (MATERIAL)	REV.	NUMERO (PART NUMBER)
CUSTOMER DWG. FOR REFERENCE ONLY		DISEGNO PER CLIENTE SOLO PER RIFERIMENTO		
THIS DRAWING IS UNPUBLISHED		RELEASE FOR PUBLICATION 19		
© COPYRIGHT 19 BY AMP INCORPORATED, HARTSBURG, PA. ALL INTERNATIONAL RIGHT RESERVED. AMP PRODUCTS MAY BE COVERED BY U.S. AND FOREIGN PATENT AND/OR PATENT PENDING				
TOLERANCE, SE NON DIVERSAMENTE SPECIFICATO		DIAM. ISOLANTE (INS. DIA. RANGE)	RANGO FILO (WIRE RANGE)	SCALA (SCALE)
		1.9-3.0 mm	1.0-2.5mm²	4:1
± 0.3		AMP AMP ITALIA S.p.A. Corso F.lli Cervi, 15 COLLENO (TORINO)		
± 2°		DESCRIZIONE (DESCRIPTION) FASTIN-FASTON Connector 250 sq. REC. CONTACT (FOR REDUCED INS. CABLE)		
B3 REVISED PER ECO-09-026346 KK		LOC. SIZE NUMERO (DWG NO) MASTER DWG.) REV. FOGLIO (SHEET) DIA. (CF) 1		
B2 REVISED FOR ET00-0291-00		IA3 C-282171 B3 1		
B ADDED DASH 3, ET00-0050-00				
A IN PRODUZIONE				
ERA 90-51282				
REV. REVISIONI (REVISION RECORD)		DIS. DATA (APP.)		

DISTRIBUZIONE GENERALI FASTON