

DO NOT SCALE
DIMENSIONS IN INCH

METRIC

THIRD ANGLE
PROJECTION

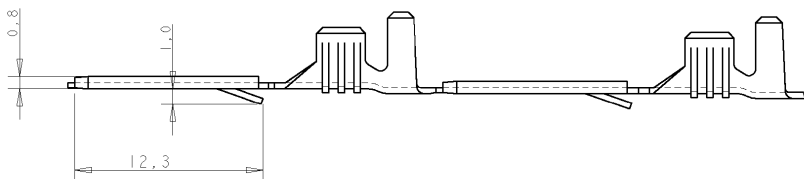
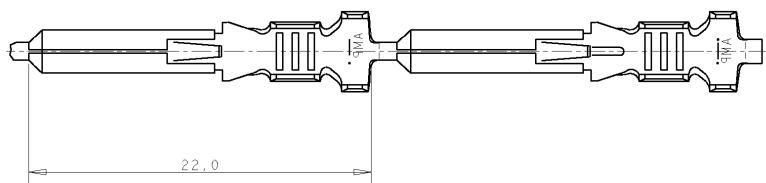
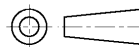

1 OBSOLETE PARTS: OBSOLETE CIS STREAMLINING PER D.RENAUD/D.SINISI

GENERAL TOLERANCE ± 0.3

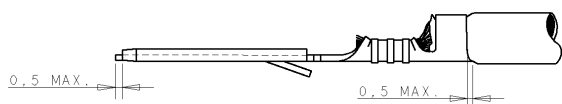
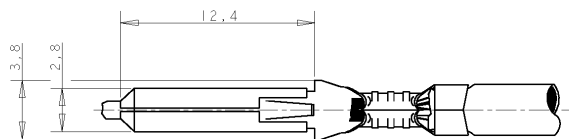

1 OBSOLETE
1 OBSOLETE

FINISH	MATERIAL	PARTNUMBER
PRE-TINPLATED	BRASS	160174
TIN	PHOSPH. BRONZE	160174-4
-	PHOSPH. BRONZE	160174-5
NICKEL	BRASS	160174-1
SILVER	BRASS	160174-3
TIN	BRASS	160174-2
-	BRASS	160174-1

D2	REV PER ECO-10-000444	KK	AEG	08JAN10	NAME
D1	ES00-0009-03	JvL	JL	17JAN03	.110 SRS. FASTIN FASTON TAB
LTR. REVISION RECORD DR. CHR. DATE					<p>CUSTOMER DRAWING FOR REFERENCE ONLY WILL NOT BE UPDATED.</p> <p>© COPYRIGHT 19- BY AMP HOLLAND B.V. ALL INTERNATIONAL RIGHTS RESERVED. AMP PRODUCTS MAY BE COVERED BY U.S. AND FOREIGN AND/OR PATENTS PENDING.</p> <p>THIS DRAWING IS UNPUBLISHED</p> <p>AMP Tyco Electronics AMP Barcelona, Spain</p>
DR. J.v.LIEMPT	CHR. A.BIJNEN	APP. -	DATE: -	DWG. No. C-160174	
DATE: 03 JAN 97	DATE: -	DATE: -	DATE: -	RESTR. TO D2	REV. LTR. 1 of 1

WIRE RANGE :
0.3-0.56 mm²
INSULATION RANGE :
1.4-2.2 DIA.

8 7 6 5 4 3 2 1