

SCALA NON IMPEGNATIVA  
(DO NOT SCALE)  
DIMENSIONI IN mm  
(DIMENSIONS IN IN)

**METRIC**

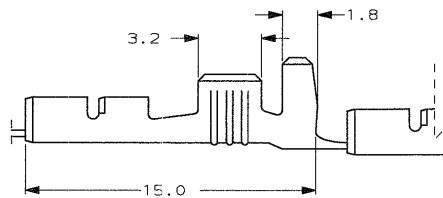

**SEZIONE B-B**  
(SECTION B-B)

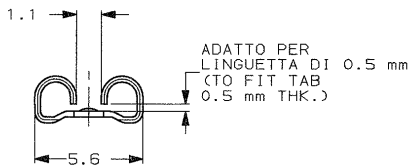
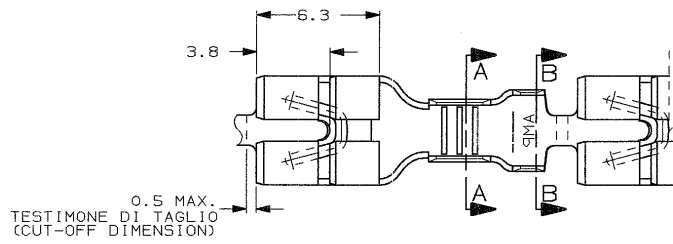
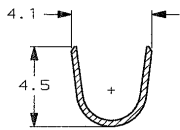

**SEZIONE A-A**  
(SECTION A-A)

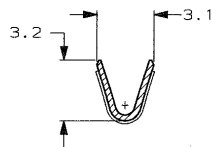

1) STATO DI FORNITURA SCALA 1:1  
(SUPPLY CONDITION SCALE 1:1)

SENDO DI USCITA  
DEL TERMINALE  
DALLA BOBINA  
(DIRECTION OFF  
TOP OF REEL)

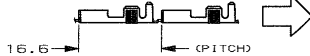

2) SPECIFICA DI PRODOTTO 108-19077  
(PRODUCT SPEC. 108-19077)

3) SPECIFICA DI AGGRAFFATURA 114-20081  
(APPLICATION SPEC. 114-20081)

STAGNATO (TIN PLATED)	OTTONE (BRASS)	0-100651-2	A
FINITURA / COLORE (FINISH / COLOUR)	MATERIALE (MATERIAL)	NUMERO (AMP P/N)	REV

CUSTOMER DWG. FOR REFERENCE ONLY      DISEGNO PER CLIENTE SOLO PER RIFERIMENTO

THIS DRAWING IS UNPUBLISHED	RELEASE FOR PUBLICATION	19
© COPYRIGHT 19 BY AMP INCORPORATED, HARRISBURG, PA. ALL INTERNATIONAL RIGHT RESERVED. AMP PRODUCTS MAY BE COVERED BY U.S. AND FOREIGN PATENT AND/OR PATENT PENDING.		
TOLLERANZE, SE NON DIVERSE SPECIFICATE (TOLERANCES, UNLESS OTHERWISE SPECIFIED)	DIA. ISOLANTE (INS. DIA. RANGE) mm	RANGO FILE (WIRE RANGE) mm2
± 0.4	2.3-3.3 DIA.	0.5-1.5
ANGOLI (ANGLES)	± 2°	SCALA (SCALE)
		5:1



AMP ITALIA S.p.A.  
Corso F.lli. Cervi, 19  
COLLENO (TORINO)

DIS. H. YAALI GR. 04 AUG 2000	REVISED ET00-0127-01 H.Y. 2001	IS PLATE
CONT. C. TARTARI CHCO 04 AUG 2000	OBSOLETE PARTS & REDRAWN ET00-0054-00 H.Y. 2000	APP.
REV. DIS. DATA (REVISION RECORD) (REV. DATE)		

DESCRIZIONE (DESCRIPTION)	FASTON® Connector, .187" sr. L.I.F. REC. CONTACT.
LOC. SIZE NUMERO (DWG NO)	I A3 C-100651
REV.	B1
Foglio (Sheet)	1 of 1

DISTRIBUTOR: CARLINE DISTRIBUTION