

THIS DRAWING IS UNPUBLISHED.
 QUESTO DISEGNO NON DEVE ESSERE DIVULGATO O RIPRODOTTO.
 RELEASED FOR PUBLICATION
 E' CONSENTITA LA DIVULGAZIONE
 ALL INTERNATIONAL RIGHTS RESERVED.
 TUTTI I DIRITTI SONO RISERVATI.
 COPYRIGHT - BY TYCO ELECTRONICS CORPORATION.

REVISONS REVISIONI		DATE	OWN DIS.	APVD APP.
P	LTR REV	DESCRIPTION DESCRIZIONE		
	AZ	REVISED PER ET00-0154-03	15DEC2003	H.Y
	AZ1	REVISED PER ET00-0015-05	14JAN2005	H.Y
	AZ2	5-160433-4 OBSOLETE, ECR-09-019051	26AUG2009	PKS RRP

0.5 MAX.
 TESTIMONE DI TAGLIO
 (CUT-OFF DIM.)

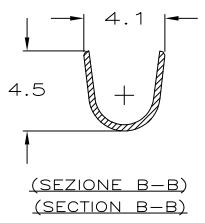
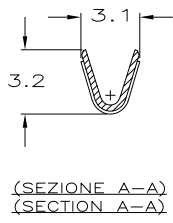
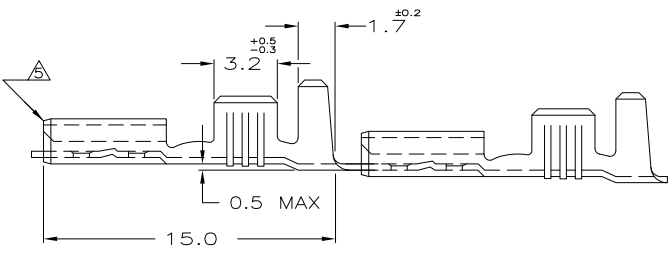
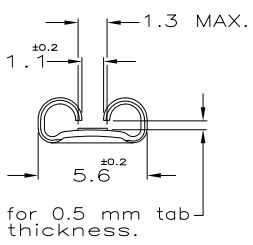
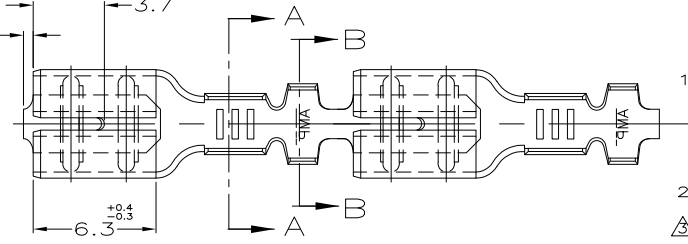

- 1) STATO DI FORNITURA - SCALA 1:1
 (SUPPLY CONDITION - SCALE 1:1)
 SENSO DI USCITA DEL TERMINALE DALLA BOBINA (DIRECTION OFF TOP OF REEL)
 - 2) SPECIFICA DI PRODOTTO 108-20019
 (PRODUCT SPEC. 108-20019)
 - 3) BOBINATO CON INTRODUZIONE DI CARTA INTERPOSTA
 (REELED WITH INTERLEAVE PAPER STRIP)
 - 4) PER LE VERSIONI IN PEZZI SCIOLTI
 VEDERE DISEGNO 160493
 (FOR LOOSE PIECE VERSION SEE DRAWING 160493).
- SMUSSO FRONTALE (CHAMFER AROUND FRONT OF RECEPTACLE)
 FABBRICATO IN TE BRASIL, QUANTITA' PER BOBINA 15M.
 (MANUFACTURED IN TE BRASIL, Q.TY/REEL 15M).

△△	STAGNATO (TIN PLATED)	OTTONE (BRASS)	7-160433-8	AY
△	NUDO (UNPLATED)	OTTONE (BRASS)	7-160433-1	AY
	STAGNATO (TIN PLATED)	BRONZO FOSF. (PH. BRONZE)	6-160433-5	Z
△	STAGNATO (TIN PLATED)	OTTONE (BRASS)	5-160433-6	AY
OBSELETE	PRE NICHELATO (PRE NICKEL PL.)	ACCIAIO (STEEL)	5-160433-4	Z
	NUDO (UNPLATED)	OTTONE (BRASS)	5-160433-1	Z
NOTE	FINITURA/COLORE (FINISH/COLOR)	MATERIALE (MATERIAL)	NUMERO (TE P/N)	REV

THIS DRAWING IS A CONTROLLED DOCUMENT.
 QUESTO DISEGNO E' UN DOCUMENTO CONTROLLATO.

DIMENSIONS: DIMENSIONI: mm	TOLERANCES UNLESS OTHERWISE SPECIFIED: TOLLERANZE SE NON DIVERSAMENTE SPECIFICATO	DWN/DIS. 01 FEB 2000 H.YAALI	01 FEB 2000	Tyco Electronics ITALIA S.p.A. Corso F.LLI Corvi, 15 COLLEGNO (TORINO)
		CHK/CONT. C.TARTARI		
		APVD/APP.		NAME NONE
		PRODUCT SPEC SPEC DI PRODOTTO		FASTON Connector, .187 sr. REC. CONTACT.
		APPLICATION SPEC SPEC DI APPLICAZIONE		SIZE CAGE CODE DRAWING NO. A3 00779 C=160433
		WEIGHT PESO		RESTRICTED TO
		CUSTOMER DRAWING DISEGNO PER CLIENTE SOLO PER RIFERIMENTO	SCALE 5:1	SHEET 1 OF 1 REV AZ2

DIAM. ISOLANTE INSUL. RANGE	RANGO FILO WIRE RANGE
2.3-3.3mm \varnothing	0.5 - 1.5mm \varnothing