

THIS DRAWING IS UNPUBLISHED.
 QUESTO DISEGNO NON DEVE ESSERE DIVULGATO O RIPRODOTTO.
 RELEASED FOR PUBLICATION
 E' CONSENTITA LA DIVULGAZIONE
 ALL INTERNATIONAL RIGHTS RESERVED.
 TUTTI I DIRITTI SONO RISERVATI
 COPYRIGHT - BY TYCO ELECTRONICS CORPORATION.

LOC	DIST	REVISIONS REVISIONI			
P	LTR REV	DESCRIPTION DESCRIZIONE	DATE DATA	OWN DIS.	APVD APP.
	AZ3	REVISED PER ET00-0165-03	2003	H.Y	-
	AZ4	REVISED PER ET00-0009-05	12JAN2005	H.Y	-
	AZ5	5-160430-4 SUPERSEDED, ECR-09-019051	26AUG2009	PKS	RRP
	AZ6	REVISED PER ECO-10-000443	13JAN10	KK	HMR

0.5 MAX.
 TESTIMONE DI TAGLIO
 (CUT-OFF DIM.)

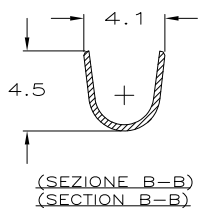
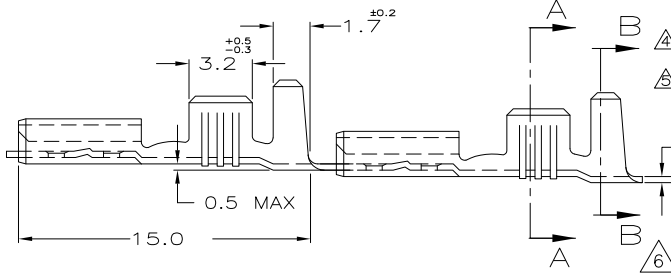
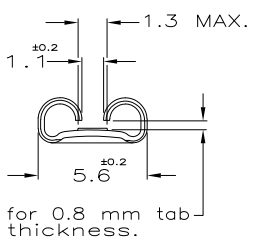
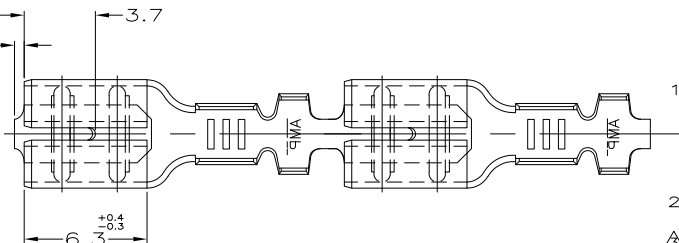

- 1) STATO DI FORNITURA - SCALA 1:1
 (SUPPLY CONDITION - SCALE 1:1)
- SENDO DI USCITA DEL TERMINALE DALLA BOBINA (DIRECTION OFF TOP OF REEL)
- 2) SPECIFICA DI PRODOTTO 108-20019
 (PRODUCT SPEC. 108-20019)
- △ PER LE VERSIONI IN PEZZI SCIOLTI VEDERE DISEGNO 160490 (FOR LOOSE PIECE VERSION SEE DRAWING 160490).
 - △ BOBINATO CON CARTA INTERPOSTA (REELED WITH INTERLEAVE PAPER STRIP)
 - △ FABBRICATO IN TE BRASIL, QUANTITA' PER BOBINA 15M. (MANUFACTURED IN TE BRASIL, Q.TY/REEL 15M).

6 △ OBSOLETE PARTS: OBSOLETE CIS STREAMLINING PER D.RENAUD/D.SINISI

6 △	6 △	STAGNATO (TIN PLATED)	OTTONE (BRASS)	7-160430-7	AZ
6 △	5/4	NUDO (UNPLATED)	OTTONE (BRASS)	7-160430-6	AZ
	△	NUDO (UNPLATED)	OTTONE (BRASS)	6-160430-6	AZ
	△	STAGNATO (TIN PLATED)	OTTONE (BRASS)	5-160430-7	AZ
		STAGNATO (TIN PLATED)	BRONZO FOSF. (PH. BRONZE)	5-160430-6	AY
	△	PRE NICHELATO (PRE NICKEL PL.)	ACCIAIO (STEEL)	5-160430-4	AZ
		FINITURA/COLORE (FINISH/COLOR)	MATERIALE (MATERIAL)	NUMERO (TE P/N)	REV

SUPERSEDED BY 63850-1

DIAM. ISOLANTE INSUL. RANGE	RANGO FILO WIRE RANGE
2.3-3.3mm ϕ	0.5 - 1.5mm ϕ

THIS DRAWING IS A CONTROLLED DOCUMENT.
 QUESTO DISEGNO E' UN DOCUMENTO CONTROLLATO.

DIMENSIONS: DIMENSIONI: mm

TOLERANCES UNLESS OTHERWISE SPECIFIED: TOLLERANZE SE NON DIVERSAMENTE SPECIFICATO

0 PLC/DEC \pm -
 1 PLC/DEC \pm 0.3
 2 PLC/DEC \pm -
 3 PLC/DEC \pm -
 4 PLC/DEC \pm -
 ANGLES/ANGOLI \pm 2'

FINISH FINITURA -

DWN/DIS. 01 FEB 2000 H.YAALI
 CHK/CONT. 01 FEB 2000 C.TARTARI

APVD/APP. -

PRODUCT SPEC SPEC DI PRODOTTO -

APPLICATION SPEC SPEC DI APPLICAZIONE -

WEIGHT PESO -

SIZE A3 CAGE CODE 00779 DRAWING NO. 160430

CUSTOMER DRAWING DISEGNO PER CLIENTE SOLO PER RIFERIMENTO

SCALE 5:1 SHEET 1 OF 1

REV AZ6

Tyco Electronics
 Tyco Electronics ITALIA S.p.A.
 Corso F.LLI Corvi, 15 COLLEGGNO (TORINO)

FASTON Connector,
 .187 sr. CONTACT.