

DO NOT SCALE  
DIMENSIONS IN mm

METRIC

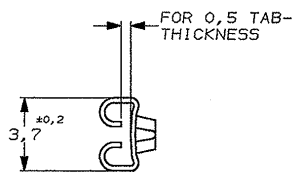

SECTION A-A

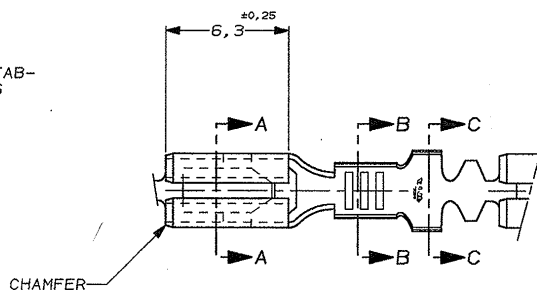

CHAMFER

NOTES:

- ⚠ FOR USE ON MINIATURE APPLICATORS (LEFT-RIGHT FEED).
- ⚠ FOR USE ON MINIATURE APPLICATORS (LEFT-RIGHT FEED; AMP-0-MATOR APPLICATION).
- ⚠ REELED WITH PAPERCOVER.
- ⚠ OBSOLETE PARTS: OBSOLETE CIS STREAMLINING PER D.RENAUD/D.SINISI

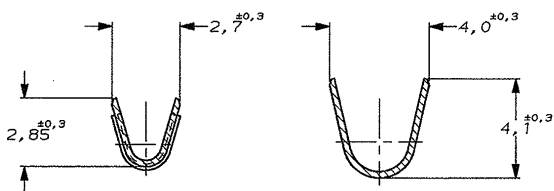
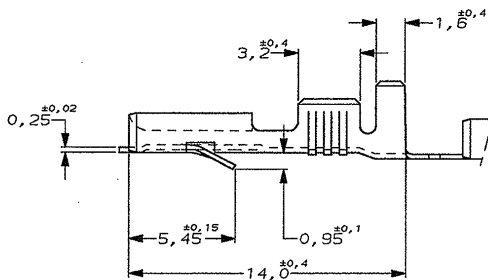
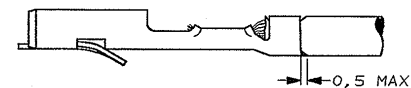
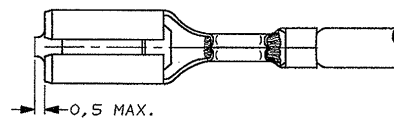

SECTION B-B

SECTION C-C

WIRE RANGE :  
0,5-1,0 mm<sup>2</sup>  
INSULATION RANGE :  
2,0-3,0 DIA.

OBsolete	FINISH	MATERIAL	PARTNUMBER	REV
⚠	SILVERPLATED	PHOSPHORBRONZE	160684-9	W
⚠	SILVERPLATED	BRASS	160684-8	W
⚠	PRE-TIN	BRASS	160684-7	W
⚠	PRE-TIN	BRASS	160684-4	W
⚠	UNPLATED	BRASS	160684-3	W
⚠	PRE-TIN	PHOSPHORBRONZE	160684-2	W
⚠	UNPLATED	PHOSPHORBRONZE	160684-1	W

REVISION RECORD				CUSTOMER DRAWING		FOR REFERENCE ONLY WILL NOT BE UPDATED	
W1	REVISED PER	ECO-10-000444	KK	AEG	08JAN10		
W	ECR-05-003026		HY	GT	06.0705		
L	EH-1513-98		D.K.	A.B.	24 SEP 98		
K	EH-0791-97		D.K.	R.V.	21 JUL 97		
LTR.	REVISION RECORD		DR.	CHK.	DATE		
DR.	D. KESSLER	CHK.	R. VOS	APP.			
DATE:	21 JUL 97	DATE:	-	DATE:	-		

**tyco** Electronics AMP Italia  
C.so F.lli Cervi, 15 COLLENO

.110 SER. FASTIN-ON RECEPTACLE

DWG.No. C-160684 REV.LTR. W1 SHEET 1 OF 1 A3