

THIS COPY IS PROVIDED ON A RESTRICTED BASIS AND IS NOT TO BE USED IN ANY WAY DETRIMENTAL TO THE INTERESTS OF PANDUIT CORP.

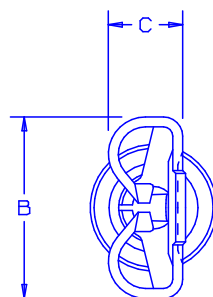
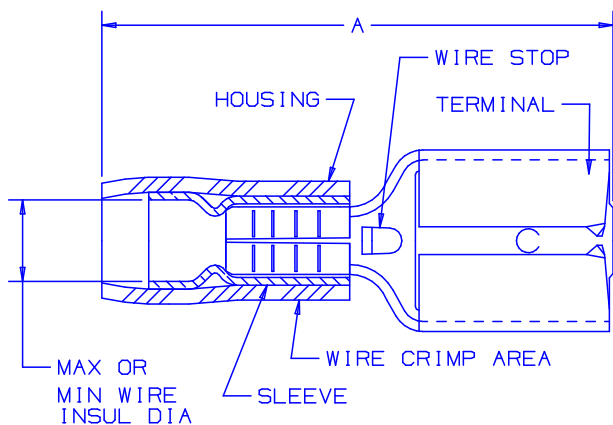

NOTES:

1. UL LISTED AND CSA CERTIFIED FOR:
 - A. 300V MAX VOLTAGE RATING
 - B. 194°F (90°C) MAX TEMP RATING
 - C. STRANDED COPPER WIRE ONLY
 - D. 6-12 LBS INITIAL INSERTION/WITHDRAWAL FORCE
2. MATERIAL:
 - A. STAMPING-BRASS, TIN PLATED
 - B. HOUSING-NYLON
 - C. SLEEVE-BRASS, TIN PLATED
3. DIMENSIONS IN BRACKETS ARE IN mm OR mm²
4. INSTALLATION TOOLS: UL/CSA: CT-500
PANDUIT APPROVED: CT-100, CT-160, CT-260, CT-400, CT-460, CT-1551, CT-1550
5. WIRE STRIP LENGTH: 9/32 ±1/32 (7.1 ±.8)
6. PKG QTY:
 - C = 100
 - M = 1000

PART NUMBER	TAB SIZE	WIRE RANGE AWG	COLOR	MAX. INSUL.	MIN. INSUL.	DIMENSIONS in.		
						A ±.03	B ±.01	C ±.004
DNF18-250	.250 X .032	22-18	RED	.138 (3.51)	.040 (1.02)	.81 (20.57)	.29 (7.37)	.12 (3.05)
DNF14-250	.250 X .032	16-14	BLUE	.162 (4.11)	.050 (1.27)	.83 (21.08)	.29 (7.37)	.12 (3.05)



07	7/03	KLFU		ADDED INTERNAL SERRATIONS					
06	1/01	KMD	SKB	CAD FILE SPEC. WAS N41200AA_PCD_05	8938	JAC	CCH		
05	3/99	JKD		ADDED CT-1551 & CT-1550 TOOLS	07632				
04	12/96	JB	RLS	ADDED TO TABLE "MIN INSUL"	05427	LA	DBH		
03	4/95	MS	RLS	REMOVED SLOT FROM TERMINAL	03132	LA	KRS		
REV	DATE	BY	CHK	DESCRIPTION	ECN #	CUST	PM		

A41200_07

PANDUIT CORP. TINLEY PARK, ILLINOIS

FEMALE DISCONNECTS, NYLON INSULATED, FUNNEL .250 X .032

DRAWN BY	CHK'D	SCALE	DRAWING NO.
FES	LA	NONE	A41200