

MATERIAL NUMBER	ENGINEERING NUMBER	FITS MALE TAB SIZE	"A" MAX.	"C" MAX.	"E" MAX.	CARRIER CONFIGURATION
190030126	AA-2202V	.187X.020	.78/19.8	.316/8.03	.160/4.06	LOOSE PIECE
190030127	AA-2202VT	.187X.020	.78/19.8	.316/8.03	.160/4.06	TAPE MOUNT
190030128	AA-2202VC	.187X.020	.78/19.8	.316/8.03	.160/4.06	PLASTIC STRIP
190030129	AA-2203V	.187X.032	.78/19.8	.316/8.03	.160/4.06	LOOSE PIECE
190030130	AA-2203VT	.187X.032	.78/19.8	.316/8.03	.160/4.06	TAPE MOUNT
190030131	AA-2203VC	.187X.032	.78/19.8	.316/8.03	.160/4.06	PLASTIC STRIP
190030005	AA-2201VN	.250X.032	.86/21.8	.380/9.65	.180/4.57	LOOSE PIECE
190030007	AA-2201VNT	.250X.032	.86/21.8	.380/9.65	.180/4.57	TAPE MOUNT
190030111	AA-2201VNC	.250X.032	.86/21.8	.380/9.65	.180/4.57	PLASTIC STRIP

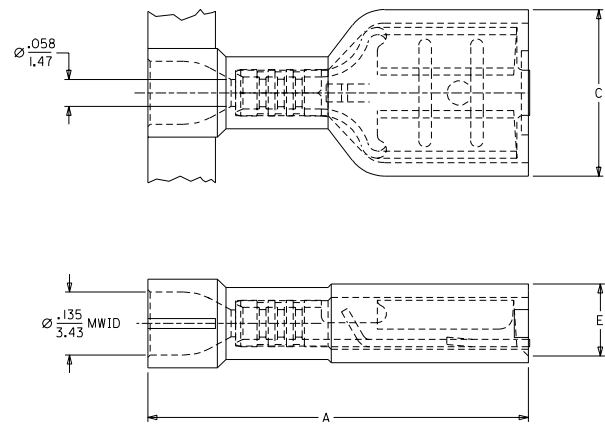

- NOTES:
- ① MATERIAL: TERMINAL: BRASS .016/0.41.
PLATING: ELECTRO-TIN
INSULATION: NYLON 6/6 94V-0 RATING
COLOR: RED
 - 2. MWID = MAXIMUM WIRE INSULATION DIAMETER.
 - 3. ALL DIMENSIONS = INCHES/MM

SALES DRAWING

REV'D NYLON COLOR EC NO. E12004-0101 DRAWN BY: 03/11/21 CHK: HEB APPR: RWD 03/11/21	QUALITY SYMBOLS MAJOR CRITICAL C=0	GENERAL TOLERANCES: (UNLESS SPECIFIED)		SCALE NO: NE	DESIGN UNITS <input type="checkbox"/> mm <input checked="" type="checkbox"/> INCH	THIRD ANGLE PROJECTION	DIMENSIONS: <input type="checkbox"/> mm <input checked="" type="checkbox"/> INCH <input type="checkbox"/> mm ONLY	SHT REV
		4 PLACES ±0.--- ±.---	DRAWN BY & DATE HEB 01/06/07	TITLE: FID FEMALE, INSULKRIMP 94V-0 MATERIAL 22-18 AWG		MOLEX INCORPORATED		REVISE ON CAD ONLY
		3 PLACES ±0.--- ±.005	CHECKED BY & DATE RWD 01/06/07	APPROVED BY & DATE RWD 01/06/07		CAD FILENAME S1900300.LDGN	MATERIAL NO. SEE TABLE	DRAWING NO. SD-19003-001
		2 PLACES ±0.13 ±.01	ANGULAR: ± 1/2 °		THIS DRAWING CONTAINS INFORMATION THAT IS PROPRIETARY TO MOLEX INCORPORATED AND SHOULD NOT BE USED WITHOUT WRITTEN PERMISSION.		SHEET NO. 1 OF 1	SIZE B
1 PLACE ±0.25 ±.---	DRAFT WHERE APPLICABLE MUST REMAIN WITHIN DIMENSIONS							