

4

3

2

1

THIS DRAWING IS UNPUBLISHED. RELEASED FOR PUBLICATION _____, 19____
 © COPYRIGHT 19____ BY AMP INCORPORATED. ALL RIGHTS RESERVED.

LOC		DIST		REVISIONS			
P	LTR	DESCRIPTION		DATE	DWN	APVD	
G	14	H		REDRAWN PER 0720-0244-93	24APR96	LO ME	

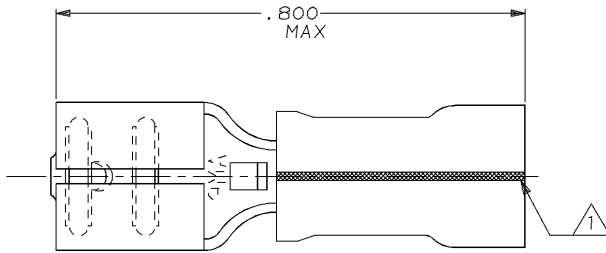

- 1. 3 BLACK STRIPES (120° APART) ON SLEEVE WILL BE POSITIONED AT ANY LOCATION WHEN ASSEMBLED TO BODY
- 2. INSULATION RANGE .135 MAX
- 3. TAB THK .020±.001

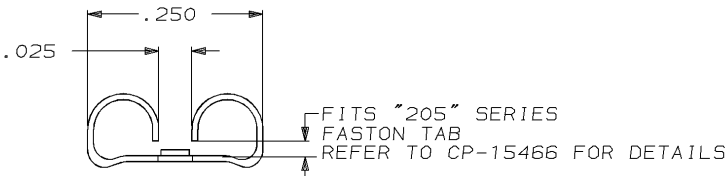
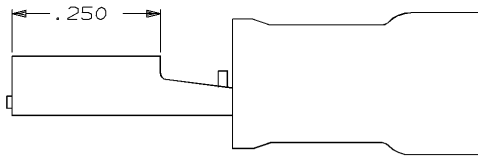

-	LOOSE PIECE	640174-1
QTY	PACKAGE TYPE	PART NO

AMP INCORPORATED CUSTOMER SERVICE SYSTEM		MAX RECOMMENDED OPERATING TEMPERATURE: -	THIS DRAWING IS A CONTROLLED DOCUMENT FOR AMP INCORPORATED. IT IS SUBJECT TO CHANGE AND THE CONTROLLING ENGINEERING ORGANIZATION SHOULD BE CONTACTED FOR THE LATEST REVISION.		DWN L OLMEDA 26 JUN 95	26 JUN 95	AMP AMP Incorporated Harrisburg, PA 17105-3608 NAME RECEPTACLE, 205 SERIES, FASTON™, PIDG™, WIRE SIZE, 22-18 AWG	
FOR ADDITIONAL PRODUCT INFORMATION OR COPIES OF DRAWINGS AND TECHNICAL DOCUMENTS	PRODUCT INFORMATION CENTER 1-800-522-8752	VOLTAGE RATING: -	DIMENSIONS: mm [in]	TOLERANCES UNLESS OTHERWISE SPECIFIED: 0 PLC ±- 1 PLC ±- 2 PLC ±0.38 (.015) 3 PLC ±- 4 PLC ±- ANGLES ±-	CHK M ELLIS 26 JUN 95	26 JUN 95		APVD B BARE
FOR APPLICATION TOOLING INFORMATION	TOOLING ASSISTANCE CENTER 1-800-722-1111	CIRCULAR MIL AREA: -		MATERIAL BODY, BRASS .016 SLV, NYLON, COLOR, RED	FINISH BODY, TIN	WEIGHT -		APPLIC. SPEC -
FOR ORDER ENTRY	1-800-526-5142					SIZE A3		CAGE CODE 00779
AMP 1470-19 REV 09MAY94							DRAWING NO C-640174	
01 FEB 1996 09:52:03 AMP12360 <UJ128A>DEPT1132-U, DMG1132-U, RBY-U, FASTON-U, CUST							CUSTOMER DRAWING	
							SCALE NTS SHEET 1 OF 1 REV H	