

4

3

2

1

THIS DRAWING IS UNPUBLISHED. RELEASED FOR PUBLICATION .19  
 © COPYRIGHT 19 BY AMP INCORPORATED. ALL RIGHTS RESERVED.

LOC	DIST	REVISIONS			
P	LTR	DESCRIPTION	DATE	DWN	APVD
G	14	REV PER 063A-0176-02	08APR02	JR	TM

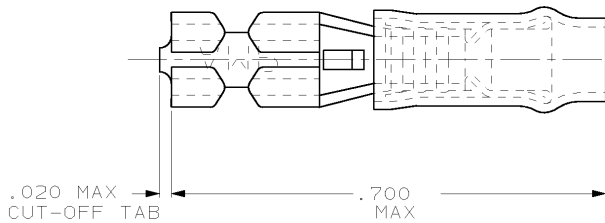

- 1. INSULATION DIA .082 MAX
- 2. FITS TAB .020±.001

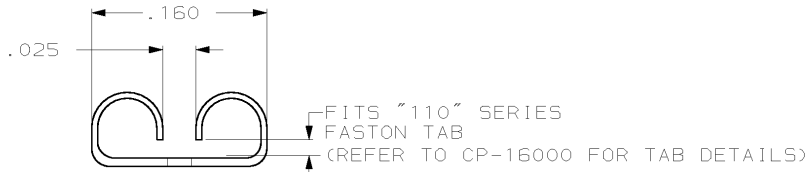
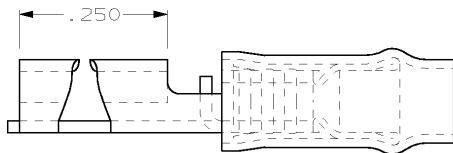

-	-	-
-	TAPE MOUNTED	641324-2
-	LOOSE PIECE	641324-1
QTY	PACKAGE TYPE	PART NO

AMP INCORPORATED CUSTOMER SERVICE SYSTEM		MAX RECOMMENDED OPERATING TEMPERATURE: -	THIS DRAWING IS A CONTROLLED DOCUMENT FOR AMP INCORPORATED. IT IS SUBJECT TO CHANGE AND THE CONTROLLING ENGINEERING ORGANIZATION SHOULD BE CONTACTED FOR THE LATEST REVISION.		DWN L OLMEDA 13NOV95	AMP Incorporated Harrisburg, PA 17105-3608 NAME: RECEPTACLE, 110 SERIES, FASTON, PID6, WIRE SIZE, 26-24 AWG
FOR ADDITIONAL PRODUCT INFORMATION OR COPIES OF DRAWINGS AND TECHNICAL DOCUMENTS 1-800-522-6752	PRODUCT INFORMATION CENTER	VOLTAGE RATING: -	DIMENSIONS: INCHES	TOLERANCES UNLESS OTHERWISE SPECIFIED: 0 PLC ±- 1 PLC ±- 2 PLC ±.015 3 PLC ±- 4 PLC ±- ANGLES ±-	CHK M ELLIS 15NOV95	
FOR APPLICATION TOOLING INFORMATION 1-800-722-1111	TOOLING ASSISTANCE CENTER	CIRCULAR MIL AREA: -	MATERIAL BODY, BRASS .016 SLV, NYLON, COLOR, YELLOW	FINISH BODY, PRE-T1N	APPROV B BARE 15NOV95	SIZE A3
FOR ORDER ENTRY 1-800-526-5142					PRODUCT SPEC APPLICATION SPEC	CAGE CODE 00779
AMP 1470-19 REV 09MAY94				CUSTOMER DRAWING		DRAWING NO 641324
01 FEB 1996 09:03:41 AMP12368 <UUI28A>DEPT1132-U.DWG1132-U.RBY-U.FASTON-U.CUST						SCALE NTS
						SHEET 1 OF 1
						REV G