

4

3

2

1

THIS DRAWING IS UNPUBLISHED. RELEASED FOR PUBLICATION .19
 © COPYRIGHT 19 BY AMP INCORPORATED. ALL RIGHTS RESERVED.

LOC	DIST	REVISIONS			
P	LTR	DESCRIPTION	DATE	DWN	APVD
G	14	F	REV PER 063A-0176-02	08APR02	JR TM

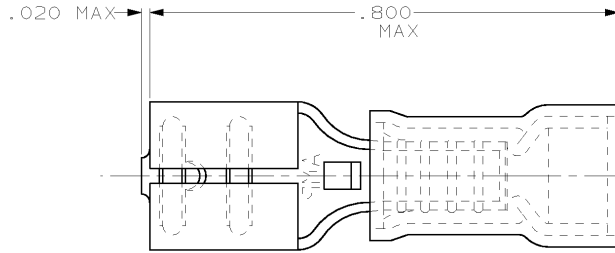

- 1. INSULATION DIA .135 MAX
- 2. FITS TAB .032 THK

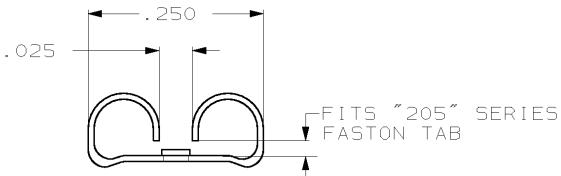
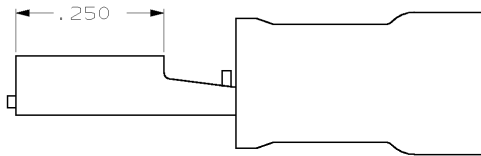

100	LOOSE PC, BOX	8-640911-1
-	TAPE MOUNTED	640911-2
-	LOOSE PIECE	640911-1
QTY	PACKAGE TYPE	PART NO

AMP INCORPORATED CUSTOMER SERVICE SYSTEM		MAX RECOMMENDED OPERATING TEMPERATURE: -	THIS DRAWING IS A CONTROLLED DOCUMENT FOR AMP INCORPORATED. IT IS SUBJECT TO CHANGE AND THE CONTROLLING ENGINEERING ORGANIZATION SHOULD BE CONTACTED FOR THE LATEST REVISION.		DWN L OLMEDA 26 JUN 95	26 JUN 95	AMP Incorporated Harrisburg, PA 17105-3608 NAME: RECEPTACLE, 205 SERIES, FASTON, PID6, WIRE SIZE, 22-18 AWG SIZE: A3 CAGE CODE: 00779 DRAWING NO: 640911	
FOR ADDITIONAL PRODUCT INFORMATION OR COPIES OF DRAWINGS AND TECHNICAL DOCUMENTS	PRODUCT INFORMATION CENTER 1-800-522-6752	VOLTAGE RATING: -	DIMENSIONS: INCHES	TOLERANCES UNLESS OTHERWISE SPECIFIED: 0 PLC ±- 1 PLC ±- 2 PLC ±.015 3 PLC ±- 4 PLC ±- ANGLES ±-	CHK M ELLIS 26 JUN 95	26 JUN 95		PRODUCT SPEC -
FOR APPLICATION TOOLING INFORMATION	TOOLING ASSISTANCE CENTER 1-800-722-1111	CIRCULAR MIL AREA: -		MATERIAL BODY, BRASS .016 SLV, NYLON, COLOR, RED	FINISH BODY, TIN -	APPLICATION SPEC -		WEIGHT -
FOR ORDER ENTRY	1-800-526-5142							CUSTOMER DRAWING
AMP 1470-19 REV 09MAY94						SCALE: NTS SHEET 1 OF 1 REV F		