

4

3

2

1

THIS DRAWING IS UNPUBLISHED. RELEASED FOR PUBLICATION
 © COPYRIGHT - BY TYCO ELECTRONICS CORPORATION. ALL RIGHTS RESERVED.

| LOC | DIST | REVISIONS | | | |
|-----|------|-----------------------|---------|-----|------|
| P | LTR | DESCRIPTION | DATE | DWN | APVD |
| G | 14 | REV PER ECR 07-006476 | 20MAR07 | JR | TM |

AMP
 WIRE SIZE
 22-18 AWG
 STRANDED

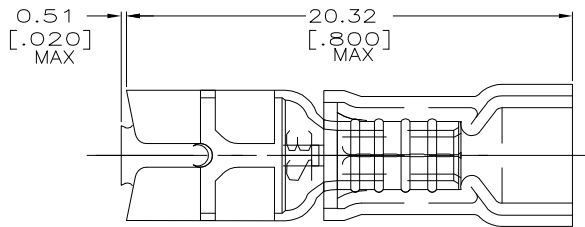

- 1. INSULATION DIA 3.43 [.135] MAX
- 2. FITS TAB 0.81 [.032] THK
- 3. EASIER INSERTION
- 4. PRELIMINARY - NOT FOR PRODUCTION

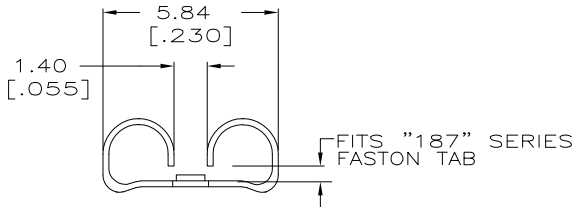
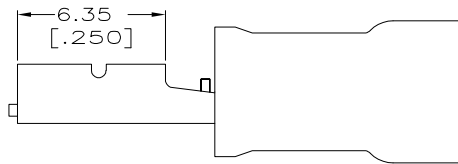

| QTY | SLEEVE MATL./COLOR | PACKAGE TYPE | PART NO |
|------|--------------------|---------------|------------|
| 4000 | PVC, BLACK | ON TAPE, REEL | 2-184268-2 |
| 1000 | PVC, BLACK | LOOSE PIECE | 2-184268-1 |
| 4000 | NYLON, RED | ON TAPE, REEL | 1-184268-2 |
| 1000 | NYLON, RED | LOOSE PIECE | 1-184268-1 |
| 4000 | NYLON, RED | TAPE MOUNTED | 184268-2 |
| 1000 | NYLON, RED | LOOSE PIECE | 184268-1 |

THIS DRAWING IS A CONTROLLED DOCUMENT.

| | | | | | | | |
|-------------|--|------------|---------|-----------------------------------|---|------------------|-------|
| DIMENSIONS: | TOLERANCES UNLESS OTHERWISE SPECIFIED: | DWN | 29MAY96 | tyco Electronics | Tyco Electronics Corporation Harrisburg, PA 17105-3608 | | |
| mm | | CHK | 29MAY96 | | | | |
| | 0 PLC ± - | APVD | 29MAY96 | NAME | RECEPTACLE, 187 SERIES, LOW INSERTION FORCE, FASTON, PIDG, WIRE SIZE: 22-18 AWG | | |
| | 1 PLC ± - | SIZE | A3 | CAGE CODE | | 00779 | |
| | 2 PLC ± 0.38 [015] | DRAWING NO | C= | 184268 | | RESTRICTED TO | - |
| | 3 PLC ± - | WEIGHT | - | - | | CUSTOMER DRAWING | SCALE |
| 4 PLC ± - | FINISH | MATERIAL | | SHEET | | 1 OF 1 | |
| ANGLES ± - | BODY, BRASS .016 | BODY, TIN | | REV | | E3 | |