

4

3

2

1

THIS DRAWING IS UNPUBLISHED. RELEASED FOR PUBLICATION. ALL RIGHTS RESERVED.

LOC	DIST	REVISIONS		
P	LR	DESCRIPTION	DATE	BY
N1		REVISED PER ECO-11-004587	11MAR11	RK HMR

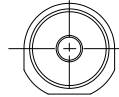
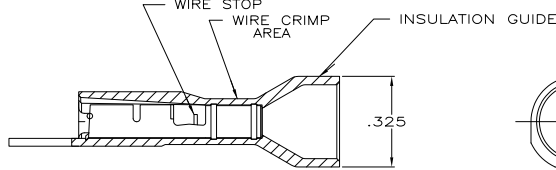
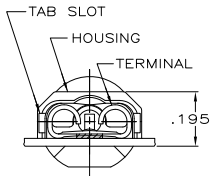
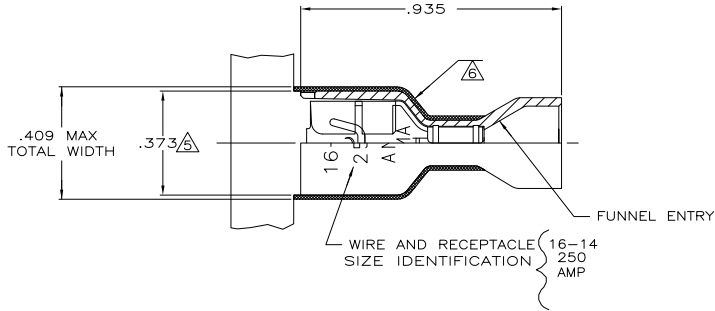

- 1 MATES WITH .032±.001x.250 TAB
- 2 WIRE STRIP LENGTH .281
- 3 INSULATION SIZE .260 MAX DIA
- 4 CONTINUOUS STRIP ON REELS
- △ DIMENSION DOES NOT INCLUDE TRIM BURR
- △ .015 MAX CARRIER TRIM BURR PER SIDE IS ALLOWABLE IN THE SHADED AREA
- △ PRELIMINARY - NOT FOR PRODUCTION

STANDARD	HOUSING:NYLON,COLOR-BLACK RECEPTACLE:#3 HARD BRASS,TIN .000080 MIN	△ 9-520140-2
BULK	HOUSING:NYLON,COLOR-BLUE TRANSLUCENT RECEPTACLE:#3 HARD BRASS,TIN .000080 MIN	5-520140-2
STANDARD	HOUSING:NYLON,COLOR-BLUE TRANSLUCENT RECEPTACLE:#3 HARD PH. BRONZE,TIN .000080 MIN	3-520140-4
STANDARD	HOUSING:NYLON,COLOR-BLUE TRANSLUCENT RECEPTACLE:#3 HARD BRASS,TIN .000080 MIN	3-520140-2
PACKAGING	MATERIAL & FINISH	PART NO.

THIS DRAWING IS A CONTROLLED DOCUMENT.		DATE		TE Connectivity	
DIMENSIONS:		J.R. RUTH	21NOV00	 RECEPTACLE ASSY, ULTRA-FAST, .250 SERIES, 16-14 AWG	
TOLERANCES UNLESS OTHERWISE SPECIFIED:		CR	21NOV00		
INCHES		M.S. FEHNER	21NOV00		
0 PLC ± .005 1 PLC ± .002 2 PLC ± .015 3 PLC ± .010 4 PLC ± .005 ANGLES ± .005		J. KLUMMEL	21NOV00		
MATERIAL		NAME	PRODUCT SPEC	SIZE	QAGE CODE (DRAWING NO)
SEE TABLE		108-2043	114-2123	A2	00779C=520140
FINISH		APPLICATION SPEC	RIGHT	RESTRICTED TO	
SEE TABLE		114-2123	-	CUSTOMER DRAWING	
		CUSTOMER DRAWING	SCALE	SHEET	REV
			4:1	1 of 1	N1

1471-9 (3/11)

520140

A